













**ALAMO INDUSTRIAL**

PO BOX 549  
SEGUIN TX 78156-9967

Please fold (do not tear), tape, and drop in any mailbox.

**PLEASE FILL OUT OWNER WARRANTY REGISTRATION INFORMATION  
SIGN, AND DROP LAST COPY IN ANY MAILBOX.**

**IMPORTANT!**  
**TO PLACE THIS WARRANTY IN EFFECT,  
THIS WARRANTY REGISTRATION MUST BE  
FILLED OUT, SIGNED, AND MAILED WITHIN 30  
DAYS OF DELIVERY DATE OF THIS MACHINE.  
DEALER AND PURCHASER MUST SIGN.**

**ATTENTION: ANY CLAIM SUBMITTED TO ALAMO INDUSTRIAL®  
WILL BE REFUSED UNTIL COMPLETED, SIGNED  
WARRANTY REGISTRATION CARD IS ON FILE.**



# AF60 AF72 Rotary Mower

Rev 03-13

P/N 00759687

Effective S/N AF60-01013 to Current  
AF72-01004 to Current

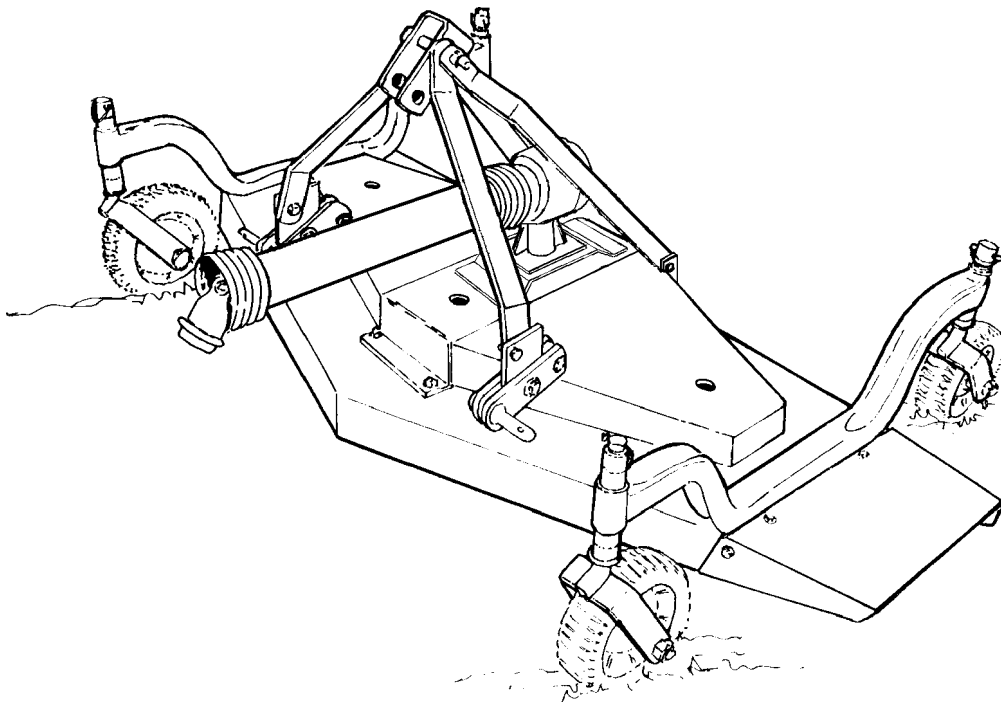

## OPERATOR'S MANUAL with PARTS LISTING

**ALAMO INDUSTRIAL**

1502 E. Walnut  
Seguin, Texas 78155  
830-372-9595



**BUILT SHARPER®**

An Alamo Group Company

© 2013 Alamo Group Inc.

# TO THE OWNER/OPERATOR/DEALER

All implements with moving parts are potentially hazardous. There is no substitute for a cautious, safe-minded operator who recognizes the potential hazards and follows reasonable safety practices. The manufacturer has designed this implement to be used with all its safety equipment properly attached to minimize the chance of accidents.

## BEFORE YOU START!!

Read the safety messages on the implement and shown in your manual. Observe the rules of safety and common sense!



# DANGER

**FAILING TO FOLLOW SAFETY MESSAGES AND OPERATING INSTRUCTIONS CAN CAUSE SERIOUS BODILY INJURY OR EVEN DEATH TO OPERATOR AND OTHERS IN THE AREA.**

1.



2. NO RIDERS. NO CHILDREN OPERATORS.



3. USE SAFETY SHOES, HARD HAT, SAFETY GLASSES, SEAT BELTS, & ROPS.



4. BLOCK UP SECURELY BEFORE WORKING UNDER.



1. Study and understand Operator's Manuals, Safety Signs, and Instructional Decals for tractor and implement to prevent misuse, abuse, and accidents. Practice before operating in a confined area or near passersby.

- Learn how to stop engine suddenly in an emergency. Be alert for passersby and especially children.

2. Allow no children on or near implement or tractor. Allow no riders on tractor or implement. Falling off may cause serious injury or death from being run over by tractor or cutter or contact with rotating blades.

3. Operate only with tractor having Roll-Over Protective Structure (ROPS) and with seatbelt fastened securely and snugly to prevent injury and possible death from falling off or tractor overturn. Personal Protective Equipment such as Hard Hat, Safety Glasses, Safety shoes, and Ear Plugs are recommended.

4. Block up or support raised machine and all lifted components securely before putting hands or feet under or working underneath any lifted components to prevent crushing injury or death from sudden dropping or inadvertent operation of controls. Make certain area is clear before lowering or folding.

5. Before transporting, put Lift Lever in detent or full-lift position. Install \*Cylinder Stops as Transport Blocks securely on pull-type and folding implements. Slow down when turning and on hillsides.

- Attach \*\*Safety Chain to cutter and towing unit securely. See Operator's Manual.

6. Make certain that SMV sign, Warning Lights, and Reflectors are clearly visible. Follow local traffic codes.

7. Never operate with Cutting Head raised if passersby, bystanders, or traffic are in the area to reduce possibility of injury or death from objects thrown by Blades under Guards or cutter structure.

8. Before dismounting, secure implement in transport position or lower to ground.

- Put tractor in park or set brake, disengage PTO, stop engine, and remove key, and wait until noise of rotation has ceased to prevent entanglement in rotating parts which can cause injury or death.

- Never mount or dismount a moving vehicle. Crushing from runover may cause injury or death.

5. TRANSPORT SAFELY, LOCK UP.

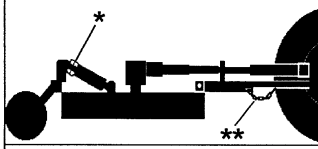

6. USE SMV, LIGHTS, & REFLECTORS.

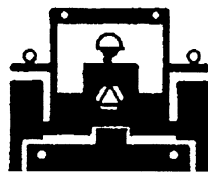

7. DO NOT OPERATE WITH CUTTER OR WING RAISED.

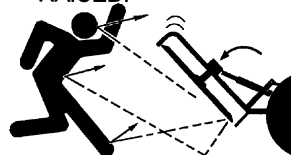

8. DO NOT MOUNT OR DISMOUNT WHILE MOVING.



00749117

## WARRANTY INFORMATION:

Read and understand the complete Warranty Statement found in this Manual. Fill out the Warranty Registration Form in full and return it within 30 Days. Make certain the Serial Number of the Machine is recorded on the Warranty Card and on the Warranty Form that you retain. The use of "will-fit" parts will void your warranty and can cause catastrophic failure with possible injury or death.



# TABLE OF CONTENTS

<b>SAFETY SECTION .....</b>	<b>1-1</b>
Safety Information .....	1-2
Decal Location .....	1-5
Safety Decals .....	1-6
<b>INTRODUCTION SECTION .....</b>	<b>2-1</b>
<b>ASSEMBLY SECTION .....</b>	<b>3-1</b>
A-Frame Attachment .....	3-2
Caster Wheel Attachments .....	3-3
Discharge Chute Installation .....	3-4
Driveline Attachment .....	3-4
<b>OPERATION SECTION .....</b>	<b>4-1</b>
Tractor Preparation .....	4-2
Attaching Mower to Tractor .....	4-2
Driveline Attachment to Tractor .....	4-3
Cutting Height Adjustment .....	4-3
Starting & Stopping Cutter .....	4-3
Cutting Speed .....	4-4
Cutting Tips .....	4-4
Detaching and Storing .....	4-4
Driveline Length Check Procedure .....	4-5
Front Gauge Wheel Interference Check .....	4-6
Troubleshooting .....	4-7
<b>MAINTENANCE SECTION .....</b>	<b>5-1</b>
Lubrication Information .....	5-2
Gearbox .....	5-3
Gauge Wheel Assemblies .....	5-3
Driveline Lubrication .....	5-4
Blade Spindle Lubrication .....	5-5
Blade Servicing .....	5-5
Blade Sharpening .....	5-5
Blade Removal and Installation .....	5-6
Belt Adjustment Procedure .....	5-6
Belt Removal/Installation .....	5-7
Storage .....	5-8
Torque Settings .....	5-8
Blade Spindle Service Instructions .....	5-9
Driveline Shield Service Instructions .....	5-10
<b>PARTS SECTION .....</b>	<b>6-1</b>



# **SAFETY SECTION**

# SAFETY

A safe and careful operator is the best operator. Safety is of primary importance to the manufacturer and should be to the owner/operator. Most accidents can be avoided by being aware of your equipment, your surroundings, and observing certain precautions. The first section of this manual includes a list of Safety Messages that, if followed, will help protect the operator and bystanders from injury or death. Read and understand these Safety Messages before assembling, operating or servicing this implement. This equipment should only be operated by those persons who have read the Manual, who are responsible and trained, and who know how to do so safely and responsibly.

The Safety Alert Symbol combined with a Signal Word, as seen below, is used throughout this manual and on decals which are attached to the equipment. The Safety Alert Symbol means: **“ATTENTION! BECOME ALERT! YOUR SAFETY IS INVOLVED!”** The Symbol and Signal Word are intended to warn the owner/operator of impending hazards and the degree of possible injury faced when operating this equipment..

**Practice all usual and customary safe working precautions and above all---remember safety is up to YOU. Only YOU can prevent serious injury or death from unsafe practices.**

## CAUTION!



The lowest level of Safety Message; warns of possible injury. Decals located on the Equipment with this Signal Word are Black and Yellow.

## WARNING!



Serious injury or possible death! Decals are Black and Orange.

## DANGER!



Imminent death/critical injury. Decals are Red and White. (SG-1)

**READ, UNDERSTAND, and FOLLOW the following Safety Messages. Serious injury or death may occur unless care is taken to follow the warnings and instructions stated in the Safety Messages. Always use good common sense to avoid hazards.**

**SAFETY INSTRUCTIONS**



## PELIGRO!



Si no lee Ingles, pida ayuda a alguien que si lo lea para que le traduzca las medidas de seguridad. (SG-3)



(SG-2)

**¡LEA EL INSTRUCTIVO!**

# SAFETY

## DANGER!



Never operate the Tractor or Implement until you have read and completely understand this Manual, the Tractor Operator's Manual, and each of the Safety Messages found in the Manual or on the Tractor and Implement. Learn how to stop the tractor engine suddenly in an emergency. Never allow inexperienced or untrained personnel to operate the Tractor and Implement without supervision. Make sure the operator has fully read and understood the manuals prior to operation. (SG-4)

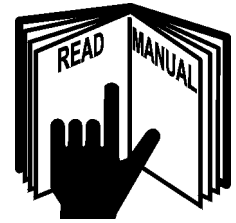

## WARNING!



Always maintain the safety decals in good readable condition. If the decals are missing, damaged, or unreadable, obtain and install replacement decals immediately. (SG-5)

## WARNING!



Make certain that the "Slow Moving Vehicle" (SMV) sign is installed in such a way as to be clearly visible and legible. When transporting the Equipment use the Tractor flashing warning lights and follow all local traffic regulations. (SG-6)

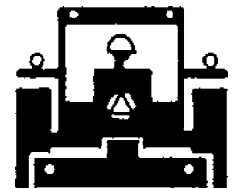

## WARNING!



Operate this Equipment only with a Tractor equipped with an approved roll-over-protective system (ROPS). Always wear seat belts. Serious injury or even death could result from falling off the tractor--particularly during a turnover when the operator could be pinned under the ROPS. (SG-7)



## WARNING!



Do not modify or alter this Implement. Do not permit anyone to modify or alter this Implement, any of its components or any Implement function. (SG-8)

## DANGER!



BEFORE leaving the tractor seat, always engage the brake and/or set the tractor transmission in parking gear, disengage the PTO, stop the engine, remove the key, and wait for all moving parts to stop. Place the tractor shift lever into a low range or parking gear to prevent the tractor from rolling. Never dismount a Tractor that is moving or while the engine is running. Operate the Tractor controls from the tractor seat only. (SG-9)

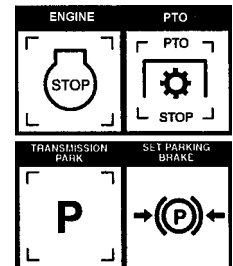

## DANGER!



Never allow children or other persons to ride on the Tractor or Implement. Falling off can result in serious injury or death. (SG-10)



## DANGER!



Never allow children to operate or ride on the Tractor or Implement. (SGM-11)



## WARNING!



Do not mount the Tractor while the tractor is moving. Mount the Tractor only when the Tractor and all moving parts are completely stopped. (SG-12)



# SAFETY

## DANGER!



Start tractor only when properly seated in the Tractor seat. Starting a tractor in gear can result in injury or death. Read the Tractor operators manual for proper starting instructions. (SG-13)



## DANGER!



Never work under the Implement, the framework, or any lifted component unless the Implement is securely supported or blocked up to prevent sudden or inadvertent falling which could cause serious injury or even death. (SG-14)



## DANGER!



Do not operate this Equipment with hydraulic oil leaking. Oil is expensive and its presence could present a hazard. Do not check for leaks with your hand! Use a piece of heavy paper or cardboard. High-pressure oil streams from breaks in the line could penetrate the skin and cause tissue damage including gangrene. If oil does penetrate the skin, have the injury treated immediately by a physician knowledgeable and skilled in this procedure. (SG-15)



## WARNING!



The operator and all support personnel should wear hard hats, safety shoes, safety glasses, and proper hearing protection at all times for protection from injury including injury from items thrown by the equipment. (SG-16)

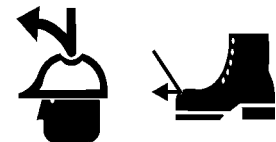

## CAUTION!



**PROLONGED EXPOSURE TO LOUD NOISE MAY CAUSE PERMANENT HEARING LOSS!** Tractors with or without an Implement attached can often be noisy enough to cause permanent hearing loss. We recommend that you always wear hearing protection if the noise in the Operator's position exceeds 80db. Noise over 85db over an extended period of time will cause severe hearing loss. Noise over 90db adjacent to the Operator over an extended period of time will cause permanent or total hearing loss. *Note:* Hearing loss from loud noise [from tractors, chain saws, radios, and other such sources close to the ear] is cumulative over a lifetime without hope of natural recovery. (SG-17)



# SAFETY

## WARNING!



Periodically inspect all moving parts for wear and replace when necessary with authorized service parts. Look for loose fasteners, worn or broken parts, and leaky or loose fittings. Make sure all pins have cotter pins and washers. Serious injury may occur from not maintaining this machine in good working order. (SG-21)

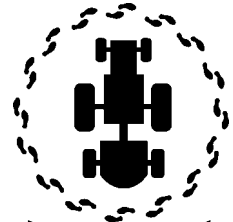

## WARNING!



Never attempt to lubricate, adjust, or remove material from the Implement while it is in motion or while tractor engine is running. Make sure the tractor engine is off before working on the Implement.

(SG-20)



## WARNING!



Transport only at safe speeds. Serious accidents and injuries can result from operating this equipment at unsafe speeds. Understand the Tractor and Implement and how it handles before transporting on streets and highways. Make sure the Tractor steering and brakes are in good condition and operate properly.



Before transporting the Tractor and Implement, determine the safe transport speeds for you and the equipment. Make sure you abide by the following rules:

1. Test the tractor at a slow speed and increase the speed slowly. Apply the Brakes smoothly to determine the stopping characteristics of the Tractor and Implement. As you increase the speed of the Tractor the stopping distance increases. Determine the maximum safe transport speed for you and this Equipment.
2. Test the equipment at a slow speed in turns. Increase the speed through the turn only after you determine that it is safe to operate at a higher speed. Use extreme care and reduce your speed when turning sharply to prevent the tractor and implement from turning over. Determine the maximum safe turning speed for you and this equipment before operating on roads or uneven ground.
3. Only transport the Tractor and Implement at the speeds that you have determined are safe and which allow you to properly control the equipment.

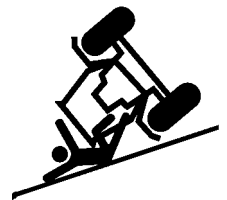

Be aware of the operating conditions. Do not operate the Tractor with weak or faulty brakes. When operating down a hill or on wet or rain slick roads, the braking distance increases: use extreme care and reduce your speed. When operating in traffic always use the Tractor's flashing warning lights and reduce your speed. Be aware of traffic around you and watch out for the other guy. (SG-19)

## WARNING!



Always read carefully and comply fully with the manufacturers instructions when handling oil, solvents, cleansers, and any other chemical agent. (SG-22)



# SAFETY

## DANGER!



Never run the tractor engine in a closed building or without adequate ventilation. The exhaust fumes can be hazardous to your health.

(SG-23)

## DANGER!



KEEP AWAY FROM ROTATING ELEMENTS to prevent entanglement and possible serious injury or death.

(SG-24)



## DANGER!



Never allow children to play on or around Tractor or Implement. Children can slip or fall off the Equipment and be injured or killed. Children can cause the Implement to shift or fall crushing themselves or others.

(SG-25)

## WARNING!



Do not exceed the rated PTO speed for the Implement. Excessive PTO speeds can cause Implement driveline or blade failures resulting in serious injury or death.

(SG-26)

## DANGER!



**NEVER use drugs or alcohol** immediately before or while operating the Tractor and Implement. Drugs and alcohol will affect an operator's alertness and coordination and therefore affect the operator's ability to operate the equipment safely. Before operating the Tractor or Implement, an operator on prescription or over-the-counter medication must consult a medical professional regarding any side effects of the medication that would hinder their ability to operate the Equipment safely. **NEVER** knowingly allow anyone to operate this equipment when their alertness or coordination is impaired. Serious injury or death to the operator or others could result if the operator is under the influence of drugs or alcohol.

(SG-27)



## WARNING!



Mow only in conditions where you have clear visibility in daylight or with adequate artificial lighting. Never mow in darkness or foggy conditions where you cannot clearly see at least 100 yards in front and to the sides of the tractor and mower. Make sure that you can clearly see and identify passersby, steep slopes, ditches, drop-offs, overhead obstructions, power lines, debris and foreign objects. If you are unable to clearly see this type of items discontinue mowing.

(SGM-1)

## DANGER!



There are obvious and hidden potential hazards in the operation of this Mower. **REMEMBER!** This machine is often operated in heavy brush and in heavy weeds. The Blades of this Mower can throw objects if shields are not properly installed and maintained. Serious injury or even death may occur unless care is taken to insure the safety of the operator, bystanders, or passersby in the area. Do not operate this machine with anyone in the immediate area. Stop mowing if anyone is within 100 yards of mower.

(SGM-2)





# SAFETY

## DANGER!



All Safety Shields, Guards and Safety devices including (but not limited to) - the Deflectors, Chain Guards, Steel Guards, Gearbox Shields, PTO integral shields, and Retractable Door Shields should be used and maintained in good working condition. All safety devices should be inspected carefully at least daily for missing or broken components. Missing, broken, or worn items must be replaced at once to reduce the possibility of injury or death from thrown objects, entanglement, or blade contact. (SGM-3)

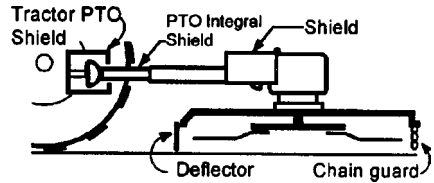

## DANGER!



The rotating parts of this machine have been designed and tested for rugged use. However, the blades could fail upon impact with heavy, solid objects such as metal guard rails and concrete structures. Such impact could cause the broken objects to be thrown outward at very high velocities. To reduce the possibility of property damage, serious injury, or even death, never allow the cutting blades to contact such obstacles. (SGM-4)

## WARNING!



Extreme care should be taken when operating near loose objects such as gravel, rocks, wire, and other debris. Inspect the area before mowing. Foreign objects should be removed from the site to prevent machine damage and/or bodily injury or even death. Any objects that cannot be removed must be clearly marked and carefully avoided by the operator. Stop mowing immediately if blades strike a foreign object. Repair all damage and make certain rotor or blade carrier is balanced before resuming mowing. (SGM-5)



## WARNING!



Many varied objects, such as wire, cable, rope, or chains, can become entangled in the operating parts of the mower head. These items could then swing outside the housing at greater velocities than the blades. Such a situation is extremely hazardous and could result in serious injury or even death. Inspect the cutting area for such objects before mowing. Remove any like object from the site. Never allow the cutting blades to contact such items. (SGM-6)

## WARNING!



Mow at the speed that you can safely operate and control the tractor and mower. Safe mowing speed depends on terrain condition and grass type, density, and height of cut. Normal ground speed range is from 0 to 5 mph. Use slow mowing speeds when operating on or near steep slopes, ditches, drop-offs, overhead obstructions, power lines, or when debris and foreign objects are to be avoided. (SGM-7)

## WARNING!



Avoid mowing in reverse direction when possible. Check to make sure there are no persons behind the mower and use extreme care when mowing in reverse. Mow only at a slow ground speed where you can safely operate and control the tractor and mower. Never mow an area that you have not inspected and removed debris or foreign material. (SGM-8)

## WARNING!



Do not put hands or feet under mower decks. Blade Contact can result in serious injury or even death. Stay away until all motion has stopped and the decks are securely blocked up. (SGM-9)

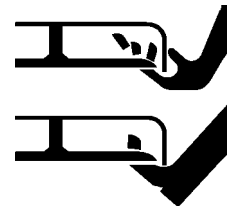

# SAFETY

## DANGER!



Replace bent or broken blade with new blades. NEVER ATTEMPT TO STRAIGHTEN OR WELD ON BLADES SINCE THIS WILL LIKELY CRACK OR OTHERWISE DAMAGE THE BLADE WITH SUBSEQUENT FAILURE AND POSSIBLE SERIOUS INJURY FROM THROWN BLADES. (SGM-10)

## WARNING!



Do not let the Blades turn when the Mower Deck is raised for any reason, including clearance or for turning. Raising the Mower deck exposes the Cutting Blades which creates a potentially serious hazard and could cause serious injury or even death from objects thrown from the Blades. (SRM-7)

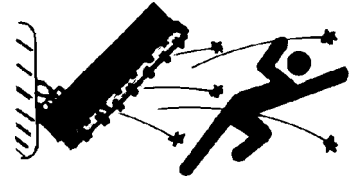

## WARNING!



Do not mow with two machines in the same area except with Cab tractors with the windows closed. (SGM-11)

## DANGER!



Rotary Mowers are capable under adverse conditions of throwing objects for great distances (100 yards or more) and causing serious injury or death. Follow safety messages carefully

### **STOP MOWING IF PASSERSBY ARE WITHIN 100 YARDS UNLESS:**

- Front and Rear Deflectors, or Chain Guards, or Bands are installed and in good, workable condition;
- Mower sections or Wings are running close to and parallel to the ground without exposed Blades;
- Passerby are outside the existing thrown-object zone;
- All areas have been thoroughly inspected and all foreign material such as rocks, cans, glass, and general debris has been removed.

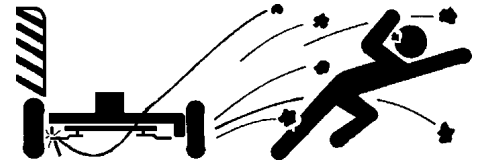

NOTE: Where there are grass and weeds high enough to hide debris that could be struck by the blades, the area should be: inspected and large debris removed, mowed at an intermediate height, inspected closely with any remaining debris being removed, and mowed again at desired final height. (This will also reduce power required to mow, reduce wear and tear on the Mower drivetrain, spread cut material better, eliminate streaking, and make the final cut more uniform.)

(SRM-1)

## WARNING!



Be particularly careful when transporting the Implement with the Tractor. Turn curves or go up hills only at a low speed and using a gradual steering angle. Rear mounted implements move the center of gravity to the rear and remove weight from the front wheels. Make certain, by adding front ballast, that at least 20% of the tractor's weight is on the front wheels to prevent rearing up, loss of steering control or Tractor tip-over. Slow down on rough or uneven surfaces to prevent loss of steering control which could result in property damage or possible injury. Do not transport unless 3-Point lift lever is fully raised and in the latched transport position. Dropping implement in transport can cause serious damage to the tractor and/or Implement and possibly cause the operator or others to be injured or killed. (S3PT-2)

# SAFETY

## WARNING!



Never leave Tractor and Implemented unattended while the implement is in the lifted position. Accidental operation of lifting lever or a hydraulic failure may cause sudden drop of unit with injury or death by crushing. To properly park the implement when disconnecting it from the tractor, lower the stand and put the retaining pin securely in place, or put a secure support under the A-Frame. Lower the implement carefully to the ground. Do not put hands or feet under lifted components. (SPT-1)

## DANGER!



Always disconnect the main PTO Driveline from the Tractor before performing service on the Mower. Never work on the Mower with the tractor PTO driveline connected and running. Blades or Drivelines could turn without warning and cause immediate entanglement, injury or death. (SRM-3)

## DANGER!



Make sure the PTO shield, integral driveline shields, and input shields are installed when using PTO-driven equipment. Always replace any shield if it is damaged or missing. (S3PT-8)



## WARNING!



Relieve hydraulic pressure prior to doing any maintenance or repair work on the Implement. Place the Implement on the ground or securely blocked up, disengage the PTO, and turn off the tractor engine. Push and pull the Remote Cylinder lever in and out several times prior to starting any maintenance or repair work. (S3PT-9)



## WARNING!



The rotating parts of this machine continue to rotate even after the PTO has been turned off. The operator should remain in his seat for 60 seconds after the brake has been set, the PTO disengaged, the tractor turned off, and all evidence of rotation has ceased. (3PT-10)

**“Wait a minute...Save a life!”**

## PARTS INFORMATION

Alamo Industrial mowers use balanced and matched system components for blade carriers, blades, cuttershafts, knives, knife hangers, rollers, drivetrain components, and bearings. These parts are made and tested to Alamo Industrial specifications. Non-genuine "will fit" parts do not consistently meet these specifications. The use of "will fit" parts may reduce mower performance, void mower warranties, and present a safety hazard. Use genuine Alamo Industrial mower parts for economy and safety.

(SPAM-1)

## SEE YOUR ALAMO DEALER

In addition to the design and configuration of this Implement, including Safety Signs and Safety Equipment, hazard control and accident prevention are dependent upon the awareness, concern, prudence, and proper training of personnel involved in the operation, transport, maintenance, and storage of the machine. Refer also to Safety Messages and operation instruction in each of the appropriate sections of the Tractor and Equipment Manuals. Pay close attention to the Safety Signs affixed to the Tractor and Equipment. (SG-18)

# SAFETY DECAL LOCATION

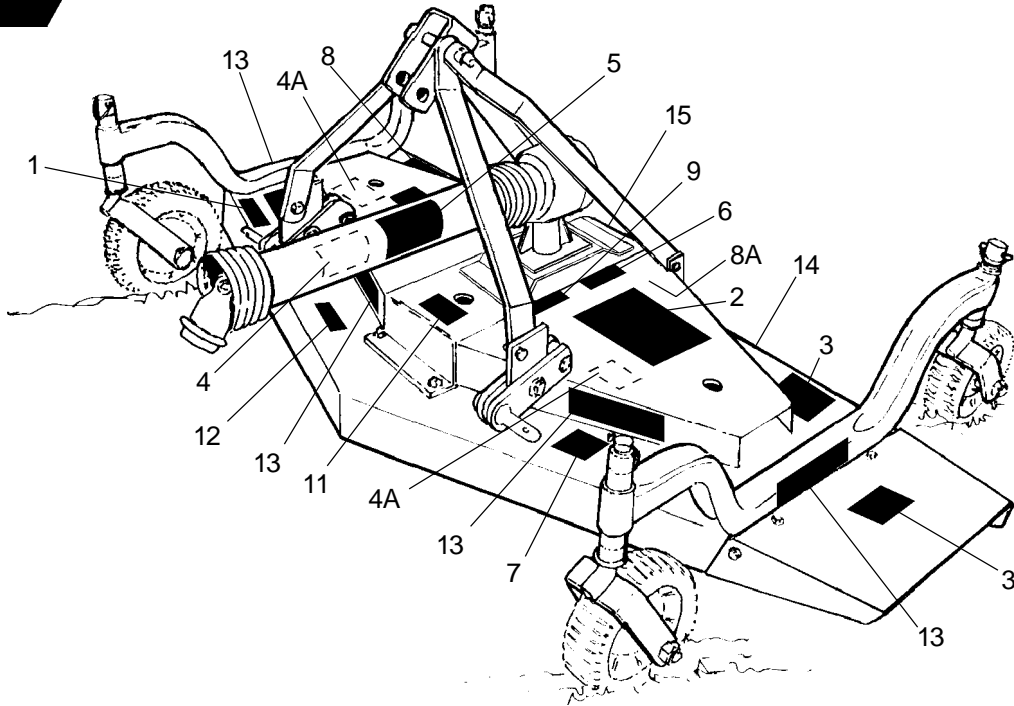
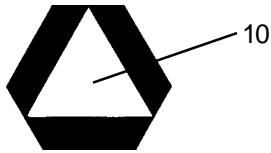

ITEM	PART NO.	QTY	LEVEL	DESCRIPTION
1	00725746	1	PELIGRO	Translate Safety Material
2	00749117	1	DANGER	Multi-Hazard
3	00755742	2	DANGER	Cutting Blades/Thrown Objects
4	00756004	((1))	DANGER	D/L Shield Missing-Do Not Operate
4A	00756004	[1]	DANGER	Shield Missing. Do Not Operate
5	00756005	1	DANGER	Rotating Driveline/Entanglement
6	00756494	1	DANGER	Driveline Hazards
7	00758194	2	WARNING	V-Belt Pinch Point
8	00760657	1	INSTRUCT	Genuine Rhino Parts
8A	00773723	1	PELIGRO	Rotating Driveline Translation
9	D103	1	WARNING	540 RPM
10	03200347	*	REFLECTOR	SMV
11	00755691	1	INSTRUC	Lube, Blade Bolt
12	00763977	1	INSTRUC	Notice to Owner
13	99101	4	LOGO NAME	Rhino Name (2 x 7-3/8)
14	00769897	2	NAME	FM60 Name
	00769899	2	NAME	FM72 Name
15	nfs	1	SERIAL PLATE	FM Serial Plate

\* Furnished by Tractor Manufacturer

(( )) Installed by D/L Manufacturer

[ ] Cut in half and install under belt shields

# SAFETY DECALS

**PELIGRO**

LEA EL INSTRUCTIVO

Si No Lee Ingles, Pida Ayuda a Alguien  
Que Si Lo Lea Para Que le Traduzca las  
Medidas de Seguridad.



00725746

1-00725746

**DANGER**



**KEEP AWAY!**

THROWN OBJECTS OR  
BLADE CONTACT  
CAN CAUSE SERIOUS  
INJURY OR DEATH.

KEEP DISCHARGE CHUTE  
AND SHIELDS IN PLACE.



Post Office Box 712  
Seguin, TX 78156  
512-372-3080

Part No.  
00755742

3-00755742

**DANGER**



GUARD MISSING  
DO NOT OPERATE

**DANGER**



GUARD MISSING  
DO NOT OPERATE

**DANGER**

4-00756004

**DANGER**



**ROTATING DRIVELINE-  
CONTACT CAN CAUSE DEATH  
KEEP AWAY!**

DO NOT OPERATE WITHOUT-

- All driveline guards, tractor and equipment shields in place
- Drivelines securely attached at both ends
- Driveline guards that turn freely on driveline

00756005

5-00756005

**DANGER**

1. MAKE CERTAIN DRIVELINES ARE OF THE CORRECT LENGTH AND SECURELY ATTACHED. DRIVELINE SEPARATION AND/OR PTO STUB SHAFT FAILURE CAN CAUSE INJURY OR DEATH. (See Operator's Manual for procedure.)

\* SEE MANUAL FOR MINIMUM OVERLAP & MINIMUM MAXIMUM LENGTHS



BOTTOMING OUT



2. MAKE CERTAIN THAT DRIVELINE SHIELDS ARE INSTALLED CORRECTLY AND TURN FREELY TO PREVENT INJURY OR DEATH FROM ENTANGLEMENT

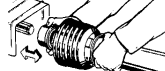

3. MAKE CERTAIN THAT DRIVELINE IS INSTALLED CORRECTLY ON TRACTOR PTO SHAFT. MOVE YOKE BACK AND FORTH UNTIL LOCKING COLLAR CLICKS FORWARD AND LOCKS YOKE IN PLACE

4. 540 PTO RPM UNLESS SPECIFICALLY MARKED OTHERWISE.

00756494

6-00756494

**WARNING**

OPERATE THIS MACHINE AT  
**540 RPM**  
TRACTOR PTO SPEED ONLY

Overspeeding PTO may cause component failure with resulting injury.

D103

9-D103

**WARNING**

DO NOT OPERATE WITH BELT SHIELD REMOVED. FINGER(S) MAY BE PINCHED OFF IF CAUGHT BETWEEN V-BELT AND PULLEY.

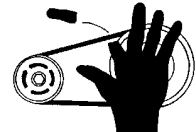

00758194

7-00758194

**IMPORTANT**

For your safety and to guarantee optimum product reliability, always use Genuine ALAMO INDUSTRIAL replacement parts. The use of inferior "will-fit" parts will void Warranty of your ALAMO INDUSTRIAL implement and may cause premature or catastrophic failure which can result in serious injury or death. If you have any questions concerning the repair parts you are using, contact ALAMO INDUSTRIAL, 1502 E. Walnut Seguin, TX 78155 (830) 372-3551.





02926100

8-00760657

**RHINO**

13-99101

# SAFETY DECALS

LUBRICATE Driveline - 3 Places  
  
8  Caster Wheel - 2 Places on each  
Every 8 Hours Blade Shaft Housing - 1 Place on each  

---

Use Clean #2 Lithium - Based Bearing Grease  

---

Notice: Blade Bolts Have Left Hand Threads 00755691

11-00755691

## NOTICE TO OWNER

An OPERATOR'S MANUAL (with Repair Parts Listing) and a WARRANTY REGISTRATION CARD were attached to this implement during final inspection at the factory.

If they were not attached at the time of purchase, please contact your selling dealer at once.

1. Read and understand Manual before operating the implement.
2. Complete, sign, and mail the Warranty Registration Card in today. 00763977

12-00763977

**FM60** 00769897

14-00769897

**FM72** 00769899

14-00769899

## SAFETY DECALS

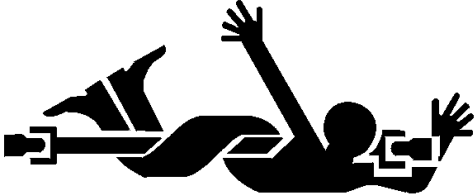
 <b>PELIGRO</b>	
<p>Un manual de la seguridad de la línea de conducción n/p 00773776 está disponible en español. Llame el número enumerado para una copia gratis.</p>	<p><i>LÍNEA DE CONDUCCIÓN GIRATORIA- EL CONTACTO PUEDE CAUSAR LA MUERTE ¡MANTENERSE LEJOS! NO FUNCIONE SIN QUE-</i></p> <ul style="list-style-type: none"><li>• Todos los protectores de la línea de Conducción, alimentador y blindajes del Equipo estén en su lugar</li><li>• Las líneas de conducción estén conectadas con seguridad en ambos extremos</li><li>• Los protectores de la línea de conducción den vuelta libremente en la línea de Conducción</li></ul> <p>00773723</p>

8A-00773723





# **INTRODUCTION SECTION**

# INTRODUCTION

This Rotary Mower is designed with care and built with quality materials by skilled workers. Proper assembly, maintenance, and operating practices, as described in this manual, will help the owner/operator get years of satisfactory service from the machine.

The purpose of this manual is to familiarize, and instruct. The Assembly Section instructs the owner/operator in the correct assembly of the Mower using standard and optional equipment. The Parts Listing section is designed to familiarize the owner/operator with replaceable parts on the Mower. This section provides exploded assembly drawings of each mower component illustrating each piece and the corresponding part number.

Careful use and timely service saves extensive repairs and costly downtime losses. The Operation and Maintenance Sections of the manual train the owner/operator how to work the Mower correctly and attend to appropriate maintenance. The Trouble Shooting Guide helps diagnose difficulties with mower and offers solution to the problems.

Safety is of primary importance to the owner/operator and to the manufacturer. The first section of this manual includes a list of Safety Messages, that, if followed, will help protect the operator and bystanders from injury or death. Many of the Safety Messages will be repeated throughout the manual. The owner/operator/dealer should know these Safety Messages before assembly and be aware of the hazards of operating this mower during assembly, use, and maintenance. The Safety Alert Symbol combined with a Signal Word, as seen below, is intended to warn the owner/operator of impending hazards and the degree of possible injury faced when operating this machine.

**CAUTION** The lowest level of Safety Message; warns of possible minor injury. Decals located on the Mower with this Signal Word are Black and Yellow.



**WARNING** Serious injury or possible death! Decals are Black and Orange.



**DANGER** Imminent death/critical injury. Decals are Red and White.



# INTRODUCTION

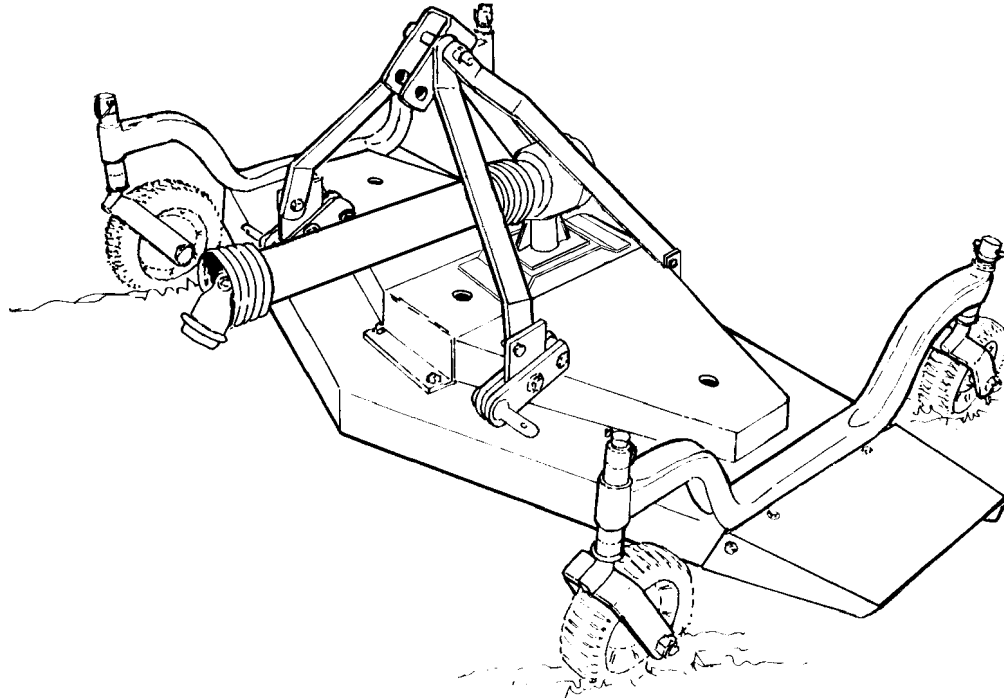

Your RHINO FM mower is designed for light-duty cutting such as lawn maintenance plus small weed and grass control. With a reasonable amount of preventive maintenance, your Mower will provide years of dependable service.

## **DANGER**



**NEVER ALLOW CHILDREN TO OPERATE, RIDE ON, OR COME CLOSE TO MOWER OR TRACTOR.** Usually, 15-16 year-old children who are mature and responsible can operate the mower with reasonable safety if they have read Operator's Manual, been trained in safe operation of the machine, and are physically large and strong enough to reach and operate controls easily.

## **DANGER**



For Non-Agricultural use, OSHA, ASAE, SAE, and ANSI standards require the use of Chain Guards, Deflectors, or Solid Skirts at all times. The Mower manufacturer strongly recommends the use of Chain Guards or Solid Skirts for Agricultural purposes as well, to reduce the risk of property damage, serious bodily injury, or even death from objects thrown out by or from contact with the Cutting Blades.

## **WARNING**



At least 20% of the tractor's weight must be on the front tires with the Mower lifted to provide adequate traction for safe steering under good conditions. Slow down on hills, rough terrain, and curves.

Front and rear and left and right are determined by the normal direction of travel, the same as driving an automobile.

# INTRODUCTION

## ATTENTION OWNER/OPERATOR

BEFORE OPERATING THIS MACHINE:

1. Carefully read the Operator's Manual, completely understand the Safety Messages and instructions, and know how to operate correctly both the tractor and Mower.
2. Fill out the Warranty Card in full. Be sure to answer all questions, including the Serial Number of the Mower. Mail within 30 days of delivery date of this implement.

**NOTE:** *Warranties are honored only if completed "Owner Registration and Warranty" forms are received by Alamo Group within thirty days of delivery of the mower.*

3. Record the Mower Model and Serial Numbers on the Warranty page at the front of the Operator's Manual. Keep this as part of the permanent maintenance file for the Mower.

# IMPORTANT

**For your safety and to guarantee optimum product reliability, always use Genuine ALAMO INDUSTRIAL replacement parts. The use of inferior "will-fit" parts will void Warranty of your ALAMO INDUSTRIAL implement and may cause premature or catastrophic failure which can result in serious injury or death. If you have any questions concerning the repair parts you are using, contact ALAMO INDUSTRIAL, 1502 E. Walnut Seguin, TX 78155 (830) 372-3551.**



# **ASSEMBLY SECTION**

# ASSEMBLY

The AF60 & 72 Mowers will attach to most tractors with Cat. I Three-Point hitch and a 540 RPM PTO. **DO NOT EXCEED HORSEPOWER RECOMMENDATIONS.**

**DANGER!**



Operating with PTO speed over 540 RPM can cause excessive vibration with subsequent machine failure which can cause serious injury or even death. Never exceed 600 RPM.

## DEALER SET-UP INSTRUCTIONS

Assembly of this mower is the responsibility of the Rhino dealer. The mower should be delivered to the owner completely assembled, lubricated, and adjusted for normal cutting conditions.

Set up mower as received from the factory with these instructions. Remove mower from carton. Open parts box and lay parts out to make location easy. Refer to parts lists and exploded view drawings for more detail.

This mower is shipped partially assembled. Assembly will be easier if components are aligned and loosely assembled before tightening hardware.

**CAUTION!**



Always use personal protection devices such as eye and ear protectors during assembly.

## A-FRAME ATTACHMENT

Attach the Rear Brace Bars (1) to the lugs on the rear of the deck with 1/2" x 1-1/4" bolts & 1/2" locknuts (2).

**NOTE:** Install rear braces in rear holes on deck if hitch pins are positioned in standard position. Install in front holes if hitch pins are in extended position. Attach the A-Frame Bars (3) to the lugs on the front of the deck with 5/8" x 1/2" bolts & 5/8" locknuts (4). Attach the other end of the A-Frame Bars (3) at the top and between the Rear Brace Bars (1) and Top Link (5) with 3/4" x 5-1/2" bolt, bushing & 3/4" nut (6). **FIGURE 1.**

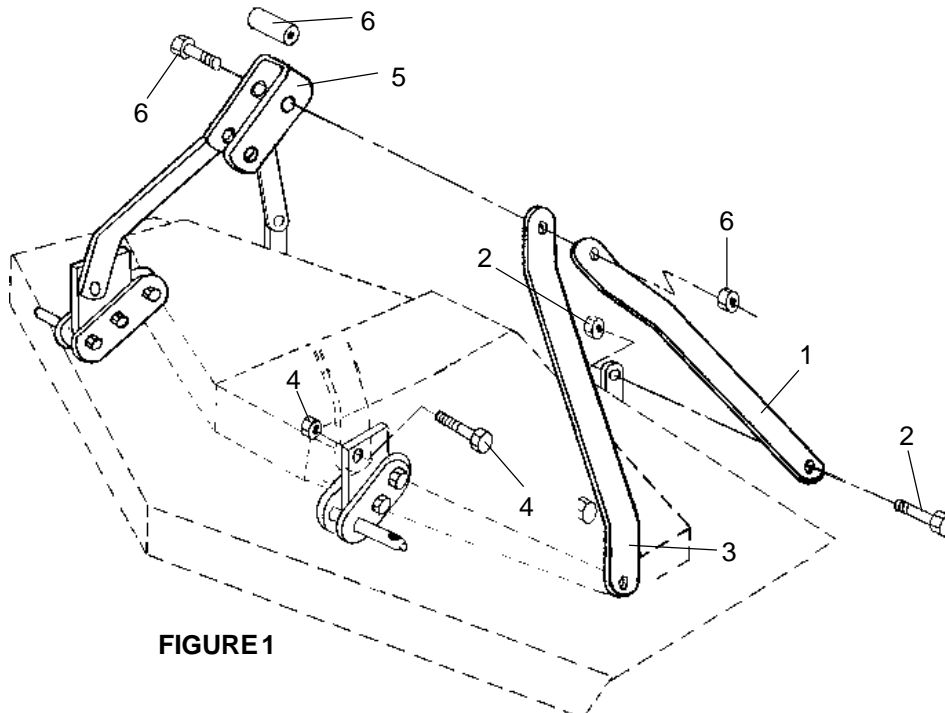
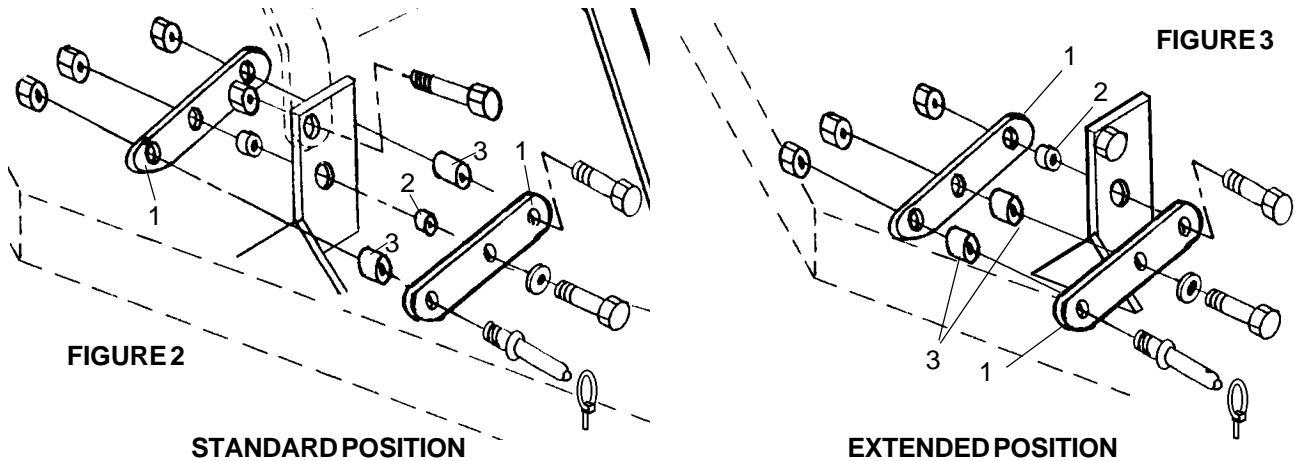

**FIGURE 1**

# ASSEMBLY

## A-FRAME ATTACHMENT (cont'd.)

Install floating hitch pins to main frame using either the standard or extended hitch positions. Exploded view shows standard position **FIGURE 2**. To install in extended position move flats (1) forward and place bushings (2) in rear holes and bushing (3) at center hole. **FIGURE 3**.



## CASTER WHEEL ATTACHMENTS

Attach the right and left Axle Arm Weldment (5) to the deck with 3/8" bolts (3) flatwasher (1-1/2OD x 3/16 thick) (7), and 3/8 locknuts (8). Install two one inch spacers (1) and one 1/2 inch spacer (4) on each fork and wheel assembly shaft (6). Insert fork shaft (9) into axle arm weldment (5). Install two additional one inch spacers (1) on each axle shaft (9) and retain using Snapper Pin. **FIGURE 4**.

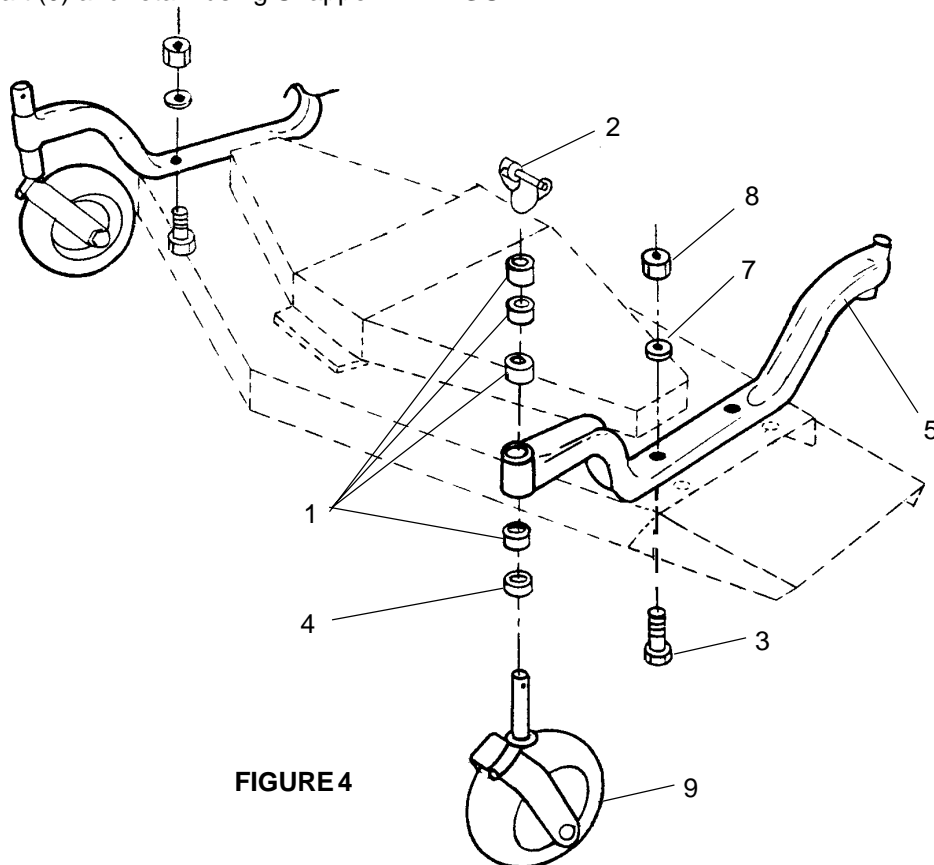

# ASSEMBLY

## DISCHARGE CHUTE INSTALLATION

### DANGER!



Keep away. To avoid serious injury or death from thrown objects or blade contact, never operate mower without discharge chute in place.

Attach discharge chute to mower platform using four 3/8" x 3/4" bolts (1) and 3/4" locknuts (2) as shown. **FIGURE 5.**

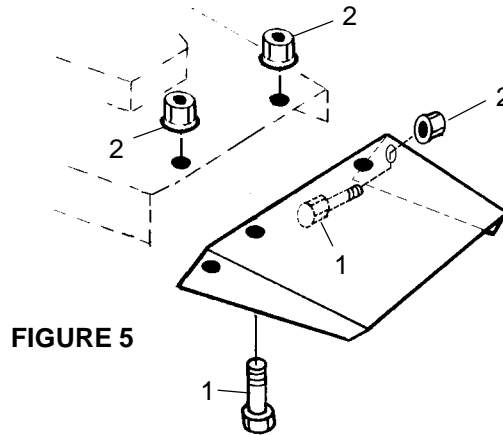

**FIGURE 5**

**Discharge Chute Installation**

## DRIVELINE ATTACHMENT - To Gearbox

1. Insert yoke onto splined shaft. Grab and pull collar on end yoke.
2. Slide yoke (with collar depressed) onto gearbox shaft.
3. Move yoke back and forth until collar clicks forward and locks the yoke in place.



**OPERATION  
SECTION**

# OPERATION

The safe operation of this machine is the responsibility of the operator. The operator should be familiar with the cutter and tractor and all safety practices before starting operation. This mower is designed for lawn or grass mowing. It is not designed for rough conditions or heavy weed mowing. It is equipped with suction type blades for best results in lawn mowing.

Always operate tractor PTO at 540 rpm.

This section provides information for attaching mower to tractor and preparing it for field operation. Review this data prior to tractor hookup and operation.

## **TRACTOR PREPARATION - Do not install on a tractor over 40 horsepower.**

### **Ballast**

An implement code of has been assigned to the fully-equipped Lift-Type AF mower so that you can determine the tractor front ballast requirements. Refer to your tractor Operator's manual for the code number and ballasting requirements.

#### **WARNING!**

Do not operate with less than 20% of tractor's gross unballasted mass on front wheel with mower in transport position.



### **Wheel Treads**

Tractor wheel tread spacing should be increased when working on inclines or rough ground to reduce the possibility of tipping.

### **Stabilizer Bars or Sway Blocks**

Use stabilizer bars or sway blocks to prevent side sway of the mower.

### **Drawbar**

Shorten or remove the tractor Drawbar so it will not interfere with the up and down movement of the Mower.

#### **WARNING!**

Do not get between Tractor and Mower when engine is running!



## **ATTACHING MOWER TO TRACTOR - LIFT TYPE**

This mower is designed for 540 RPM PTO only with CAT I hitch. Back the tractor up to the mower so that the lower Draft Arms are in alignment with the mower lower lift pins. Stop the engine, lock the brakes or place the tractor in park. Connect the tractor and Stabilizer Bars to the lower lift pins. Adjust the Top link so it will pin to the top holes in the A-Frame or into holes in floating top link.

#### **DANGER!**

**NEVER ALLOW CHILDREN TO OPERATE, RIDE ON, OR COME CLOSE TO MOWER OR TRACTOR.** Usually, 15-16 year-old children who are mature and responsible can operate the mower with reasonable safety if they have read Operator's Manual, been trained in safe operation of the machine, and are physically large and strong enough to reach and operate controls easily.



# OPERATION

## DRIVELINE ATTACHMENT TO TRACTOR

1. Grab and pull collar on end of attaching yoke toward cutter.
2. Slide yoke (with collar depressed) onto PTO shaft.
3. Move yoke back and forth until locking collar clicks forward and locks the yoke in place.

### WARNING!



When attaching PTO yoke to tractor PTO shaft, it is important that spring activated locking collar slides freely and is seated in groove on PTO shaft.

### WARNING!



Be sure PTO shielding and all other shielding is installed and is in good condition.

## CUTTING HEIGHT ADJUSTMENT

### WARNING!



Avoid personal injury! Be sure tractor engine is off, key is removed, and **ALLOW BLADES TO STOP TURNING** before dismounting to make adjustments.

**Important:** Avoid very low cutting heights. Striking the ground with blades gives the most damaging shock loads a cutter can encounter and will cause damage to cutter and drive.

1. Using the tractor, raise the mower off the ground and support under it with secure blocking so not to let the mower drift down during maintenance.
2. Holding wheel and yoke assembly up, remove quick-lock pin from top of gauge wheel spindle. Position full length spacers and half spacer as required. All spacers on top of spindle tube allows for approximately 1" cutting height. Adjustments range from 1" to a maximum of 4-1/2" in 1/2" increments.

## STARTING & STOPPING CUTTER

Power for operating cutter is supplied from tractor PTO. Refer to your tractor manual instructions for engaging and disengaging the PTO. Always engage the PTO at low engine rpm. Always operate at recommended PTO speed of 540 RPM. Learn how to stop tractor and cutter quickly in case of an emergency.

**IMPORTANT:** Stop cutter and tractor immediately upon striking an obstruction. Inspect the cutter and repair any damage before resuming operation. **Do not disengage PTO when engine is a full PTO RPM. Always idle engine before disengaging PTO.**

### WARNING!



Avoid personal injury. When attempting to stop a tractor which does not have live PTO, the momentum created by the blade carrier of a rotary cutter can cause the tractor to be pushed forward. **DO NOT** operate this cutter unless tractor has live or independent PTO.

To commence operation, reduce engine speed and engage the tractor PTO. Before starting to cut, gradually increase engine speed to develop full PTO speed.

# OPERATION

Enter the area to cut with the cutter operating at PTO speed and, if it becomes necessary to temporarily regulate engine speed during operations, increase or decrease the throttle gradually.

To transport, disengage the PTO, raise full transport height.

## CUTTING SPEED

Proper ground speed for cutting will depend upon the height, type, and density of material to be cut.

Normally, ground speed will range from 1-1/2 to 3 mph. Tall dense material should be cut at low speed while thin medium height material can be cut at a faster ground speed.

## CUTTING TIPS

Always operate PTO at recommended RPM when cutting. This is necessary to maintain proper blade speed and to produce a clean cut.

Under certain conditions, tractor tires may roll some grasses down and prevent them from being cut at the same height as the surrounding area. When this occurs, reduce the tractor ground speed, but maintain PTO RPM. The lower speed will permit grasses to be at least partially rebound and be cut. Taking a partial cut and/or reversing the direction of travel may also produce a cleaner cut.

As often as possible, stop mowing when other people are passing by. Although the Mower is shielded to prevent objects from being thrown out by the blades, no one shield device is 100% effective. The operator has greater knowledge of the dangers of being around this Mower while it is operational than the person on the street.

### WARNING!



Avoid personal injury. Pick up all rocks and other debris before cutting. Enter new areas carefully. Cut material higher the first time to allow cutter to clear unseen objects. Never assume an area is clear. Always check.

Extremely tall grass should be cut twice. Raise cutter and cut twice the desired height. Cut the second time at desired height at 90 degrees to first pass.

Remember, sharp blades produce cleaner cuts and use less power.

Before cutting, analyze the area to determine the best cutting procedure. Consider the height and type of material and the terrain type: hilly, level or rough.

Grass is best cut when it is dry. Mowing wet grass can cause plugging resulting in grass clumps behind the mower.

Grass should be mowed frequently as shorter clippings deteriorate faster.

## DETACHING AND STORING

Lower the Mower to the Ground. Park the Tractor with the transmission in the correct gear (Automatic Transmission--Park; Standard Transmission--Neutral). Set the parking brake, shut off the engine, and remove the key, Wait until the PTO stops rotating before getting down from the tractor.

Disconnect the driveline from the tractor PTO and store it to prevent it from contacting the ground.

Always reinstall the Master Shield over the tractor PTO Shaft. This shield should always remain in place except when connecting or disconnecting driveline.

The grass is discharged to the left. To keep clippings off streets and sidewalks, mow two to four passes counterclockwise, throwing the clippings into the unmowed grass area. Then, complete the job by mowing clockwise and spreading the clippings uniformly over the already-mowed area. **FIGURE 1.**

FIGURE 1

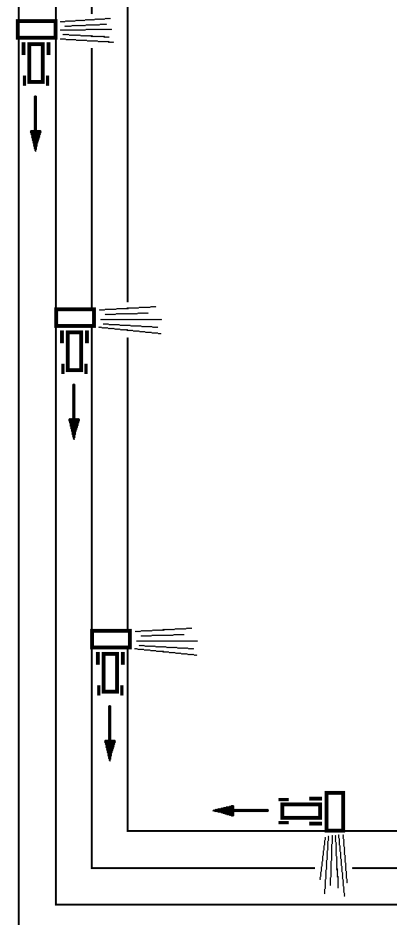

# OPERATION

## BEFORE OPERATING OR TRANSPORTING THIS MOWER

Always display this SMV emblem (**FIGURE 2**) on the rear of the tractor transporting this mower where it is clearly visible to oncoming traffic. Prominent display of this symbol will help the operator avoid accidents which could cause injury or possibly death.

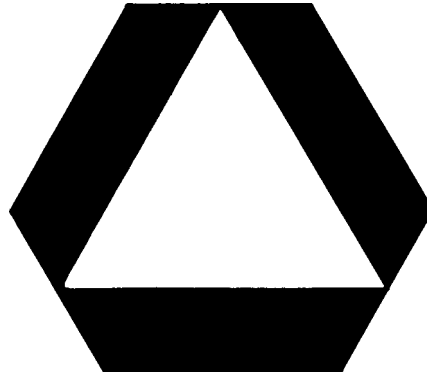

**FIGURE 2**

## DRIVELINE LENGTH CHECK PROCEDURE

### **WARNING!**



A loose shaft could slip off and result in personal injury or damage to cutter. When attaching PTO yoke to tractor PTO shaft, it is important that spring activated locking collar slides freely and locking balls are seated in groove on PTO shaft.

### **WARNING!**



Before operating cutter, check to make sure the driveline will not bottom out or become disengage.

- \* Disengage the Driveline from the tractor PTO Shaft.
- \* Slide the Driveline together until it "bottoms out" solidly.
- \* Apply colored tape to the Inner Shield 1/8" from the end of the Outer Shield. **FIGURE 3**
- \* Re-attach the Driveline to the PTO Shaft.

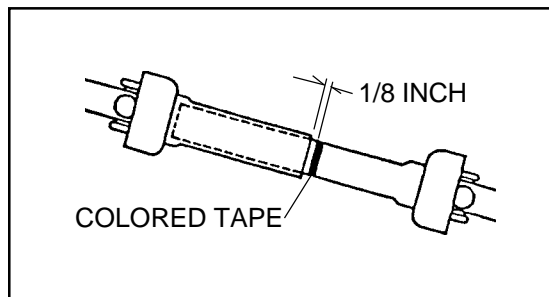

**FIGURE 3**

**Driveline in maximum compressed position**

# OPERATION

## DRIVELINE LENGTH

Raise mower to full transport or until driveline just hits deck at front. If distance between colored tape and outer shield tube is  $1\text{-}9/16$  or less, drive tubes should be shortened per **Figure 4**.

always maintain  $1\text{-}9/16$  clearance when operated in shortest working position. shorten inner and outer guard tubes equally. Shorten inner and outer sliding profiles by the same amount that the shield tubes were shortened. Round off all sharp edges and remove burrs. Grease sliding profiles. **Figure 4**.

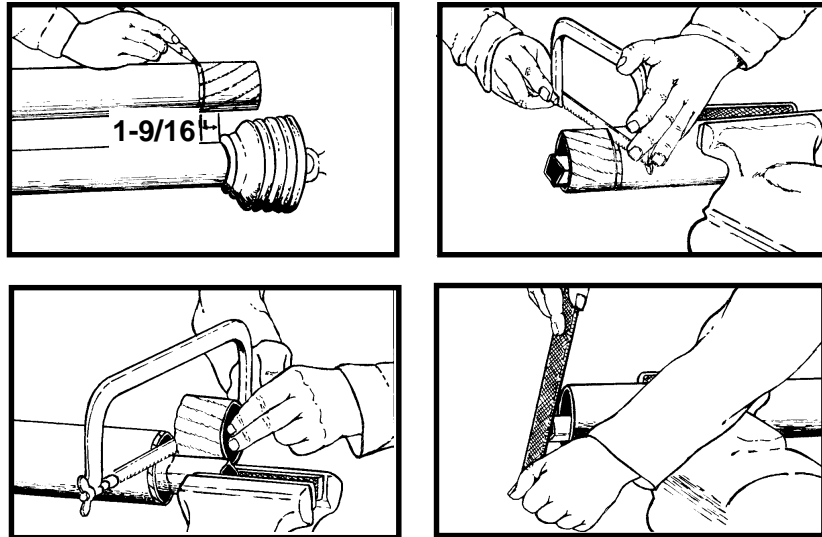

**FIGURE 4**

Lower mower to lowest position possible. Check distance from colored tape to end outer shield tube. Driveline tube engagement must always exceed 12 inches. If not consult dealer to obtain longer driveline.

## FRONT GAUGE WHEEL INTERFERENCE CHECK

Do not operate mower until this interference check has been performed. If you change tractors, you must perform the check for that mounting.

Raise mower with tractor hydraulics to maximum height of tractor lift.

Pivot both front gauge wheels forward and check that there is clearance between gauge wheels and tractor tires.

If there is interference, you must move hitch pin to extended position (See assembly section). Move tractor tires inward to obtain clearance or lower mower until clearance exists. Set 3-Point quadrant stop so mower cannot be raised beyond set point. **FIGURE 5**.

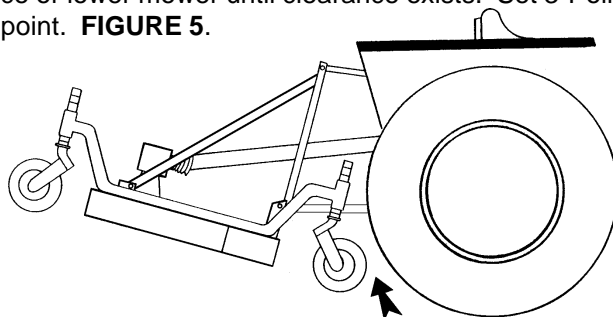

**Figure 5 - Front Gauge Wheel Clearance**

# OPERATION

## TROUBLESHOOTING

PROBLEM	POSSIBLE CAUSE	REMEDY
STREAKING	Slow Blade Speed Worn Blade Tips	Operate PTO at 540 RPM. Replace with Genuine <b>RHINO</b> Blades. See your Rhino dealer. Sharpen blades uniformly.
	Dull Blades Blades unable to cut that part of grass pressed down by path of tractor tires or casters Mowing Too Fast Drive Belt Loose Belt Glazed/Slipping	Slow ground speed of tractor but keep engine running at full PTO rpm. Cutting lower will help. Slow down until cured. Tighten per instructions. Apply belt dressing or replace with special <b>RHINO</b> belt.
	Blade Loose on Spindle	Tighten blade bolt securely. (Note: Left Hand threads Torque to 85 ft. lbs.)
	Conditions to wet for mowing	Allow grass to dry before mowing.
MATERIAL DISCHARGES FROM MOWER UNEVENLY, material BUNCHES MATERIAL ALONG SWATH	Material too high and too much	Reduce ground speed but maintain 540 rpm at tractor PTO, or make two passes over material. Raise the mower for the first pass and lower to desired height for the second and cut at 90 deg. to first pass. Raise rear of mower high enough to permit material to discharge, but not so high that conditions listed above occur.
	Belt Slipping	Tighten or replace with special <b>RHINO</b> belt.
	Grass Wet	Allow grass to dry before mowing. Slow ground speed of tractor but keep engine running at full PTO rpm. Cutting lower will help.
HEAVY VIBRATION	Too high blade speed Broken/bent Blade	Do not exceed 540 PTO RPM. Replace with genuine <b>RHINO</b> Blades. See your <b>RHINO</b> dealer. Grind uniformly or replace.
	Worn/Unbalanced Blade Bent/Broken Sheave Trash Hung on Blade	Replace parts. Clean off blade.
BELT SLIPPING	Belt loose	Tighten or replace with Special <b>RHINO</b> belt.
	Belt Glazed Oil on belt	Use belt dressing or replace. Clean or replace.

# OPERATION

## TROUBLESHOOTING

PROBLEM	POSSIBLE CAUSE	REMEDY
BELT SLIPPAGE	Mower overloading, material too tall or heavy	Reduce tractor ground speed but maintain full PTO rpm. Cut material twice, one high pass and then mow at desired height. Cut a partial swath.
	Oil on belt from over lubrication	Be careful not to over lubricate. Clean lubricant from belt and pulleys with clean rag. Replace oil soaked belt.
	Belt hung up or rubbing	Check belt for free travel in pulleys and belt guides. Check under mower and around blade spindle shafts for wire, rags, or other foreign material. Clean all material from under mower.
FRAYED EDGES ON COVER	Belt misaligned or belt rubbing guide. Pulley misalignment	Re-align belt or guide. Be sure belt doesn't rub any other part while running. Inspect to ensure belt is running in center of backside idler. Shim idler as necessary to align.
BELT ROLLOVER	Pulley misalignment Damaged belt Foreign object in pulley grooves	Re-align Replace belt.* Inspect all pulley grooves for rust, paint or weld spots and remove.
	Worn pulley groove	Replace pulley
DAMAGED BELT	Rollover, high shock loads or installation damage	Replace belt.*
BELT BREAKAGE	High shock loads	Avoid abusive mowing. Avoid hitting the ground or large obstructions.
	Belt came off drive	Check drive alignment for foreign material in grooves. Ensure proper tension. Avoid hitting solid objects or ground.

\*Check broken belt for damage by laying it flat on floor. If belt does not lie flat (has humps or twists), which indicated broken or stretched cords, it must be replaced.



# **MAINTENANCE SECTION**

# MAINTENANCE

Before operating your Finishing Mower, make sure it is properly lubricated and thoroughly inspected. Only a minimum of time and effort is required to regularly lubricate and maintain this machine to provide long life and trouble free operation.

**WARNING!**



Always disengage the PTO before raising the Rotary Cutter for transporting or making adjustments.

**LUBRICATION INFORMATION**

Do not let excess grease collect on or around parts, particularly when operating in sandy areas. The illustrations below shows lubrication points. The chart gives the frequency of lubrication in hours, based on normal operating conditions. Severe or unusual conditions may require more frequent lubrication. **Figure 1.**

Use an SAE multi-purpose, lithium-type grease for all locations shown. Be sure to clean the fitting thoroughly before using grease gun. Daily lubrication of the wing driveline slip joint is necessary. Failure to maintain proper lubrication will result in damage to U-joints, gearbox, and/or driveshaft.

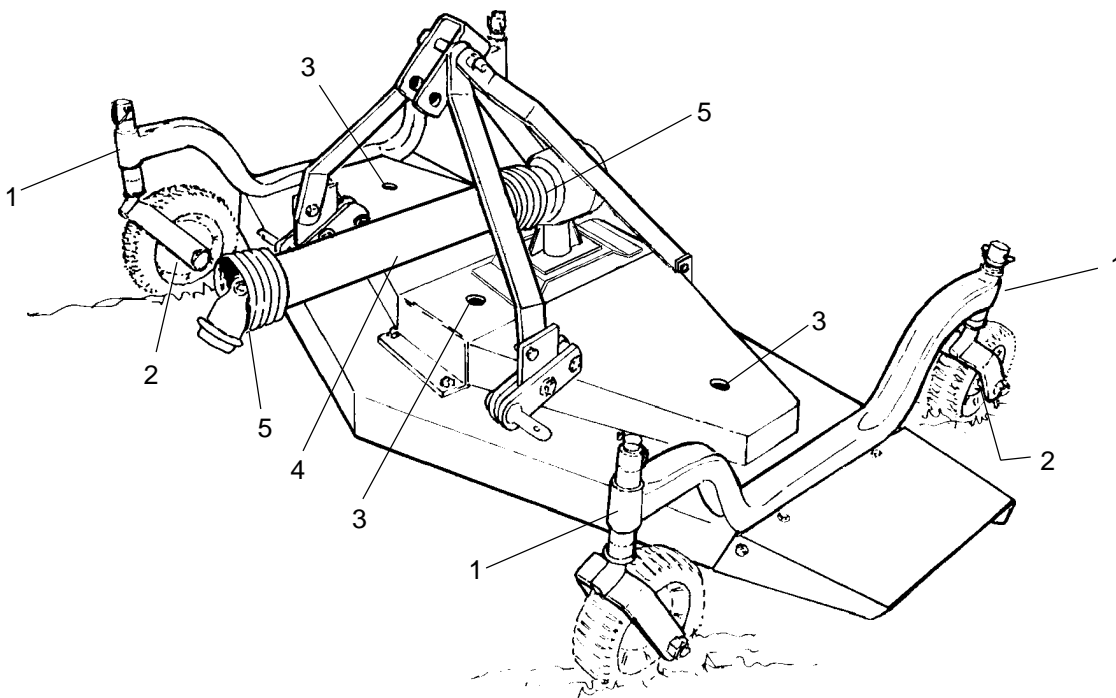

**LUBRICATION FITTING LOCATION FIGURE 1**

ITEM	DESCRIPTION	FREQUENCY
1	Gauge Wheel Pivots	8 Hours or daily
2	Wheel Hubs	8 Hours or daily
3	Blade Spindle	8 Hours or daily
4	U-Joint Telescoping Member	8 Hours or daily
5	U-Joints	8 Hours or daily

# MAINTENANCE

## GEARBOX

The Gearboxes have been filled with lubricant to the Test Plug Level prior to shipment. However, you should check the oil level at Test Plug before operating, and frequently thereafter.

The gearbox should not require additional lubricant unless the box is cracked or a seal is leaking. It is recommended that the oil level plug be removed after every 8 to 10 hours of operation and oil added until it runs out Test Plug hole. The Test Plug is located on the back of the Gearbox. Filler Plug is located on top back of Gearbox. **Figure 2.**

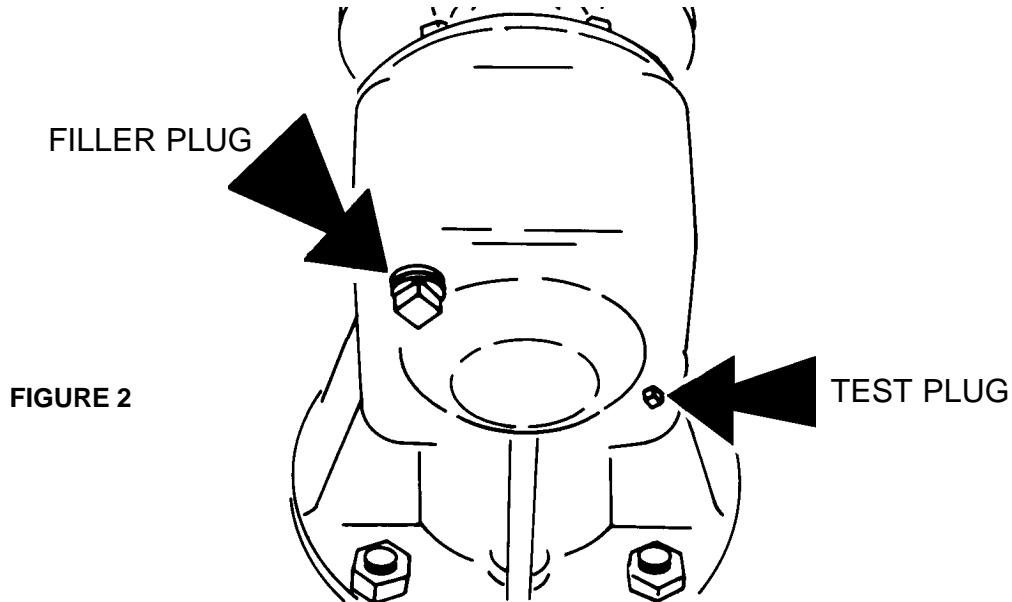

FIGURE 2

Recommended lubricant is NLGI 000 Grease, Rhino P/N 00769030.

**NOTE:** *Overfilling the Gearbox will cause pressure to build up and cause Oil Seals to leak.*

**ATTENTION:** If the Gearbox suddenly starts making an unusual noise, stop at once, check for leaks, and refill Gearbox as required.

## GAUGE WHEEL ASSEMBLIES

Gauge wheels are equipped with bushings which require grease daily. Grease Fittings are provided in the Wheel Hub and Gauge Wheel Pivot . Grease after 8 hours of use. **FIGURE 3 &4.**

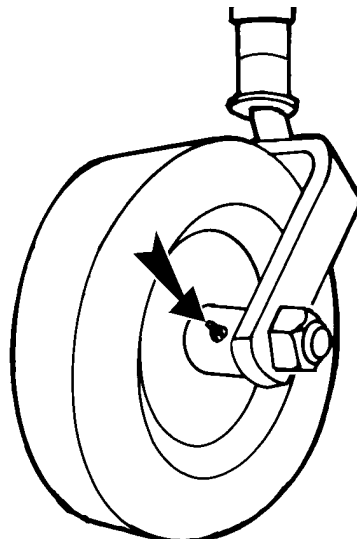

FIGURE 3

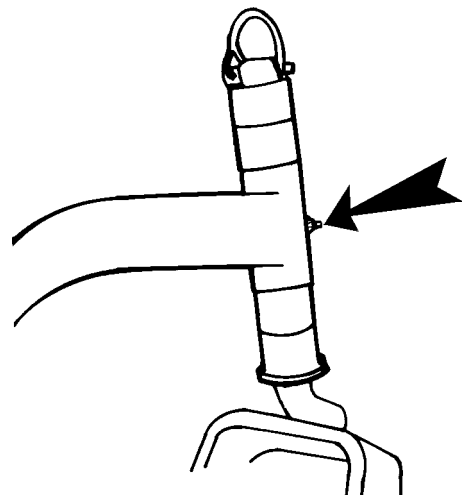

FIGURE 4

# MAINTENANCE

## DRIVELINE LUBRICATION

Grease Fittings are located on the Cross Assembly of each U-Joint and on the telescoping tubes. Grease the U-Joint after each 8 hours of use. Figure 4. Do not force grease through the Needle Cup Assemblies.

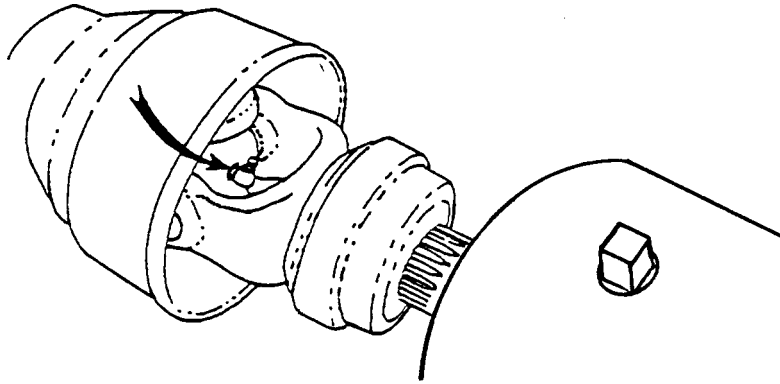

FIGURE 4

The telescoping PTO shaft inside the shielding must be lubricated daily. Figure 5.

Disconnect driveline from tractor and pull halves apart. Insert grease into outer profile cavity on half attached to gearbox and spread evenly. Install driveline halves together.

Reconnect driveline to tractor. Raise and lower cutter after applying grease to spread over joint working area.

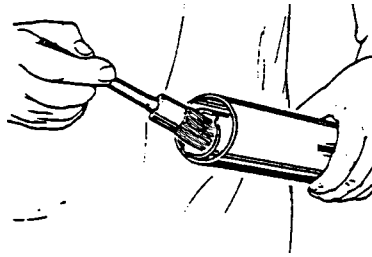

FIGURE 5

### WARNING!



When attaching PTO yoke to tractor PTO shaft, it is important that the spring-activated locking collar slides freely and locking ball are seated on the groove on PTO shaft. A loose yoke could off and result in personal injury or damage to cutter.

## BLADE SPINDLE LUBRICATION

Blade spindles must be lubricated daily (every 8 hrs). Access lubrication fitting through hole in outer sheilds and in center gearbox mounting. Each spindle has vent hole in top just under drive pulley and must be lubricated enough each time to force small amount of grease out. **NOTE:** Do not over lube as excess grease may get on belt drive.

# MAINTENANCE

## BLADE SERVICING

Inspect blades before each use to determine that they are properly installed and in good condition. Replace any blade that is bent, excessively nicked, worn, or has any other damage. Small nicks can be ground out when sharpening.

Use only original equipment blades on this cutter. They are made of special heat-treated alloy steel. Substitute blades may not meet specification and may fail in a hazardous manner that could cause injury.

## BLADE SHARPENING

Always sharpen both cutting edges of each blade at the same time, the same amount, to maintain balance. Follow original sharpening pattern as shown. Do not sharpen blade to a razor edge, but leave a 1/32" blunt edge. Do not shapen back side of blade. **Figure 6.**

### WARNING!

Avoid personal injury. Always block the cutter up to prevent it from falling when the blades and/or carrier are being serviced.



MAINTAIN CORNER

FOLLOW ORIGINAL PAT-  
TERN

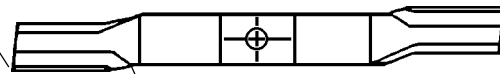

1/32"

**FIGURE 6**

## BLADE REMOVAL

Hold the end of blade using heavy leather gloves and remove left hand threaded bolt.

## BLADE INSTALLATION

Install washer on blade bolt, insert bolt into blade, insert seal protector washer over blade bolt and then thread bolt into spindle shaft. **NOTE:** Blade bolt has left hand threads. Tighten blade bolt to 85 ft. lbs. torque. Use heavy leather gloves during tightening process to hold blade and wrench.

# MAINTENANCE

## BELT ADJUSTMENT PROCEDURE Figure 7.

Shut off mower and tractor. Loosen all four nuts (item 1) on gearbox slide plate (item 2). Loosen jam nut (item 3) on tension adjustment bolt (item 4). Tighten adjustment bolt (item 5) until belt deflection along front of belts (item 6 & 7) is 3/4" with approximately 10 pounds applied to center of length. **DO NOT OVERTIGHTEN.** Tighten jam nut (item 3) and nuts (item 1) on gearbox slide plate.

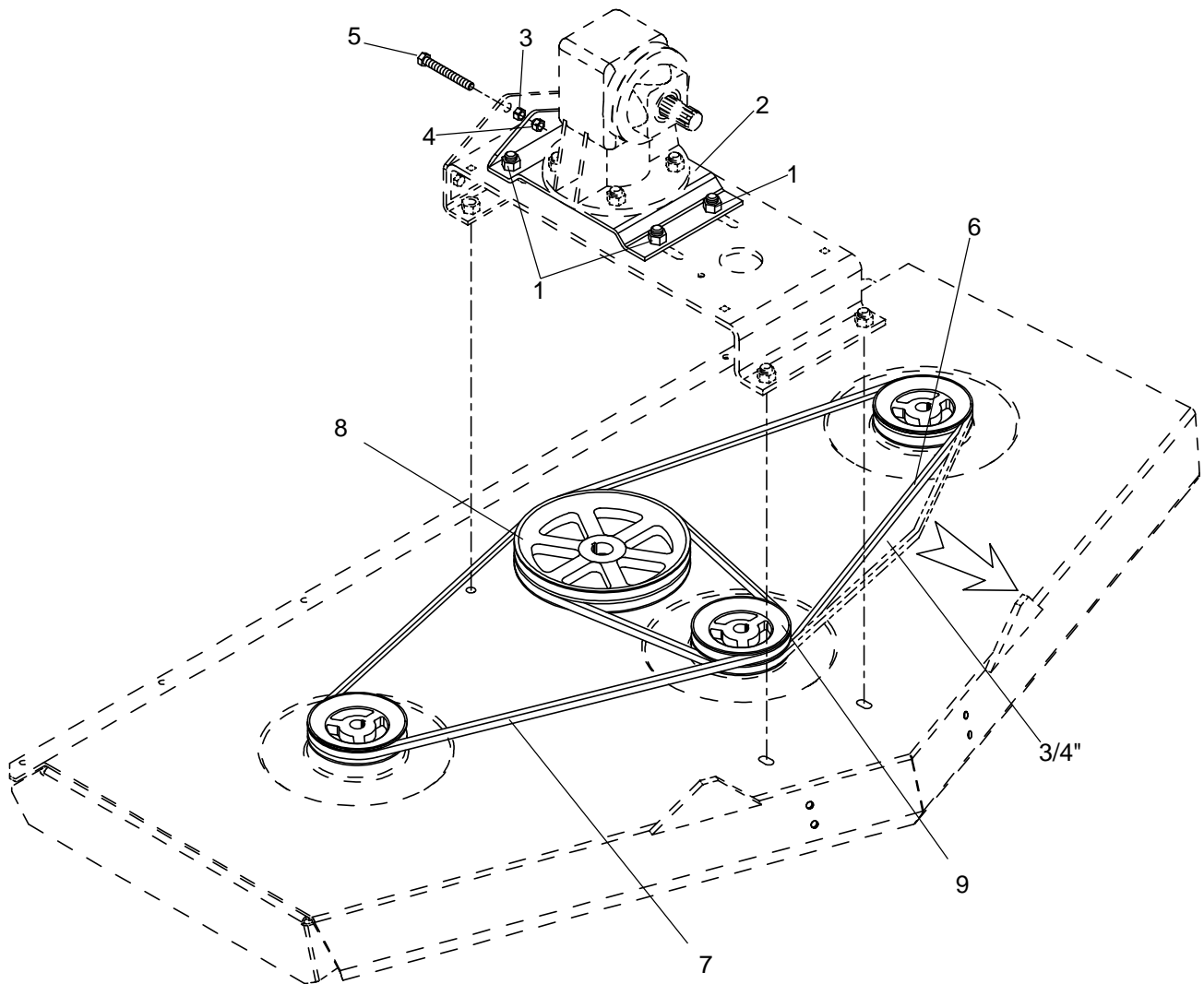

FIGURE 7

## BELT REMOVAL/INSTALLATION Figure 7.

Shut off mower and tractor. Remove belt shield fasteners and belt shields. Loosen gearbox slide plate bolts and gear box adjustment bolt. Slide gearbox to the full forward position. Slip belts under gearbox sheave (item 8) and over center spindle sheave (item 9). Slip new belts under gearbox sheave (item 8) and over center spindle sheave (item 9). Ensure that right-hand belt (item 7) is in the upper groove of gearbox sheave and that left-hand belt (item 6) is in the lower groove of gearbox sheave. Slide gearbox to the full rear position and adjust according to Belt Adjustment Procedure. Reinstall shields and shield fasteners.

# MAINTENANCE

## STORAGE

Your rotary mower represents an investment from which you should get the greatest possible benefit. Therefore, when the season is over, the cutter should be thoroughly checked and prepared for storage so that a minimum amount of work will be required to put it back into operation for the next season. The following are suggested storage procedures:

1. Thoroughly clean the cutter.
2. Lubricate the cutter as covered in Maintenance Section.
3. Tighten all bolts and pins to the recommended torque.
4. Check the cutter for worn or damaged parts. Make replacements immediately.
5. Store the cutter in a clean, dry place with the cutter housing resting on blocks.
6. Use spray touch-up enamel where necessary to prevent rust and maintain the appearance of the cutter.



## PROPER TORQUE FOR FASTENERS

The chart lists the correct tightening torque for fasteners. When bolts are to be tightened or replaced, refer to this chart to determine the grade of bolts and the proper torque except when specific torque values are assigned in manual text.





RECOMMENDED TORQUE IN FOOT POUNDS UNLESS OTHERWISE STATED IN THE MANUAL\*

**NOTE:** These values apply to fasteners as received from supplier, dry or when lubricated with normal engine oil. They do not apply if special graphited or molydisulphide greases or other extreme pressure lubricants are used. This applies to both UNF fine and UNC coarse threads.

Proper Torque values for bolts that are measured in Inches

Bolt Diameter			
	Head Marking No Marks Grade Two	Head Marking Three Lines Grade Five	Head Marking Six Lines Grade Eight
	Pound - Foot Value Dry	Pound - Foot Value Dry	Pound - Foot Value Dry
1/4"	5.5	9	12.5
5/16"	11	18	26
3/8"	20	33	46
7/16"	32	52	75
1/2"	50	80	115
9/16"	70	115	160
5/8"	100	160	225
3/4"	175	280	400
7/8"	175	450	650
1"	270	675	975
1-1/8"	375	850	1350
1-1/4"	530	1200	1950
1-3/8"	700	1550	2550
1-1/2"	930	2100	3350

Proper Torque values for Metric bolts

Bolt Diameter				
	Head Marking 4.8	Head Marking 8.8 or 9.8	Head Marking 10.9	Head Marking 12.9
	Pound - Foot Value Dry	Pound - Foot Value Dry	Pound - Foot Value Dry	Pound - Foot Value Dry
6mm	4.5	8.5	12	14.5
8mm	11	20	30	35
10mm	21	40	60	70
12mm	37	70	105	120
14mm	60	110	165	190
16mm	92	175	255	300
18mm	125	250	350	410
20mm	180	350	500	580
22mm	250	475	675	800
24mm	310	600	850	1000
27mm	450	875	1250	1500
30mm	625	1200	1700	2000

To get Newton-Meters multiply pound-foot of torque by 1.356

\*

# MAINTENANCE

## BLADE SPINDLE SERVICE INSTRUCTIONS Figure 9

### DISASSEMBLY

1. Remove 4 capscrews (#1) from housing. Tap with plastic or wood hammer to break halves apart. Lay top half aside.
2. Remove complete shaft assembly from other housing half. Remove seals (#2) from each end of shaft. Remove retaining ring (#3) near top end of shaft. Press bearings and cups from shaft.

### ASSEMBLY

1. Assemble all parts in reverse order that they were removed.
2. Press lower roller bearing (#5) onto shaft. NOTE: Tapered rollers should point toward center of shaft. Install lower bearing cup (#4).
3. Drop upper bearing cup (#4) over shaft. NOTE: Small ID of cup should face toward lower cup. Press top bearing into place and install retaining ring(#3).
4. Lubricate seal ID and tap top shaft end with plastic tape to cover sharp edge. Slide seal over each shaft end.
5. Place shaft assembly into one half of housing. Place 1/16 inch bead of gasket compound on both sides of housing half.
6. Install other half of housing and install capscrews. Torque capscrews evenly to 15-20 ft-lb. torque.

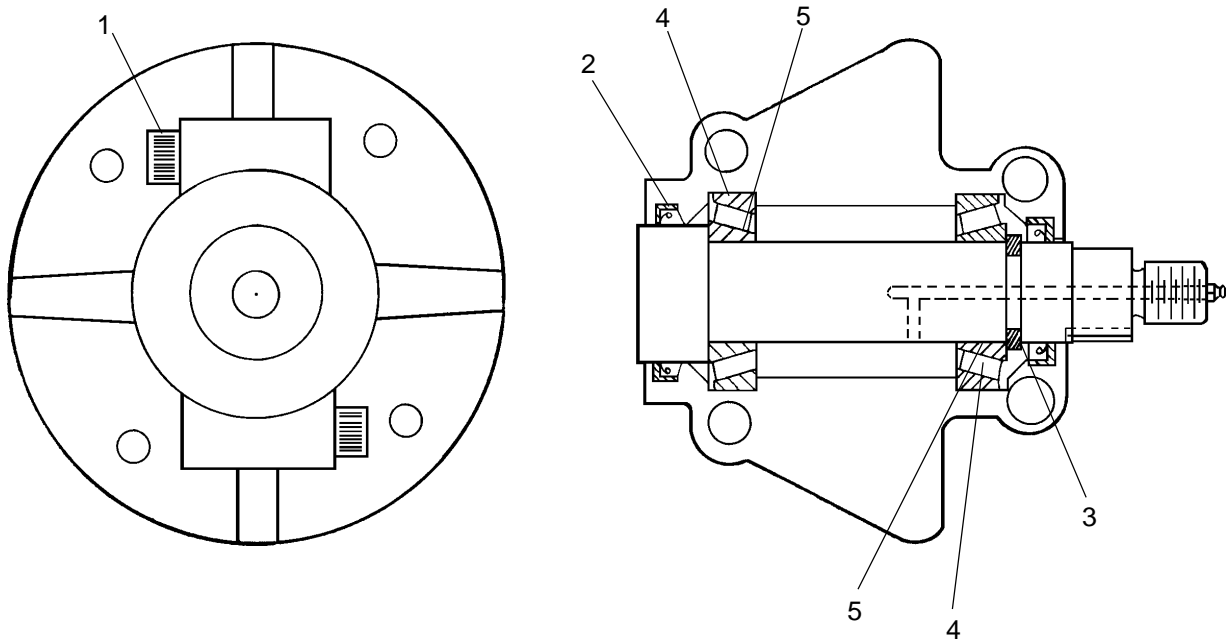

FIGURE 9



# **PARTS SECTION**

# PARTS ORDERING GUIDE

The following instructions are offered to help eliminate needless delay and error in processing purchase orders for the equipment in this section.

1. The Parts Section is prepared in logical sequence and grouping of parts that belong to the basic machine featured in this manual. Part Numbers and Descriptions are given to help locate the parts and quantities required.
2. The Purchase Order must include the name and address of the person or organization ordering the parts, who should be charged, and if possible, the serial number of the machine for which the parts are ordered.
3. The Purchase Order must clearly list the quantity of each part, the complete and correct part number, and the basic name of the part.
4. The Manufacturer reserves the right to substitute parts where applicable.
5. Some parts are unlisted items which are special production items not normally stocked and are subject to special handling. Request a quotation for such parts before sending a Purchase Order.
6. The Manufacturer reserves the right to change prices without prior notice.

**NOTE:** Please refer to The Safety Section in the front of this Manual for the proper Part Number when ordering Replacement Safety Decals.



For maximum safety and to guarantee optimum product reliability, always use genuine Rhino Parts. The use of inferior replacement parts may cause premature or catastrophic failure which could result in serious injury or death. Direct any questions regarding parts to:



**Alamo Industrial**  
**1502 E. Walnut**  
**Seguin, Texas 78155**  
**830-372-3551**

# PARTS TABLE OF CONTENTS

Driveline Assembly .....	6-5
3-Point Lift Assembly .....	6-8
Gearbox Assembly .....	6-10
Shield Assembly .....	6-12
Blade and Spindle Assembly .....	6-14
Spindle and Housing Assembly .....	6-15
Front Roller Assembly (Extra Equipment) .....	6-16
Caster Wheel Assembly .....	6-17
Belt Assembly 60" .....	6-18
Belt Assembly 72" .....	6-20

# GENERAL ASSEMBLY

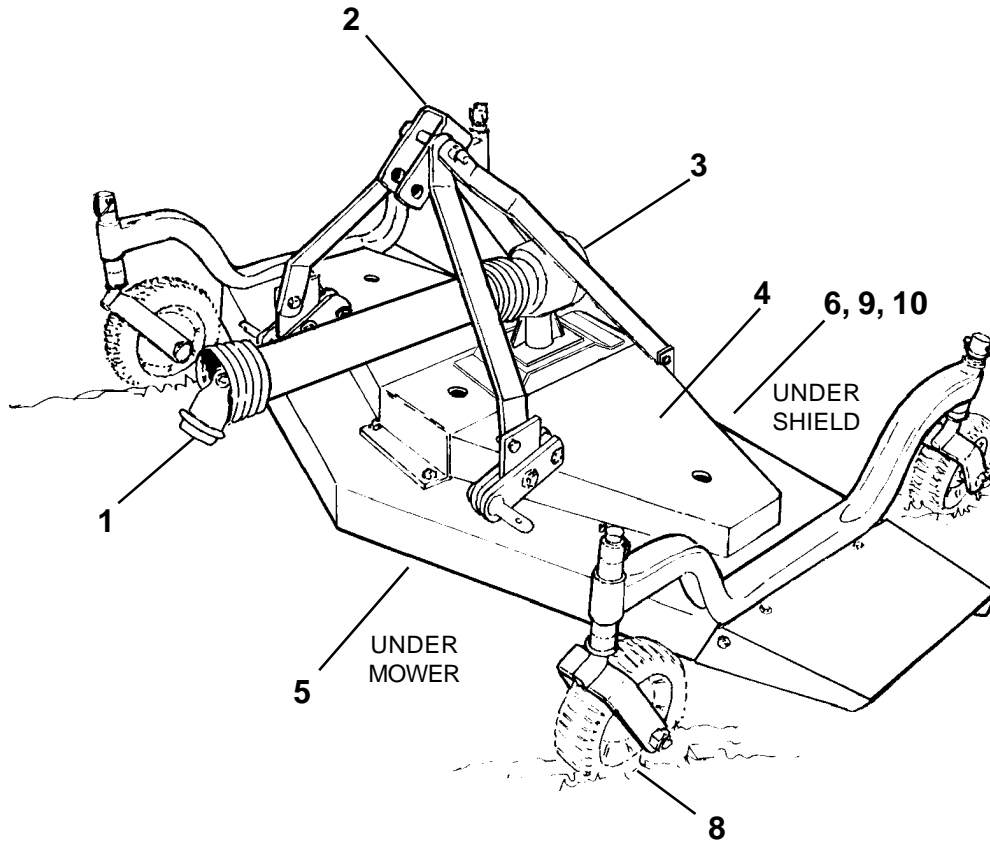

ITEM	PAGE NO.	DESCRIPTION
1	6-5	Driveline Assembly
2	6-8	3-Point Lift Assembly
3	6-10	Gearbox Assembly
4	6-12	Shield Assembly
5	6-14	Blade and Spindle Assembly
6	6-15	Spindle and Housing Assembly
7	6-16	Front Roller Assembly (not shown)
8	6-17	Caster Wheel Assembly
9	6-18	Belt Assembly 60"
10	6-20	Belt Assembly 72"

# DRIVELINE ASSEMBLY

EFFECTIVE S/N  
FM60 - 11471  
FM72 - 11741  
AND ABOVE

## CAT II Driveline

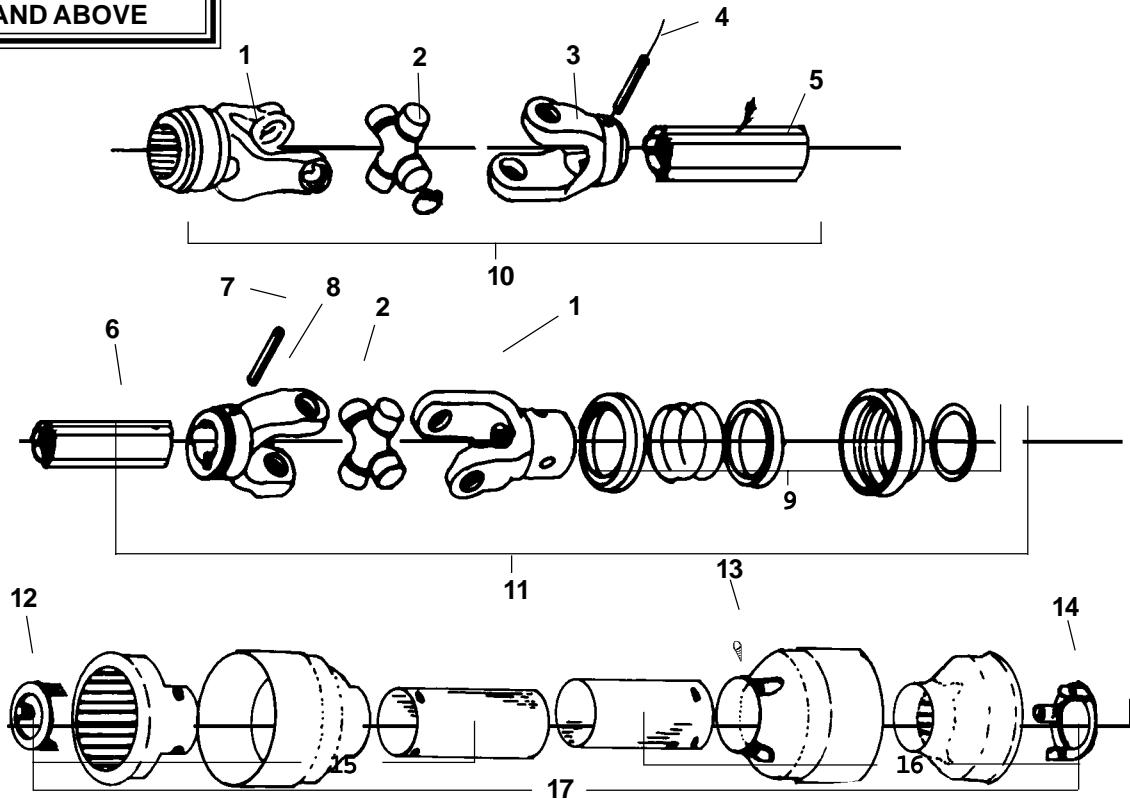

ITEM	PART NO	QTY	DESCRIPTION
	<b>00764519</b>	-	<b>Driveline Assembly</b>
1	00764500	2	Collar Yoke
2	00756231	2	Cross Journal Set
3	00759168	1	Outer Yoke
4	00759169	1	Roll Pin
5	00764501	1	Outer Tube
6	00764502	1	Inner Tube
7	00759165	1	Roll Pin
8	00759164	1	Inner Yoke
9	00764503	2	Collar Kit
10	00764504	1	Half - Outer Shaft
11	00764505	1	Half - Inner Shaft
12	00764506	1	Retaining Collar
13	00754330	6	Bolt
14	00764507	1	Retaining Guard
15	00764508	1	Half Shield
16	00764509	1	Half Shield
17	00764510	1	Complete Shield

# DRIVELINE ASSEMBLY

**EFFECTIVE S/N**  
**FM60 - 11471**  
**FM72 - 11741**  
**AND ABOVE**

## CAT I Driveline

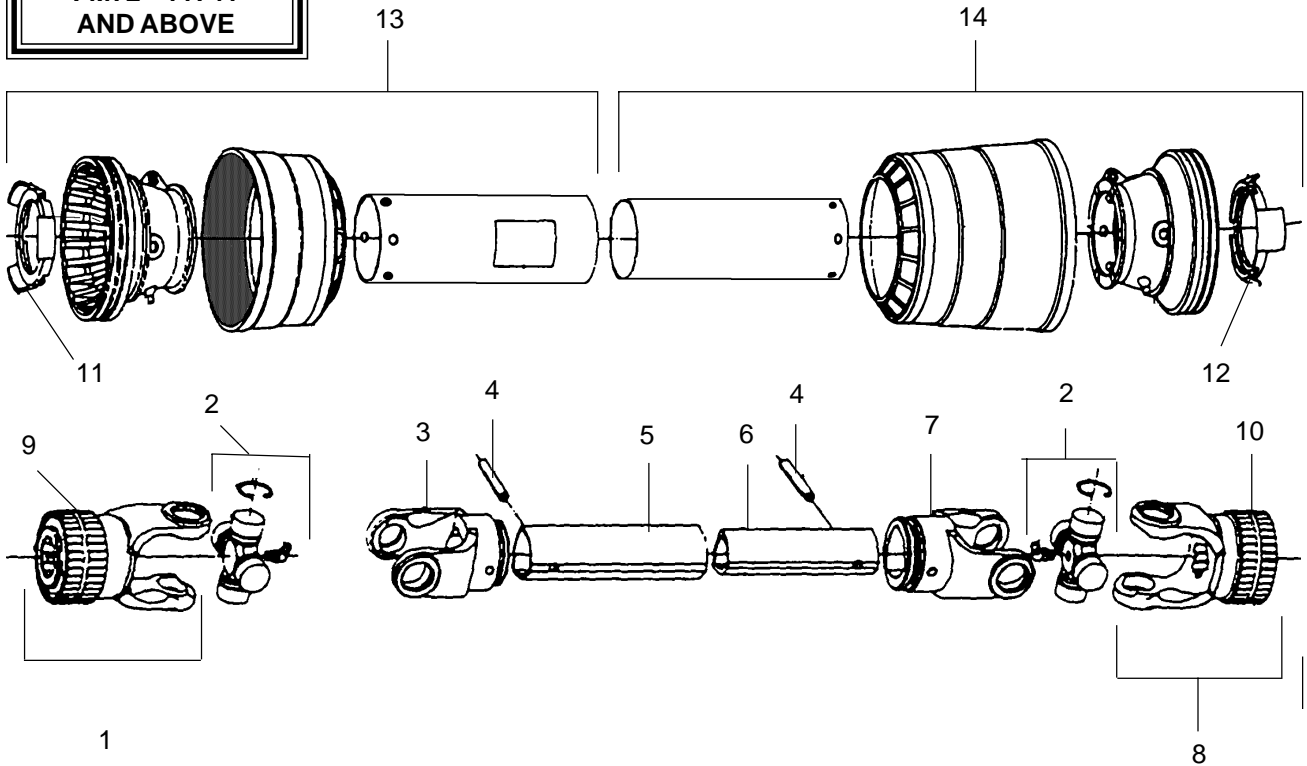

ITEM	PART NO.	QTY	DESCRIPTION
	<b>00769691</b>	-	<b>Driveline Assembly</b>
1	00770383	1	Yoke Assembly (Tractor End) (inc #9)
2	00770384	2	Cross Assembly
3	00770385	1	Outer Tube Yoke Assy.
4	00759165	2	Roll Pin
5	00770386	1	Outer Tube
6	00770387	1	Inner Tube
7	00770388	1	Inner Tube Yoke Assy
8	00770389	1	Yoke Assembly (Implement End) (inc. #10)
9	00770391	1	Slide Collar Repair Kit (Outer Tube Yoke, Black)
10	00770390	1	Slide Collar Repair Kit (Inner Tube Yoke, Red)
11	00770379	1	Outer Tube Bearing
12	00770380	1	Inner Tube Bearing
13	00770381	1	Outer Tube Shield (inc. # 11)
14	00770382	1	Inner Tube Shield (inc. #12)

# DRIVELINE ASSEMBLY

EFFECTIVE S/N  
FM60 - 11470  
FM72 - 11740  
AND BELOW

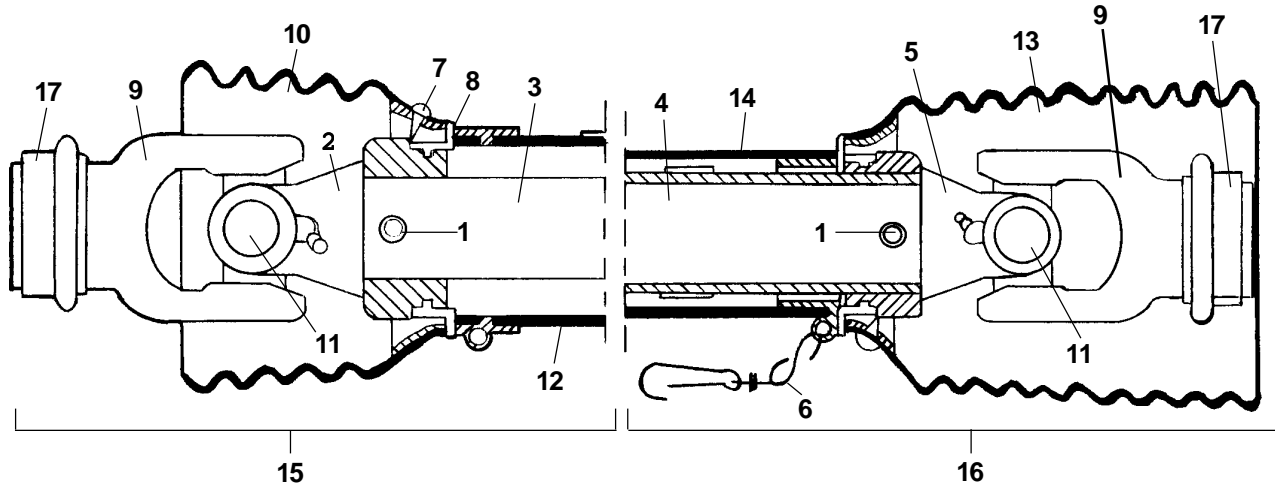

ITEM	PART NO.	QTY	DESCRIPTION
	<b>4801</b>	-	<b>Driveline Assembly</b>
1	00759694	2	Pin, Spring
2	00759695	1	Yoke, Inboard
3	00759696	1	Shaft, Inner
4	00759697	1	Shaft, Outer
5	00759698	1	Yoke, Inboard
6	0921000345	1	Chain, Safety
7	4797	2	Screw
8	4798	2	Bearing Ring
9	4865	2	Yoke 1-3/8 6 Spline
10	4866	1	Shield Cone
11	4867	2	Cross & Bearing Kit
12	4868	1	Tube-Outer Shield Oval
13	4878	1	Shield Cone 10 Rib
14	4879	1	Tube-Inner Shield Round
15	4923	1	Driveline-Inner Half
16	4924	1	Driveline-Outer
17	00767954	2	Yoke Q.D. Kit

# 3-POINT LIFT ASSEMBLY

EFFECTIVE S/N  
FM60 - 11471  
FM72 - 11741  
AND ABOVE

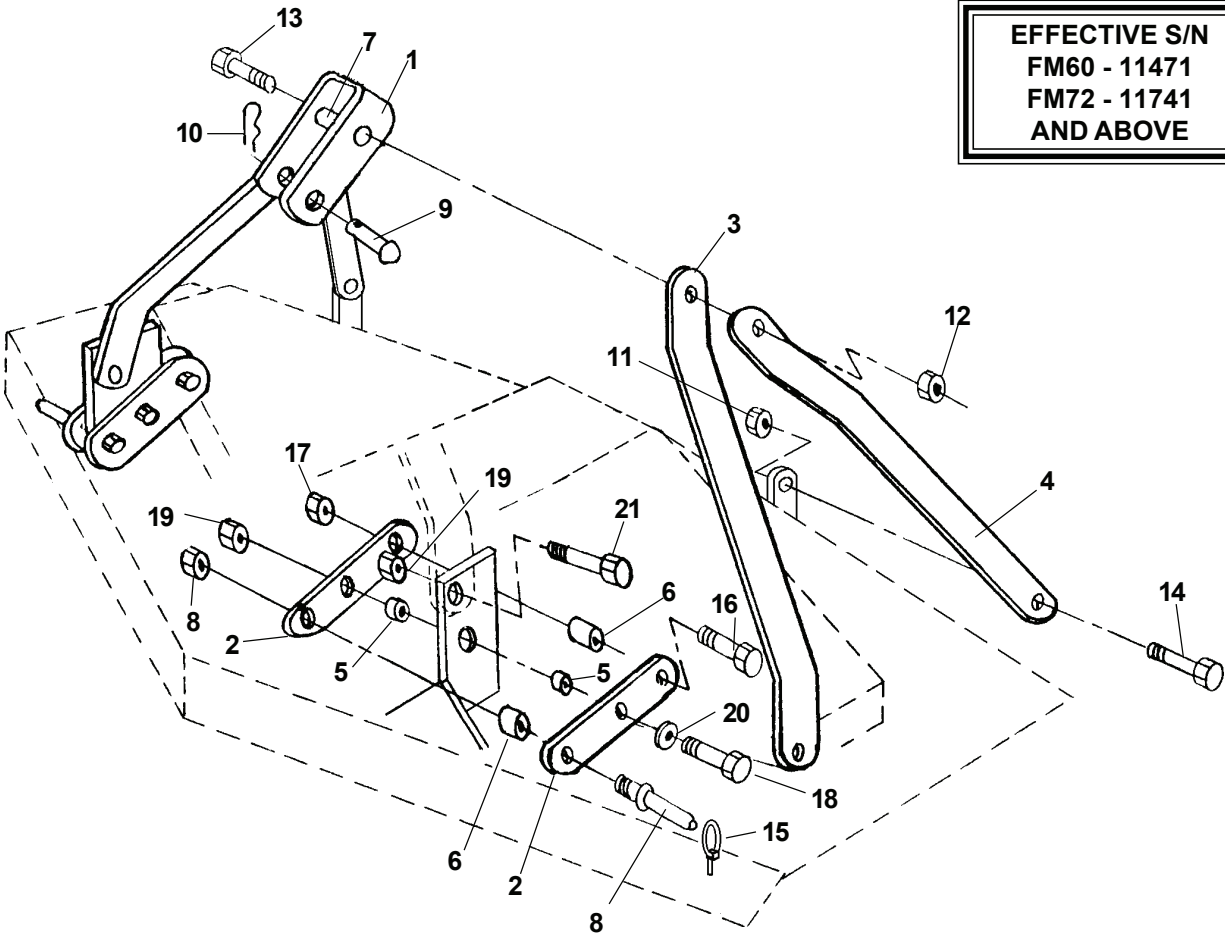

ITEM	PART NO.	QTY	DESCRIPTION
1	00757949	1	Bar - Top Link
2	00761718	4	Bar - Hitch Pin
3	00769453	2	Bar - A - Frame
4	00769452	2	Bar - Rear Brace FM60
	00769549	2	Bar - Rear Brace FM72
5	00761724	4	Bushing Hitch
6	00762082	4	Bushing Hitch
7	00757953	1	Bushing
8	00603500	2	Pin, Hitch Cat I
9	37107B12	1	Pin - Top Link Cat I
10	37107B13	1	Pin - Hair Clip
11	00001800	2	Locknut TLM 1/2 NC PLC
12	00037200	1	Locknut
13	00748598	1	Bolt
14	02030700	2	Bolt
15	2196	2	Lynch Pin
16	02793900	2	Bolt
17	5JRC1490	2	Locknut
18	00750952	2	Bolt
19	00695100	4	Nut, Toplock 5/8 NC PLC
20	00001400	4	Flatwasher
21	02675800	2	Bolt



# 3-POINT LIFT ASSEMBLY

EFFECTIVE S/N  
FM60 - 11470  
FM72 - 11740  
AND BELOW

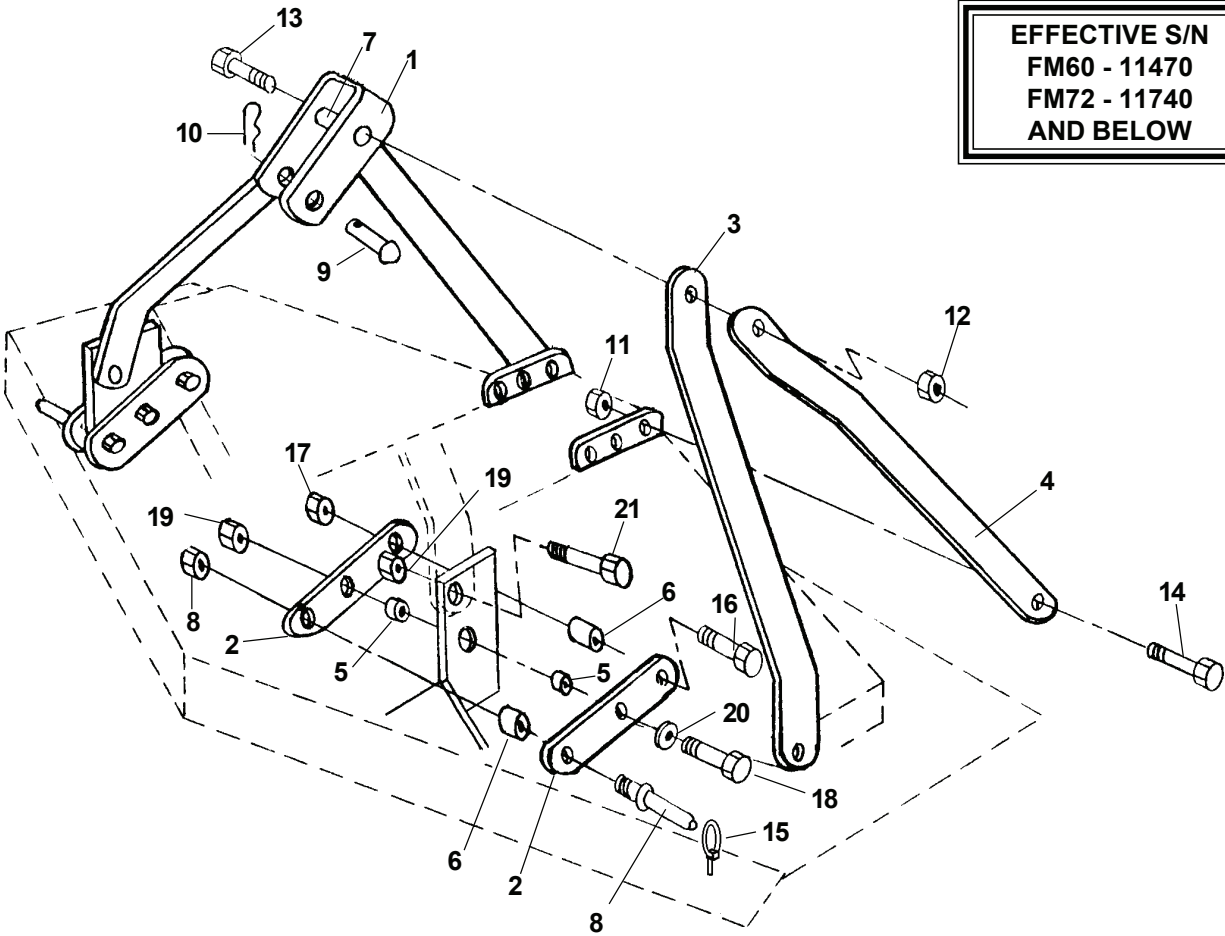

ITEM	PART NO.	QTY	DESCRIPTION
1	00757949	1	Bar - Top Link
2	00761718	4	Bar - Hitch Pin
3	00769453	2	Bar - A - Frame
4	00761735	2	Bar - Rear Brace FM60
	00761719	2	Bar - Rear Brace FM72
5	00761724	4	Bushing Hitch
6	00762082	4	Bushing Hitch
7	00757953	1	Bushing
8	00603500	2	Pin, Hitch Cat I
9	37107B12	1	Pin - Top Link Cat I
10	37107B13	1	Pin - Hair Clip
11	00001800	2	Locknut TLM 1/2 NC PLC
12	00037200	1	Locknut
13	00748598	1	Bolt
14	02030700	2	Bolt
15	2196	2	Lynch Pin
16	02793900	2	Bolt
17	5JRC1490	2	Locknut
18	00750952	2	Bolt
19	00695100	4	Nut, Toplock 5/8 NC PLC
20	00001400	4	Flatwasher
21	02675800	2	Bolt

# GEARBOX ASSEMBLY

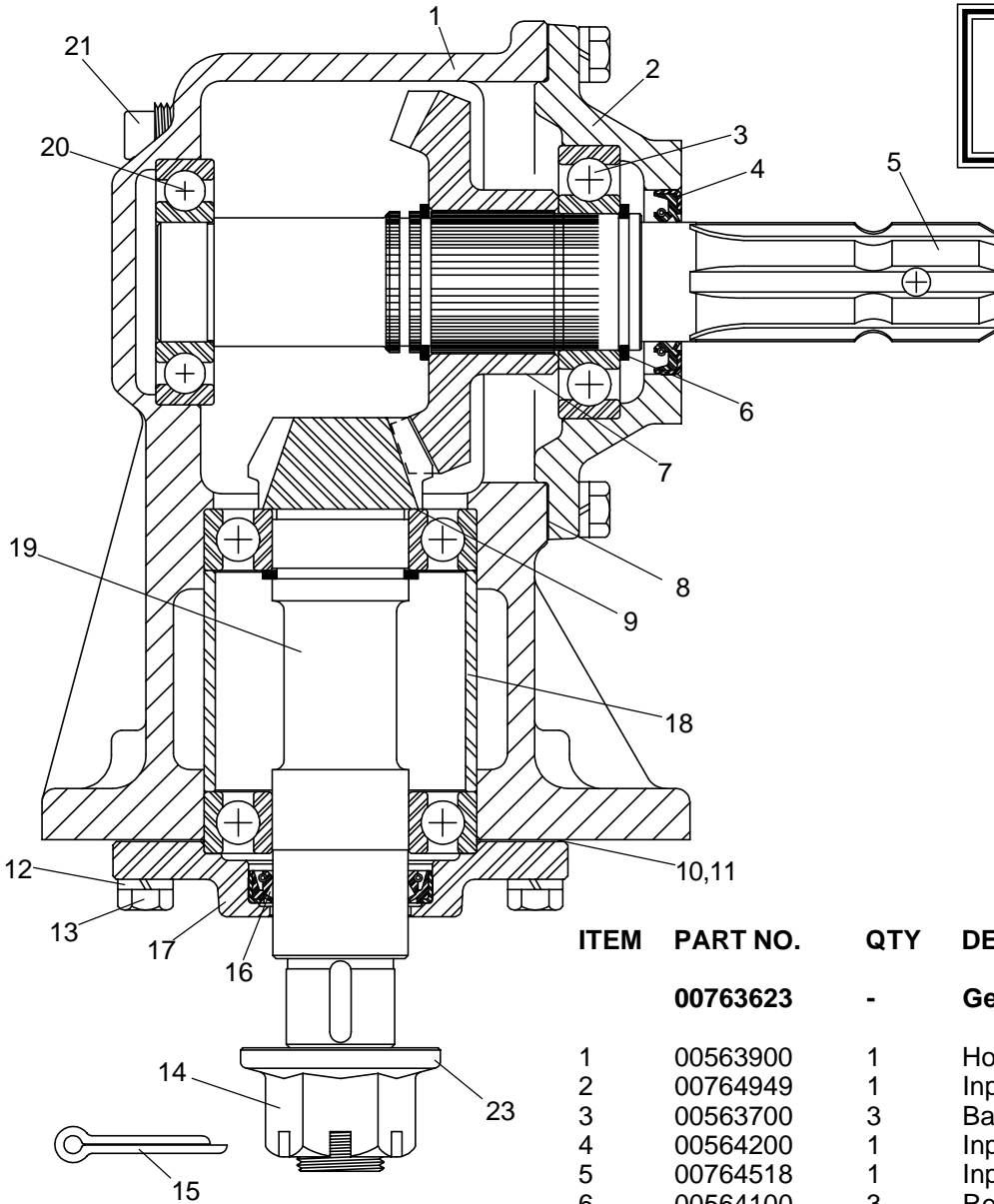

<b>EFFECTIVE S/N</b> <b>FM60 - 11471</b> <b>FM72 - 11741</b> <b>AND ABOVE</b>
--

ITEM	PART NO.	QTY	DESCRIPTION
	<b>00763623</b>	-	<b>Gearbox Assembly</b>
1	00563900	1	Housing
2	00764949	1	Input Cap
3	00563700	3	Ball Bearing
4	00564200	1	Input Seal
5	00764518	1	Input Shaft
6	00564100	3	Retaining Ring
7	00764516	1	Input Gear
8	00564400	A/R	Input Gasket (.30)
9	00758671	1	Shim
10	00760929	A/R	Output Gasket (.30)
11	00760928	A/R	Output Gasket (.13)
12	02161100	10	Lockwasher
13	00011400	10	Cap Screw
14	1423	1	Slotted Hex Nut
15	00606000	1	Cotter Pin
16	00563500	1	Output Seal
17	00757683	1	Output Cap
18	00757682	1	Output Bearing Spacer
19	00764517	1	Output Shaft & Pinion
20	00564800	1	Ball Bearing
21	00749508	1	Oil Fill Plug
22	00565000	1	Level Plug
23	6192	1	Washer

# GEARBOX ASSEMBLY

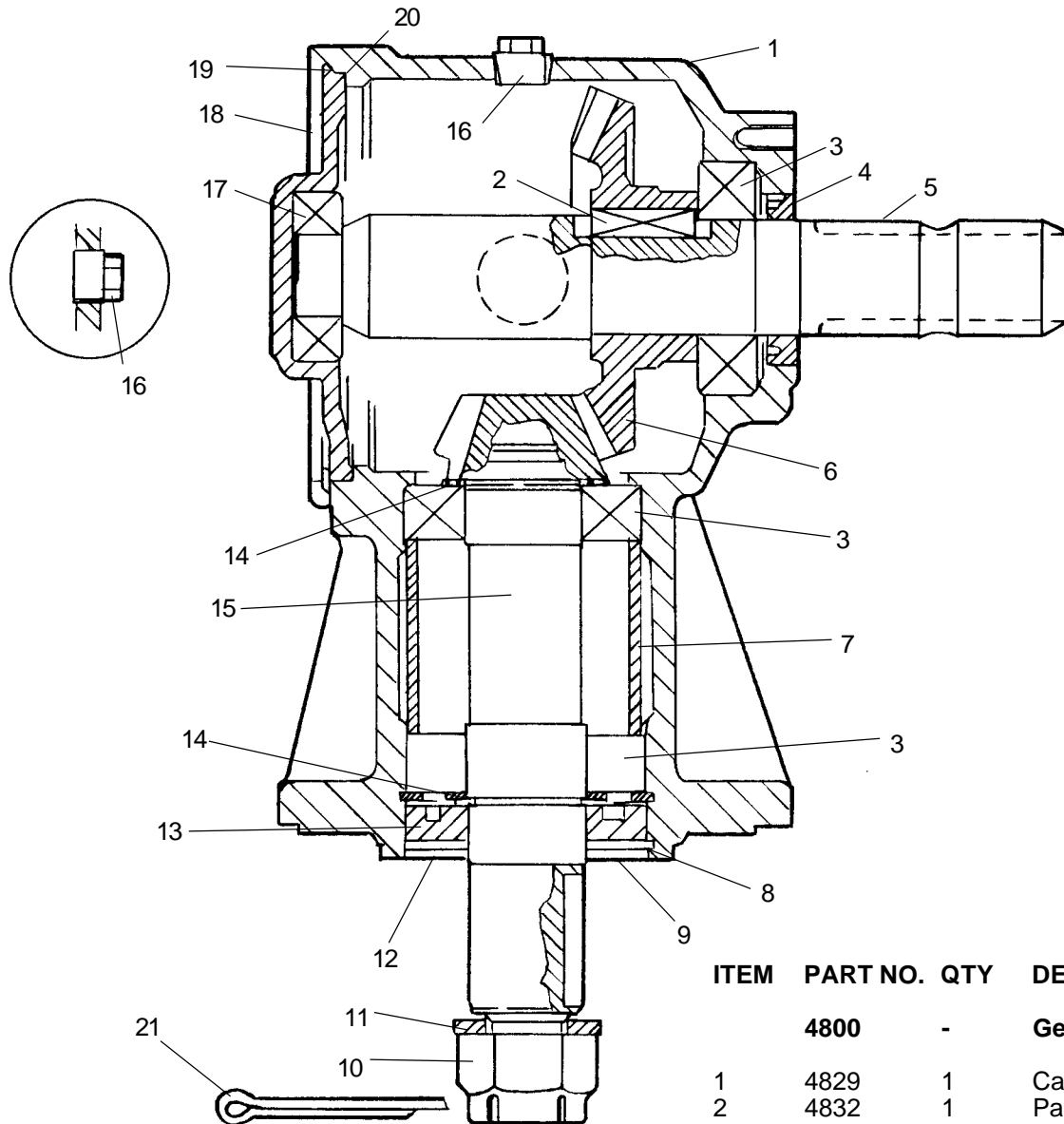

**EFFECTIVE S/N**  
**FM60 - 11470**  
**FM72 - 11740**  
**AND BELOW**

ITEM	PART NO.	QTY	DESCRIPTION
	<b>4800</b>	-	<b>Gearbox Assy</b>
1	4829	1	Casing
2	4832	1	Parallel Key
3	4833	3	Bearing
4	4834	1	Oil Seal
5	4835	1	Shaft
6	4836	1	Drivegear
7	4837	1	Spacer
8	4838	1	Internal Circlip
9	4839	1	External Circlip
10	4840	1	Castle Nut
11	4846	1	Bolt Washer
12	4847	1	Shoulder Ring
13	4848	1	Dust Excluder
14	4849	2	Shim
15	4850	1	Pinon Shaft
16	4851	2	Plug
17	4852	1	Bearing
18	4853	1	Cover
19	4855	1	Shoulder Ring
20	4857	1	O-Ring
21	7343	1	Cotter Pin

# SHIELD ASSEMBLY

EFFECTIVE S/N  
FM60 - 11471  
FM72 - 11741  
AND ABOVE

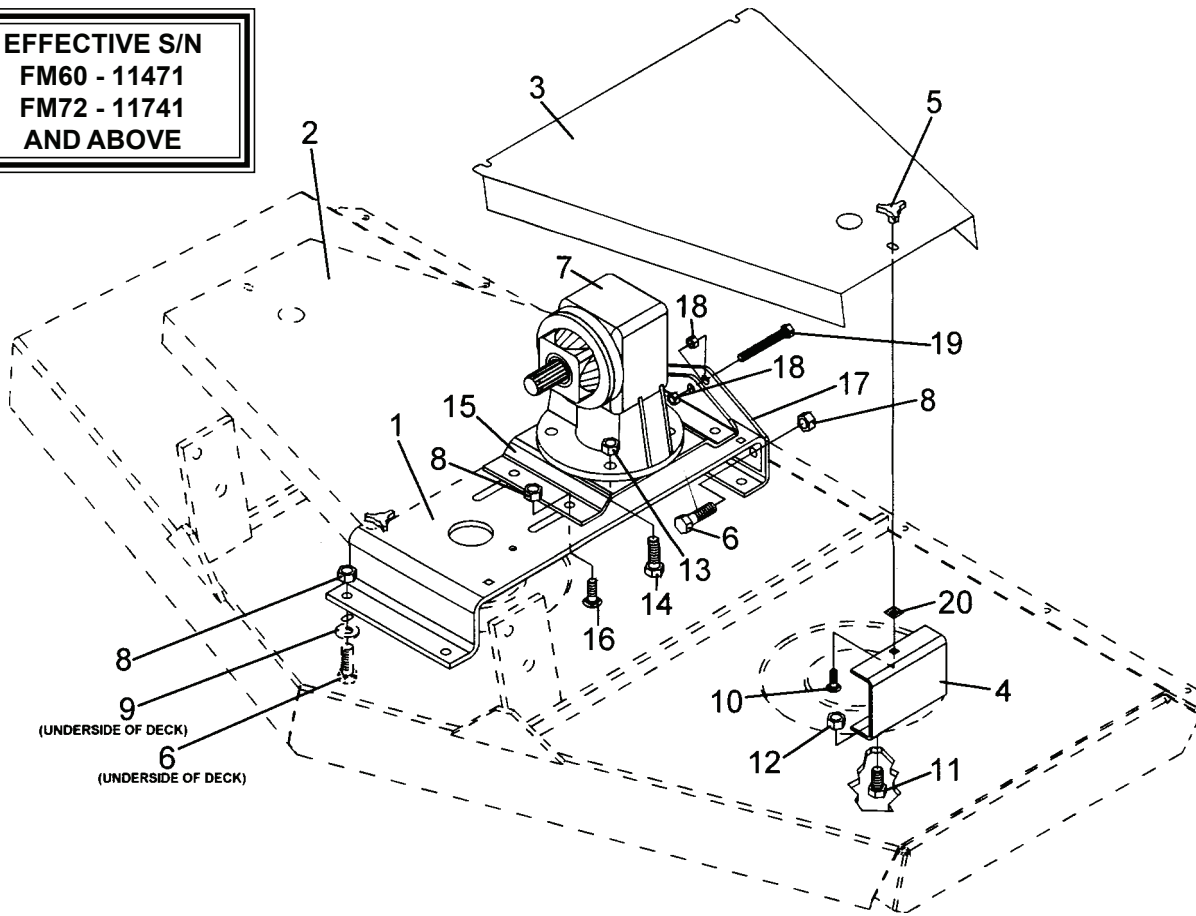

ITEM	PART NO.	QTY	DESCRIPTION
1	00769445	1	Gearbox Mount
2	00769449	1	Shield FM60- RH
	00769536	1	Shield FM72- RH
3	00769448	1	Shield FM60- LH
	00769535	1	Shield FM72- LH
4	00769896	2	Shield Support Bracket
5	00769933	6	Nut - Plastic Thumb
6	00748823	6	Bolt
7	00763623	1	Gearbox
8	00001800	10	Locknut TLM 1/2 NC PLC
9	00002700	2	Flatwasher
10	26168	6	Carriage Bolt
11	00011400	4	Bolt
12	00015800	4	Locknut
13	00695100	4	Nut, Toplock 5/8 NC PLC
14	2101112	4	Bolt
15	00769451	1	Gearbox Slide Plate
16	02886900	4	Carriage Bolt
17	00769446	1	Gearbox Adjustment Plate
18	00013901	2	Nut
19	00769898	1	Belt Adjustment Bolt
20	02961255	6	Push Nut

# SHIELD ASSEMBLY

EFFECTIVE S/N  
FM60 - 11470  
FM72 - 11740  
AND BELOW

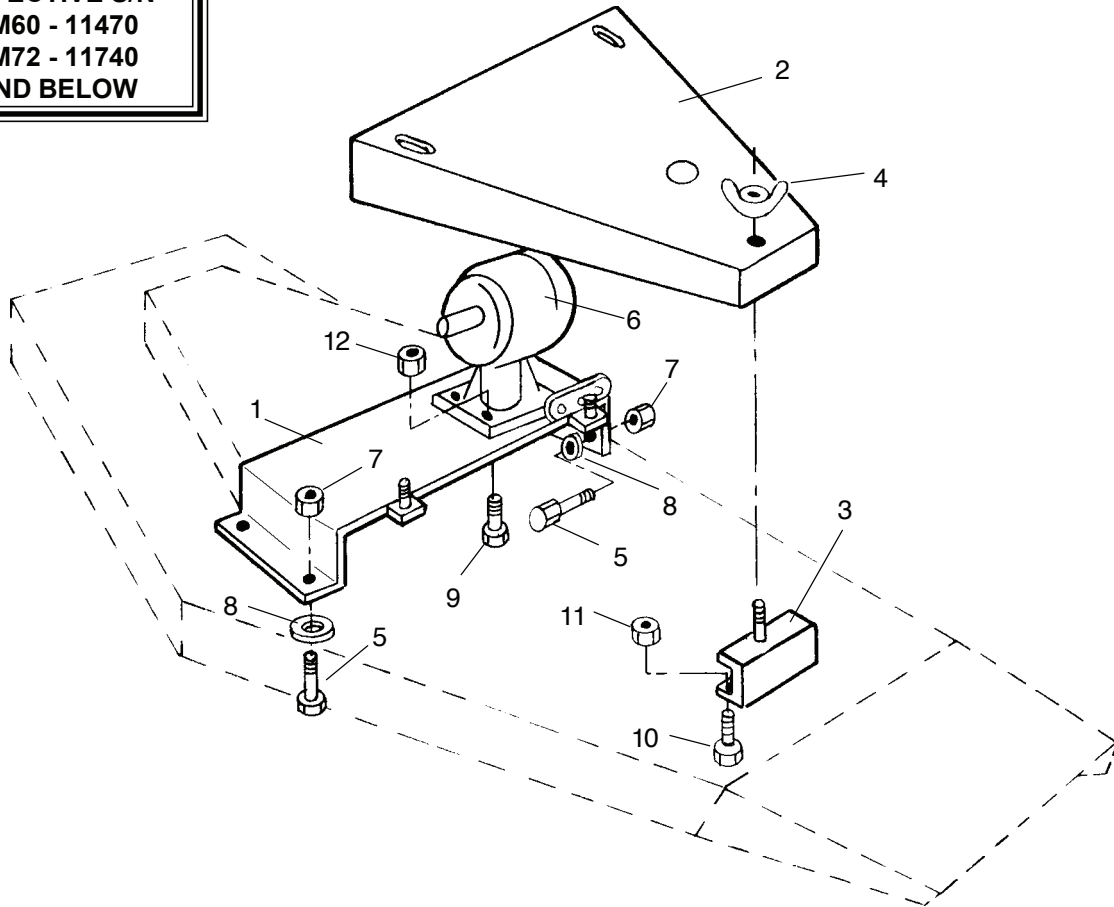

ITEM	PART NO.	QTY	DESCRIPTION
1	00762029	1	Gearbox Mount Wldmt FM72
	00762014	1	Gearbox Mount Wldmt FM60
2	00761710	2	Shield FM72
	00761942	2	Shield FM60
3	00761713	2	Brkt, - Shield
4	5F6160	6	Nut - Wing
5	00748823	4	Bolt
6	00763623	1	Gearbox
7	00001800	4	Locknut TLM 1/2 NC PLC
8	00002700	4	Flatwasher
9	00008300	4	Bolt
10	00011400	4	Bolt
11	00015800	4	Locknut
12	00695100	4	Nut, Toplock 5/8 NC PLC

# BLADE AND SPINDLE ASSEMBLY

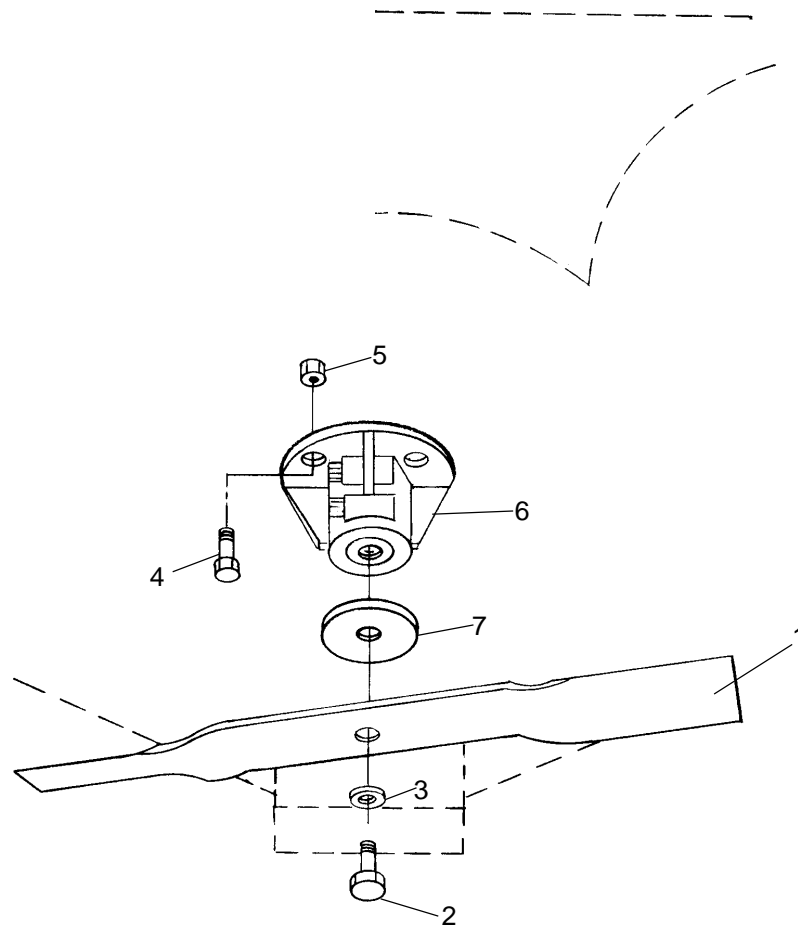

*TORQUE BLADE BOLT (LEFT HAND  
THREADS) TO 85 FT./LBS.*

## **DANGER**



Use only genuine **RHINO BLADES**.  
Use of inferior Blades may cause  
serious injury or death.

ITEM	PART NO.	QTY.	DESCRIPTION
1	00761712	3	Blades - FM60
	00761711	3	Blades - FM72
2	4815	3	Blade Bolt
3	4816	3	Washer
4	00753642	12	Bolt - Spindle Attachment
5	00015800	12	Nut - Spindle Attachment
6	00759702	3	Spindle & Housing Assembly
7	00759716	3	Seal Protector

# SPINDLE & HOUSING ASSEMBLY

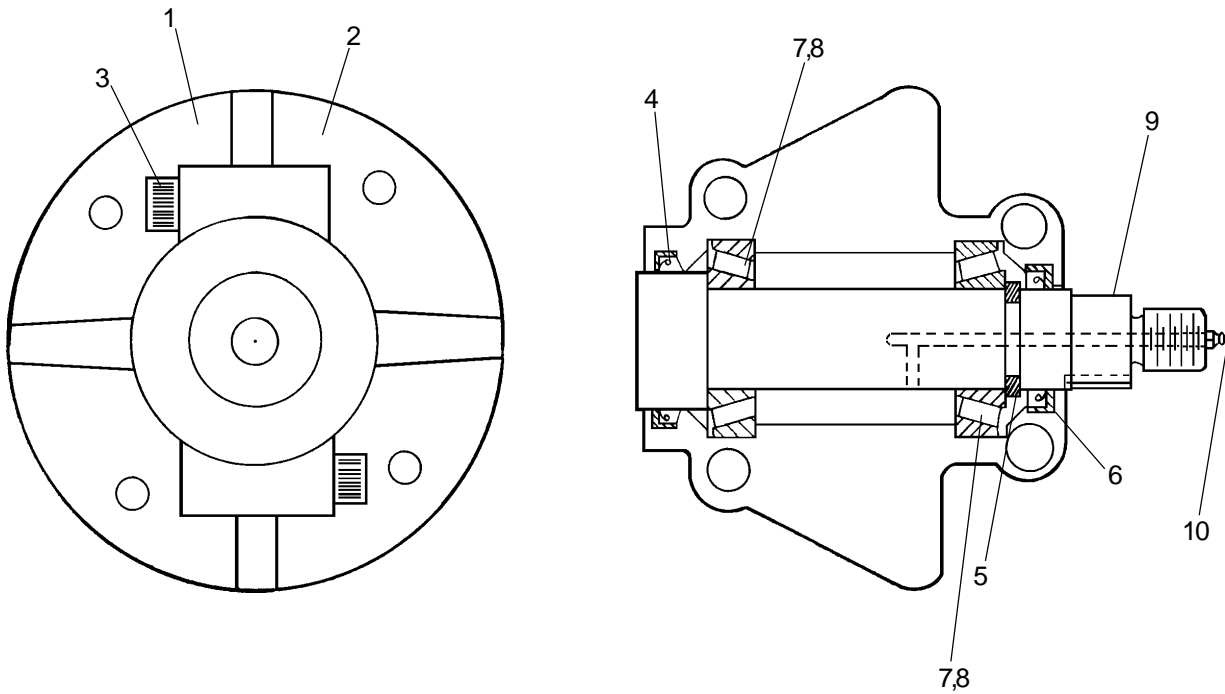

ITEM	PART NO.	QTY	DESCRIPTION
	<b>00759702</b>	-	<b>Spindle &amp; Housing Assy</b>
1	00760702	1	Casting Half (with Vent)
2	00760703	1	Casting Half (Standard)(Not Shown)
3	4812	4	Bolt
4	00760704	1	Seal
5	4814	2	Retaining Ring
6	5020	2	Seal
7	5019	2	Bearing Cup
8	00013701	2	Bearing Cone
9	00760701	1	Shaft
10	4351	1	Grease Fitting

# ROLLER - FRONT (EXTRA EQUIPMENT)

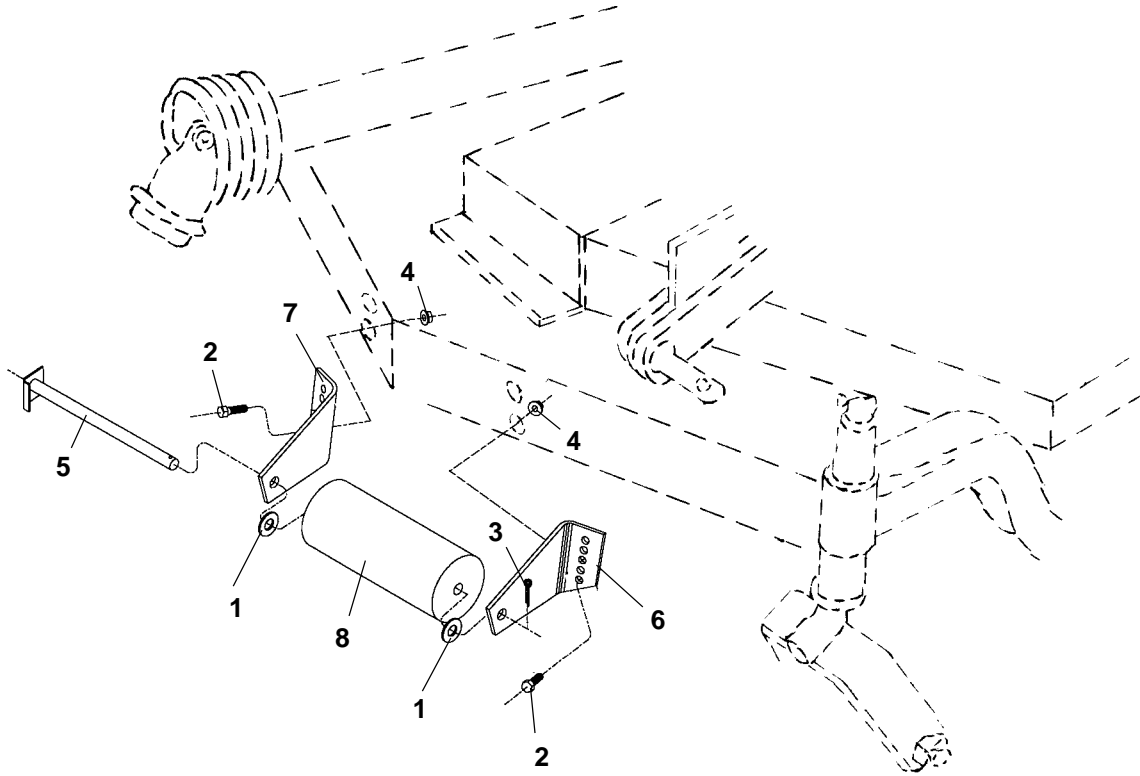

ITEM	PART NO	QTY	DESCRIPTION
1	00001400	2	Flatwasher
2	00753642	4	Bolt
3	00755153	1	Pin - Cotter
4	4528	4	Locknut
5	4860	1	Axle Weldment
6	00764795	1	Bracket, LH Roller
7	00764794	1	Bracket, RH Roller
8	4909	1	Roller - Front



# CASTER WHEEL ASSEMBLY

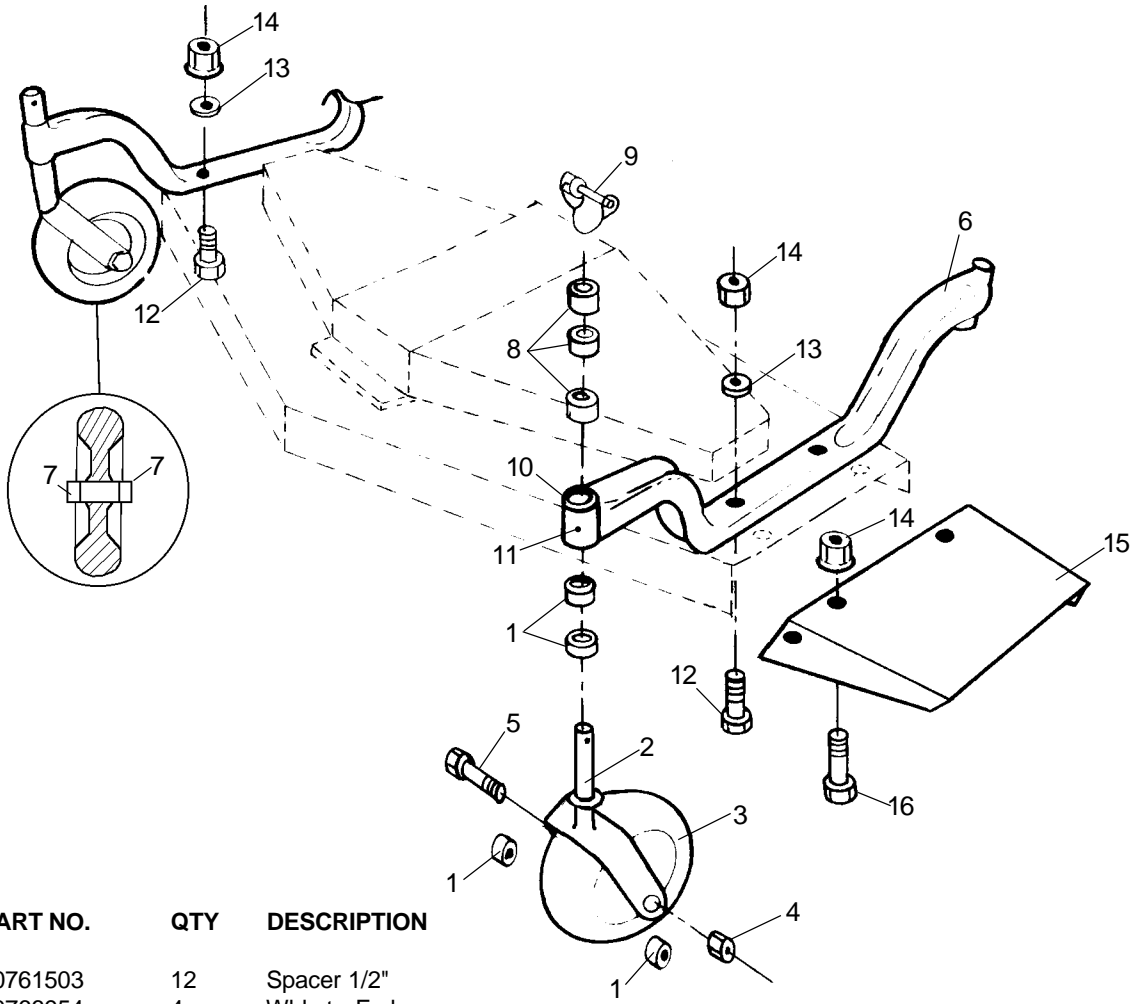

ITEM	PART NO.	QTY	DESCRIPTION
1	00761503	12	Spacer 1/2"
2	00766954	4	Wldmt - Fork
3	00769862	4	Assy - Tire / Wheel Compl. w/Bushings (#11471-FM60 and #11741-FM72 and Above)
	00761730	4	Assy - Tire / Wheel Compl. w/Bushings (#11470-FM60 and #11740-FM72 and Prior)
	00763662	4	Assy - Optional, Pneumatic Tire/Wheel Compl. w/Bearings
4	02030300	4	Nut Top Lock
5	7556	4	Bolt
6	00761736	2	Wldmt - Axle Arm - FM60 (Serial #11470 and Prior)
	00761725	2	Wldmt - Axle Arm - FM60 (Serial #11471 and Above)
	00761725	2	Wldmt - Axle Arm - FM72 (Serial #11740 and Prior)
	00763282	2	Wldmt - Axle Arm - FM72 (Serial #11741 through #12657)
	00767636	2	Wldmt - Axle Arm - FM72 (Serial #12658 & Above)
7	5459	8	Flanged Bearing (Used with 00761730 wheel)
	00767637	8	Flanged Bearing (Used with 00769862 wheel)
8	00761504	16	Spacer 1" Lg.
9	4805	4	Pin, Snapper
10	00761453	8	Bearing Flange
11	4720	4	Grease Fitting
12	00059900	4	Bolt
13	00761961	4	Washers
14	4528	8	Nuts
15	00769447	1	Discharge Chute - FM60 (Serial #11471 and Above)
	00761733	1	Discharge Chute - FM60 (Serial #11470 and Prior)
	00769534	1	Discharge Chute - FM72 (Serial #11741 and Above)
	00761720	1	Discharge Chute - FM72 (Serial #11740 and Prior)
16	00002000	4	Bolt

# BELT ASSEMBLY 60"

EFFECTIVE S/N  
FM60 - 11471  
AND ABOVE

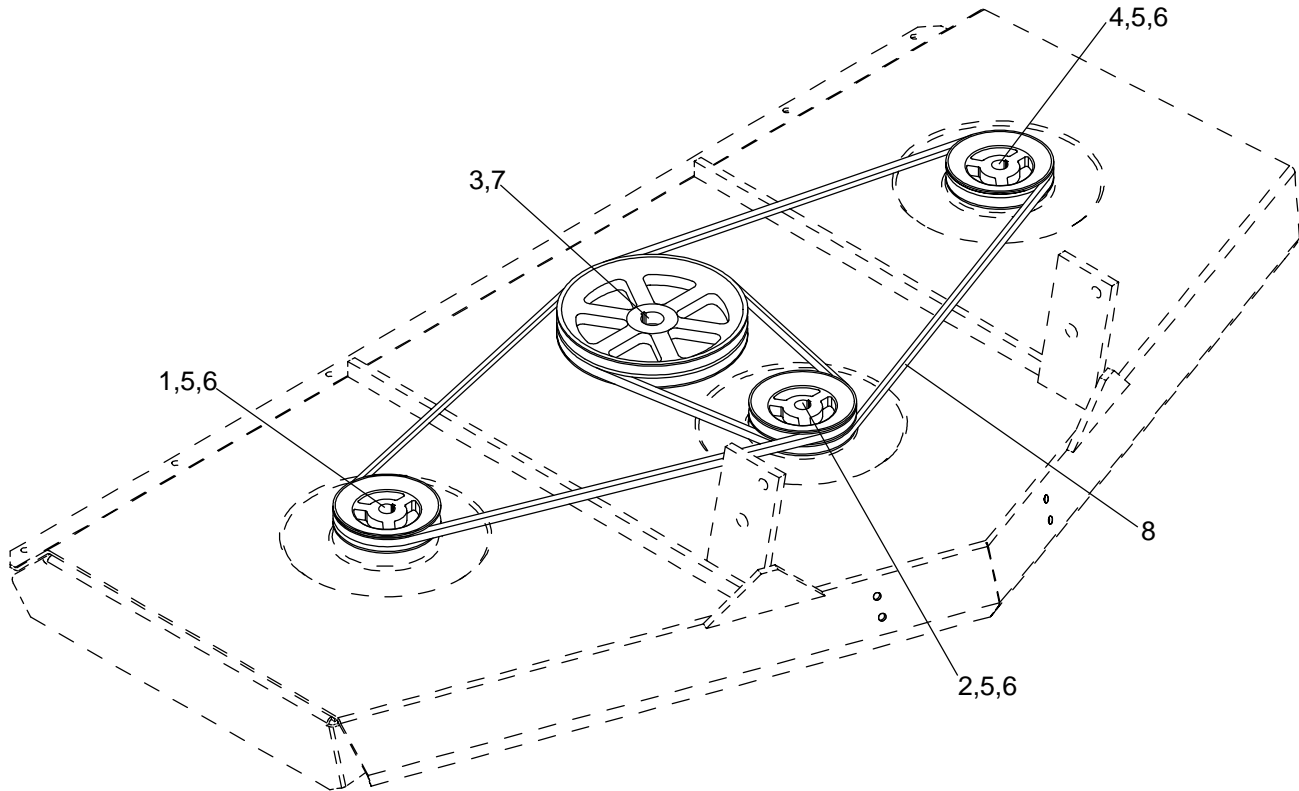

ITEM	PART NO.	QTY	DESCRIPTION
1	00769419	1	Sheave, Upper 4-1/2 OD
2	00769418	1	Sheave, 2 Groove Center 4-1/2 OD
3	00769865	1	Sheave, Main, 2 Groove
4	4824	1	Sheave, Lower, 4-1/2 OD
5	4904	3	Locknut
6	00765404	3	Key
7	00765813	1	Key
8	00769417	1	Belt (matched set of 2)

# BELT ASSEMBLY 60"

EFFECTIVE S/N  
FM60 - 11470  
AND BELOW

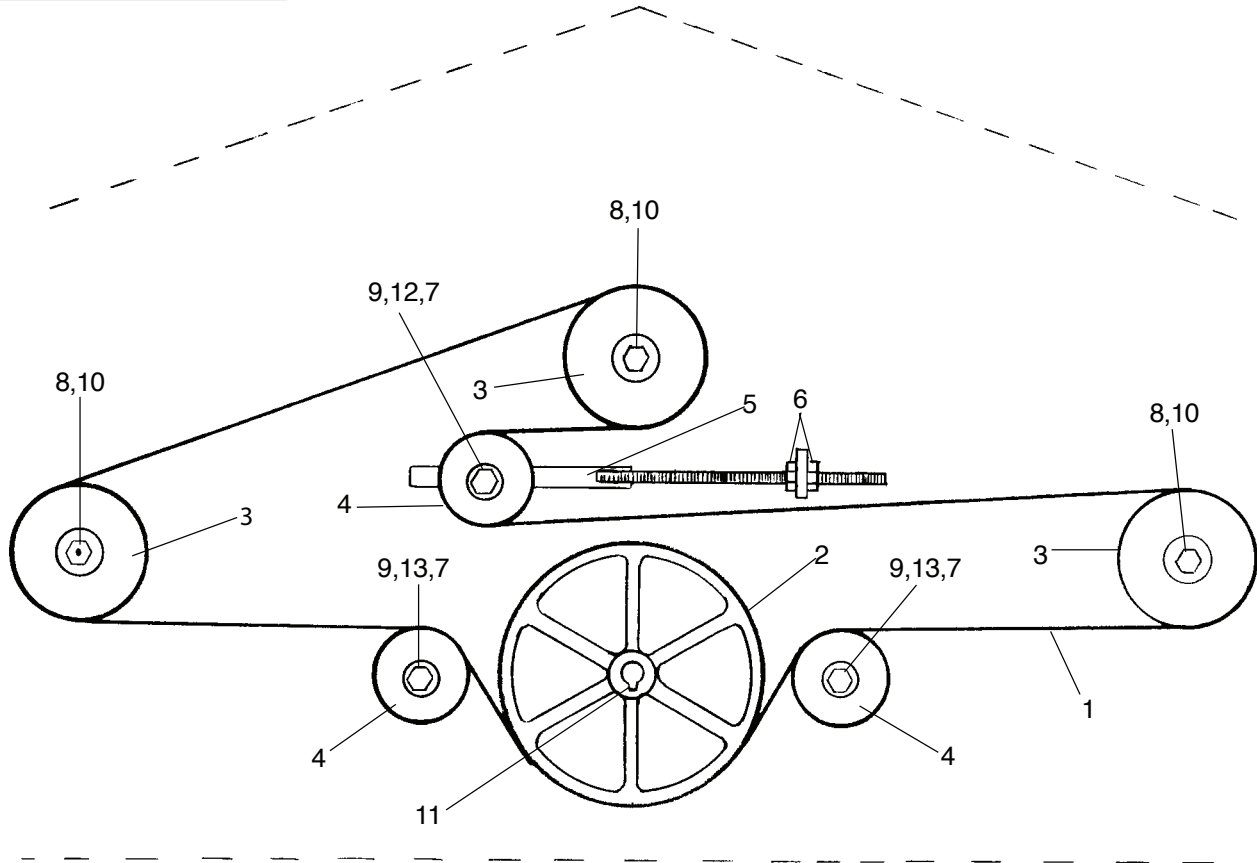

ITEM	PART NO.	QTY	DESCRIPTION
1	5161	1	Belt
2	4807	1	Sheave
3	4824	3	Sheave 4-1/2 OD
4	4808	3	Pulley
5	4822	1	Wldmt. - Idler Tightener
6	00013901	2	Nut
7	00695100	3	Nut, Toplock 5/8 NC PLC
8	4904	3	Nut
9	00762035	3	Spacer, Idler
10	00765404	3	Key - Heat Threaded
11	9097	1	Key
12	03200925	1	Carriage Bolt
13	02845600	2	Bolt

# BELT ASSEMBLY 72"

EFFECTIVE S/N  
FM72 - 11741  
AND ABOVE

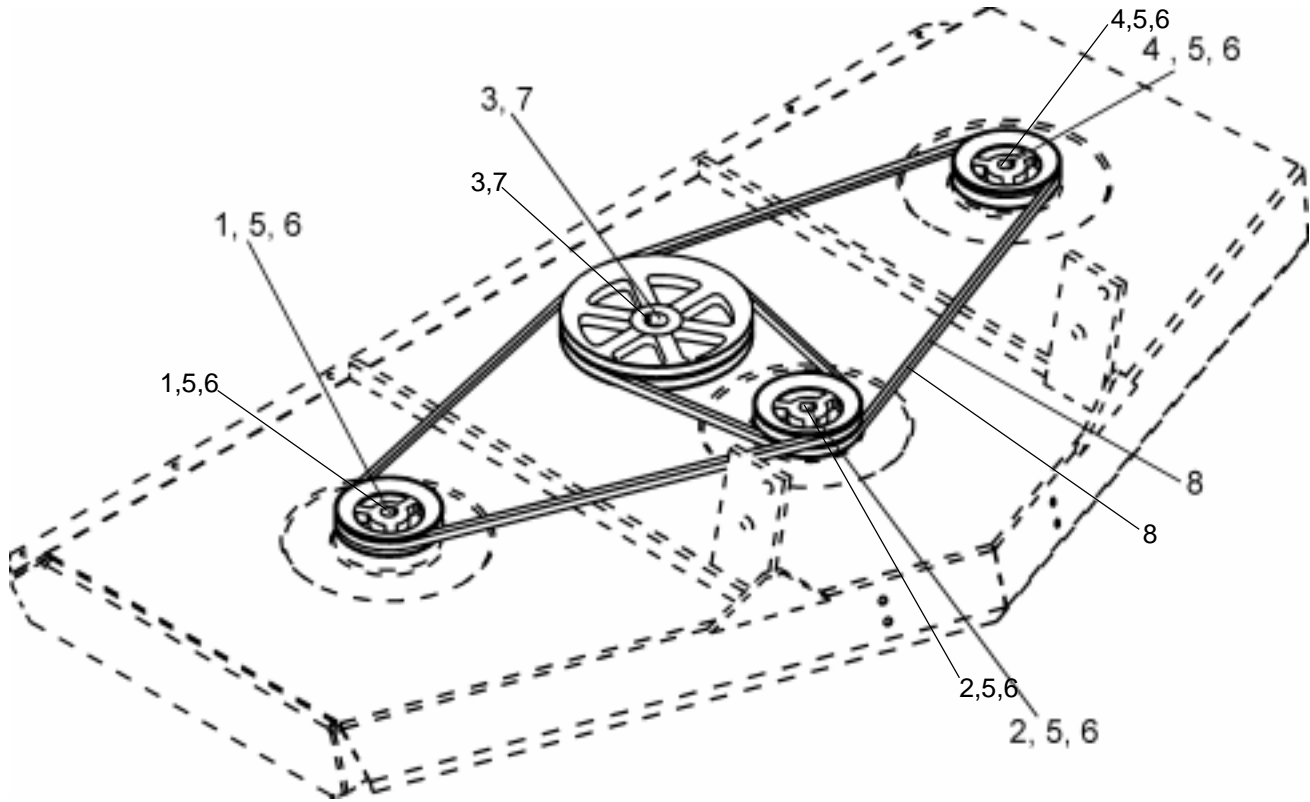

ITEM	PART NO.	QTY	DESCRIPTION
1	00769415	1	Sheave, Upper 5-3/4 OD, Single Groove
2	00763289	1	Sheave, 2 Groove Center, 5-3/4 OD
3	00769865	1	Sheave, 2 Groove, 10 3/16 OD
4	00762071	1	Sheave, Lower 5-3/4 OD, Single Groove
5	4904	3	Locknut
6	00765404	3	Key
7	00765813	1	Key
8	00765482	1	Belt (matched set of 2)

# BELT ASSEMBLY 72"

**EFFECTIVE S/N  
FM72 - 11740  
AND BELOW**

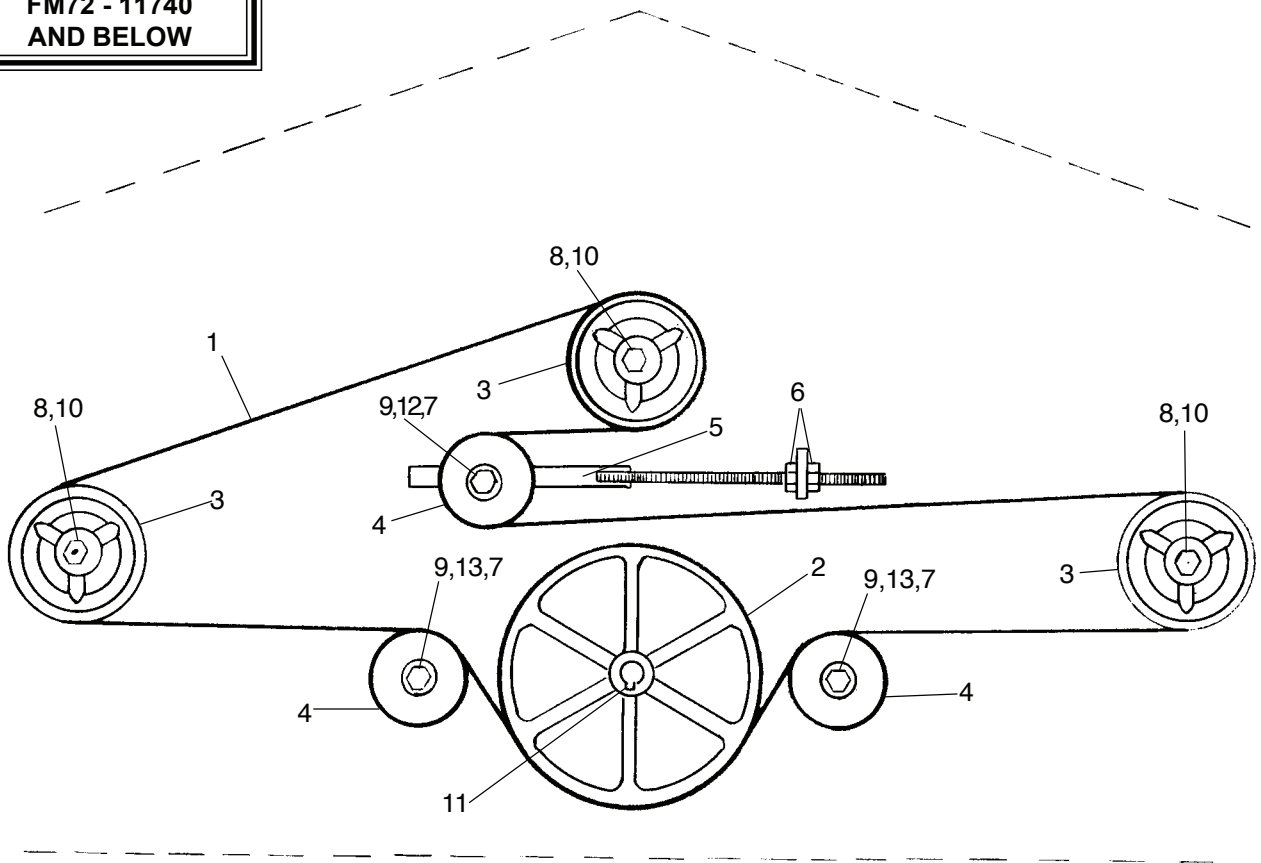

ITEM	PARTS NO.	QTY	DESCRIPTION
1	00762072	1	Belt
2	4807	1	Sheave
3	00762071	3	Sheave 5-3/4 OD Single Groove
4	4808	3	Pulley
5	4822	1	Wldmt. - Idler Tightener
6	00013901	2	Nut
7	00695100	3	Nut, Toplock 5/8 NC PLC
8	4904	3	Nut
9	00762035	3	Spacer, Idler
10	00765404	3	Key - Heat Treated
11	9097	1	Key
12	03200925	1	Carriage Bolt
13	02845600	2	Bolt

# ALAMO INDUSTRIAL

## LIMITED WARRANTY

### 1. LIMITED WARRANTIES

- 1.01. Alamo Industrial warrants for one year from the purchase date to the original non-commercial, governmental, or municipal purchaser ("Purchaser") and warrants for six months to the original commercial or industrial purchaser ("Purchaser") that the goods purchased are free from defects in material or workmanship.
- 1.02. Manufacturer will replace for the Purchaser any part or parts found, upon examination at one of its factories, to be defective under normal use and service due to defects in material or workmanship.
- 1.03. This limited warranty does not apply to any part of the goods which has been subjected to improper or abnormal use, negligence, alteration, modification, or accident, damaged due to lack of maintenance or use of wrong fuel, oil, or lubricants, or which has served its normal life. This limited warranty does not apply to any part of any internal combustion engine, or expendable items such as blades, shields, guards, or pneumatic tires except as specifically found in your Operator's Manual.
- 1.04. Except as provided herein, no employee, agent, Dealer, or other person is authorized to give any warranties of any nature on behalf of Manufacturer.

### 2. REMEDIES AND PROCEDURES.

- 2.01. This limited warranty is not effective unless the Purchaser returns the Registration and Warranty Form to Manufacturer within 30 days of purchase.
- 2.02. Purchaser claims must be made in writing to the Authorized Dealer ("Dealer") from whom Purchaser purchased the goods or an approved Authorized Dealer ("Dealer") within 30 days after Purchaser learns of the facts on which the claim is based.
- 2.03. Purchaser is responsible for returning the goods in question to the Dealer.
- 2.04. If after examining the goods and/or parts in question, Manufacturer finds them to be defective under normal use and service due to defects in material or workmanship, Manufacturer will:
  - (a) Repair or replace the defective goods or part(s) or
  - (b) Reimburse Purchaser for the cost of the part(s) and reasonable labor charges (as determined by Manufacturer) if Purchaser paid for the repair and/or replacement prior to the final determination of applicability of the warranty by Manufacturer.The choice of remedy shall belong to Manufacturer.
- 2.05. Purchaser is responsible for any labor charges exceeding a reasonable amount as determined by Manufacturer and for returning the goods to the Dealer, whether or not the claim is approved. Purchaser is responsible for the transportation cost for the goods or part(s) from the Dealer to the designated factory.

### 3. LIMITATION OF LIABILITY.

- 3.01. MANUFACTURER DISCLAIMS ANY EXPRESS (EXCEPT AS SET FORTH HEREIN) AND IMPLIED WARRANTIES WITH RESPECT TO THE GOODS INCLUDING, BUT NOT LIMITED TO, MERCHANTABILITY AND FITNESS FOR A PARTICULAR PURPOSE.
- 3.02. MANUFACTURER MAKES NO WARRANTY AS TO THE DESIGN, CAPABILITY, CAPACITY, OR SUITABILITY FOR USE OF THE GOODS.
- 3.03. EXCEPT AS PROVIDED HEREIN, MANUFACTURER SHALL HAVE NO LIABILITY OR RESPONSIBILITY TO PURCHASER OR ANY OTHER PERSON OR ENTITY WITH RESPECT TO ANY LIABILITY, LOSS, OR DAMAGE CAUSED OR ALLEGED TO BE CAUSED DIRECTLY OR INDIRECTLY BY THE GOODS INCLUDING, BUT NOT LIMITED TO, ANY INDIRECT, SPECIAL, CONSEQUENTIAL, OR INCIDENTAL DAMAGES RESULTING FROM THE USE OR OPERATION OF THE GOODS OR ANY BREACH OF THIS WARRANTY. NOT WITHSTANDING THE ABOVE LIMITATIONS AND WARRANTIES, MANUFACTURER'S LIABILITY HEREUNDER FOR DAMAGES INCURRED BY PURCHASER OR OTHERS SHALL NOT EXCEED THE PRICE OF THE GOODS.
- 3.04. NO ACTION ARISING OUT OF ANY CLAIMED BREACH OF THIS WARRANTY OR TRANSACTIONS UNDER THIS WARRANTY MAY BE BROUGHT MORE THAN TWO (2) YEARS AFTER THE CAUSE OF ACTION HAS OCCURRED.

### 4. MISCELLANEOUS.

- 4.01. Proper Venue for any lawsuits arising from or related to this limited warranty shall be only in Guadalupe County, Texas.
- 4.02. Manufacturer may waive compliance with any of the terms of this limited warranty, but no waiver of any terms shall be deemed to be a waiver of any other term.
- 4.03. If any provision of this limited warranty shall violate any applicable law and is held to be unenforceable, then the invalidity of such provision shall not invalidate any other provisions herein.
- 4.04. Applicable law may provide rights and benefits to purchaser in addition to those provided herein.

### KEEP FOR YOUR RECORDS

ATTENTION: Purchaser should fill in the blanks below for his reference when buying repair parts and/or for proper machine identification when applying for warranty.

Alamo Industrial Implement Model \_\_\_\_\_ Serial Number \_\_\_\_\_

Date Purchased \_\_\_\_\_ Dealer \_\_\_\_\_

ATTENTION:  
READ YOUR OPERATOR'S MANUAL

**ALAMO INDUSTRIAL**

An Alamo Group Company  
Post Office Drawer 549  
Seguin, Texas 78156  
830-379-1480





## TO THE OWNER/OPERATOR/DEALER

To keep your implement running efficiently and safely, read your manual thoroughly and follow these directions and the Safety Messages in this Manual. The Table of Contents clearly identifies each section where you can easily find the information you need.

The OCCUPATIONAL SAFETY AND HEALTH ACT (1928.51 Subpart C) makes these minimum safety requirements of tractor operators:

### REQUIRED OF THE OWNER:

1. Provide a Roll-Over-Protective Structure that meets the requirements of this Standard; and
2. Provide Seatbelts that meet the requirements of this paragraph of this Standard and SAE J4C; and
3. Ensure that each employee uses such Seatbelt while the tractor is moving; and
4. Ensure that each employee tightens the Seatbelt sufficiently to confine the employee to the protected area provided by the ROPS.

### REQUIRED OF THE OPERATOR

1. Securely fasten seatbelt if the tractor has a ROPS.
2. Where possible, avoid operating the tractor near ditches, embankments, and holes.
3. Reduce speed when turning, crossing slopes, and on rough, slick, or muddy surfaces.
4. Stay off slopes too steep for safe operation.
5. Watch where you are going - especially at row ends, on roads, and around trees.
6. Do not permit others to ride.
7. Operate the tractor smoothly - no jerky turns, starts, or stops.
8. Hitch only to the drawbar and hitch points recommended by the tractor manufacturer.
9. When the tractor is stopped, set brakes securely and use park lock, if available.

- 
- Keep children away from danger all day, every day...**
  - Equip tractors with rollover protection (ROPS) and keep all machinery guards in place...**
  - Please work, drive, play and live each day with care and concern for your safety and that of your family and fellow citizens.**

