



LANDSCRAPER

66 / 72 / 78 / 84

Rev 03-13

P/N 00766665

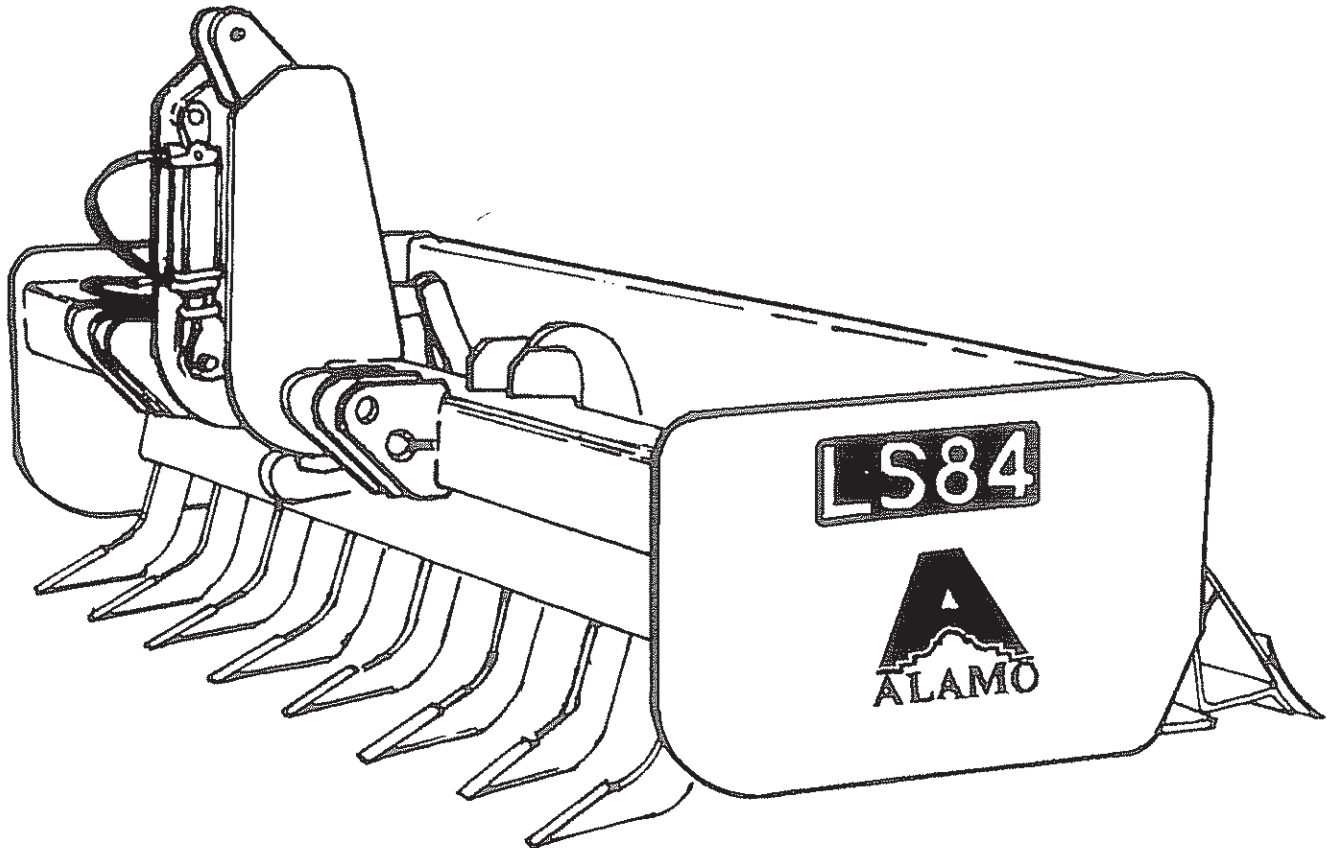

ALAMO INDUSTRIAL
1502 E. Walnut
Seguin, Texas 78155
830-372-9595



© 2013 Alamo Group, Inc.

An Alamo Group Company

To the Owner/Operator/Dealer

Your new Alamo Implement has been carefully designed and thoroughly field tested to give years of trouble free operation. To keep your implement running efficiently and safely, read your manual thoroughly and follow these directions and safety messages. The Table of Contents clearly identifies each section where you can easily find the information you need.



SMV EMBLEM

Always display this emblem on the rear of your vehicle, in an area clearly visible to oncoming vehicles, before operating or moving on or about highways. This could save your life and/or lives of others.

WARNING

TO AVOID SERIOUS INJURY OR DEATH:

1. READ AND UNDERSTAND OPERATOR'S MANUAL.
2. TRACTOR MUST BE EQUIPPED WITH ROLL-OVER PROTECTION (ROPS) AND SWAY CHAINS.
3. ALWAYS WEAR SAFETY GLASSES, SAFETY SHOES, AND SEAT BELT FASTENED TIGHTLY.
4. STOP TRACTOR, LOCK BRAKES, AND BLOCK UP OR SUPPORT IMPLEMENT SECURELY BEFORE WORKING UNDER RAISED COMPONENTS.
5. ALLOW NO RIDERS AT ANY TIME ON TRACTOR OR IMPLEMENT. FALLING OFF CAN KILL.
6. KEEP BYSTANDERS CLEAR OF MOVING PARTS AND WORKING AREA. KEEP CHILDREN AWAY!
7. DO NOT LIFT, LOWER, OR OPERATE UNLESS EVERYONE IS CLEAR OF IMPLEMENT.
8. USE INCREASED CAUTION ON SLOPES & NEAR BANKS AND DITCHES TO PREVENT OVERTURN.
9. LOCK LIFT LEVER UP FOR TRANSPORT. HAVE SMV SIGN VISIBLE. FOLLOW LOCAL LAWS.
10. USE PARKING STAND OR BLOCK UP WHEN UNHITCHING FROM TRACTOR.

HAZARD DECALS

NOTICE: The Caution, Warning and Danger decals affixed to your unit should be retained and protected. If they are destroyed by wear or repainting, new ones will be supplied by Alamo upon request.



SAFETY ALERT SYMBOL:

This symbol will be shown throughout your manual to indicate special safety messages. Read these messages carefully to become aware of the potential hazards and/or property damage.

STATEMENT OF POLICY

It is the policy of Alamo to improve its products where it is possible and practical to do so. Alamo reserves the right to make changes or improvements in design and construction at any time without incurring the obligation to make these changes on previously manufactured units.

ORDERING REPAIR PARTS AND ACCESSORIES

When ordering repair parts or accessories from your Alamo dealer, use the model and serial number shown on the Serial Number Plate.

WARRANTY INFORMATION

Read and understand the complete warranty statement found on the Warranty Card with your manual. Fill out the "Warranty Card" in full and return to Alamo within 30 days. Make certain the serial number is recorded on the Warranty Card and on your Warranty Sheet that you retain.

TABLE OF CONTENTS

SAFETY SECTION

Safety Information	1-2
Safety Decal Location	1-4
Safety Decal Information	1-5

INTRODUCTION SECTION	2-1
-----------------------------------	------------

ASSEMBLY SECTION

Frame Assembly	3-2
Scarifier Assembly	3-3
Blade Assembly	3-3

OPERATION SECTION

Attachment	4-2
Operating	4-2
Transporting	4-2
Detaching and Storage	4-2

MAINTENANCE SECTION

Replacing Scarifier Points	5-2
Torque Chart	5-2
Lubrication Information	5-3

PARTS SECTION	6-1
----------------------------	------------

SAFETY SECTION

SAFETY

DANGER!



There are obvious and hidden potential hazards in the operation of this implement. **REMEMBER!** Serious injury or even death may occur unless care is taken to insure the safety of the operator, bystanders, or passersby in the area.

KEEP CLEAR!

Included here is a list of Safety Messages which should be followed. Serious injury or death may occur unless care is taken to follow these Safety Messages and use good common sense in avoiding hazards.

DANGER!



The operator and all support personnel should wear "hard hats", "safety shoes", and "safety glasses" at all times for personal protection from injury.

DANGER!



Operate the LANDSCRAPER only with a tractor equipped with an approved roll-over-protective system(ROPS). Always wear your seat belt. Serious injury or even death could result from falling off the tractor---particularly during a turnover when the operator could be pinned under the ROPS or the Tractor.

DANGER!



Before leaving the tractor seat, always engage the brake and /or set the tractor transmission in parking gear. Stop the engine, and remove the key. Lower the LANDSCRAPER to the ground and support on blocks. Operate the tractor controls from the tractor seat only.

DANGER!



Be particularly careful in transport. Turn curves or go up hills only at a low speed and at a gradual steering angle. Make certain that at least 20% of the tractor's weight is on the front wheels to maintain safe steerage. Slow down on rough or uneven surfaces.

WARNING!



Make certain that the "Slow Moving Vehicle"(SMV) Sign is installed in such a way as to be clearly visible, and legible. Use flashing warning lights and follow all local traffic regulations. Do not transport unless lift lever is fully raised and in transport latched position. Dropping in transport can cause serious damage to the tractor and/or LANDSCRAPER and possibly cause the operator to be injured or killed.

DANGER!



Inspect the entire machine periodically as indicated in the Maintenance Section of this manual. Look for loose fasteners, worn or broken parts. Make sure all pins have cotter pins and washers. Serious injury may occur from not maintaining this machine in good working order.

DANGER!



Do not mount the tractor while the tractor is moving. Mount the tractor only when it is completely stopped.

SAFETY

DANGER! Never allow riders on either tractor or LANDSCRAPER. Falling off can kill.



DANGER! Never allow children to operate or ride on the tractor or implement.



DANGER! Never work under the LANDSCRAPER, the frame work, or any lifted component unless the implement is securely supported or blocked up. A sudden or inadvertent fall by any of these components could cause serious injury or even death.



WARNING! Never operate the tractor and LANDSCRAPER until you have read and completely understand this manual, the Tractor Operator's Manual, and each of the Safety Messages found on the decals on the tractor and implement.



WARNING! Always maintain the safety decals in good, readable condition. If the decals become damaged or unreadable, order replacement decals immediately.



WARNING! In addition to the design and configuration of this implement, including Safety Signs and Safety Equipment, hazard control and accident prevention are dependent upon the awareness, concern, prudence, and proper training of personnel involved in the operation, transport, maintenance, and storage of the machine. Refer also to Safety Messages and operation instruction in each of the appropriate sections of the Tractor and implement Manuals. Pay close attention to the Safety Signs affixed to the Tractor and the LANDSCRAPER.



SAFETY DECAL LOCATION

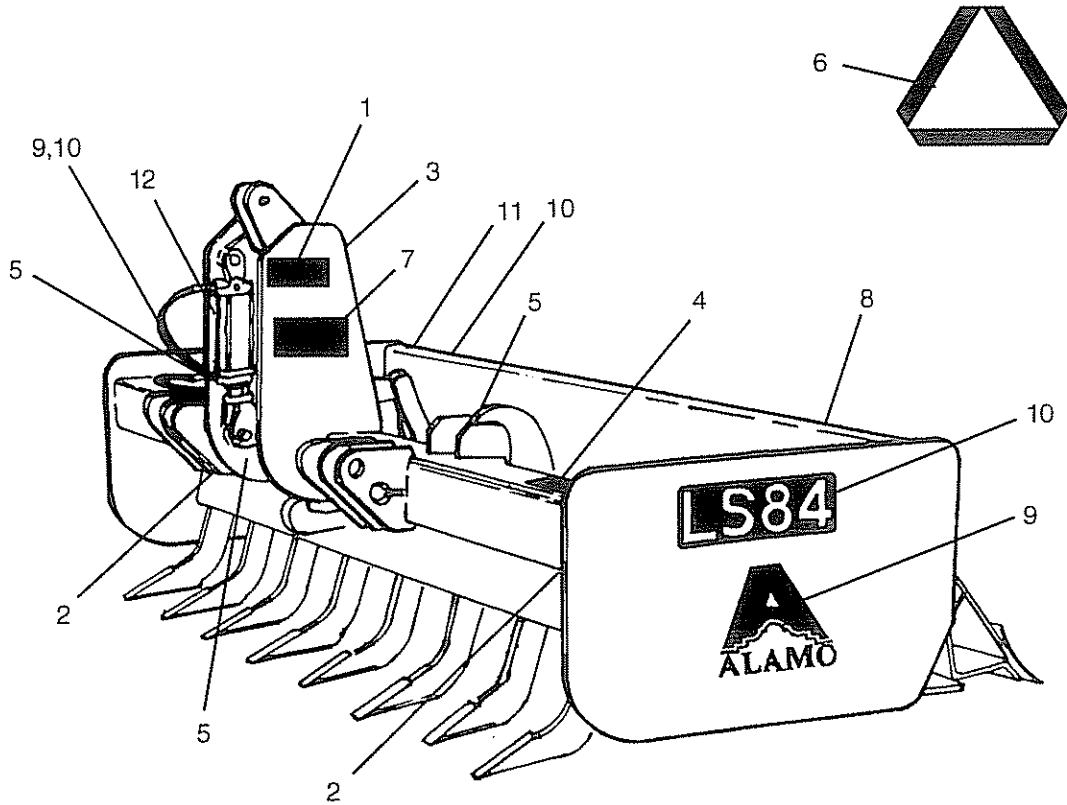

ITEM	PART NO.	QTY	TYPE	DECAL DESCRIPTION
1	00756059	1	WARNING	Oil Penetration
2	02962764	2	DANGER	Pinch Point
3	02962765	1	DANGER	Multiple Pinch Points
4	999200	1	WARNING	Multiple Hazard, Blades
5	000678	3	INSTRUC	Grease Fitting Inside
6	03200347	*	REFLCTR	SMV Reflector
7	02925100	1	IMPORTANT	Genuine Parts, Alamo
8	00757139	1	NAME	ALAMO (4.4 x 16.8)
9	001650	2	LOGO	ALAMO (7 x 11)
10	00766623	3	NAME	LS66
	00766624	3	NAME	LS72
	00766625	3	NAME	LS78
	00766626	3	NAME	LS84
11	00766627	1	NAME	LANDSCRAPER
12	NFS	1	SER PLT	ALAMO LS66
	NFS	1	SER PLT	ALAMO LS72
	NFS	1	SER PLT	ALAMO LS78
	NFS	1	SER PLT	ALAMO LS84

* Furnished by Tractor Manufacturer

SAFETY DECAL LOCATION

WARNING

TO AVOID SERIOUS INJURY OR DEATH:

1. READ AND UNDERSTAND OPERATOR'S MANUAL.
2. TRACTOR MUST BE EQUIPPED WITH ROLL-OVER PROTECTION (ROPS) AND SWAY CHAINS.
3. ALWAYS WEAR SAFETY GLASSES, SAFETY SHOES, AND SEAT BELT FASTENED TIGHTLY.
4. STOP TRACTOR, LOCK BRAKES, AND BLOCK UP OR SUPPORT IMPLEMENT SECURELY BEFORE WORKING UNDER RAISED COMPONENTS.
5. ALLOW NO RIDERS AT ANY TIME ON TRACTOR OR IMPLEMENT. FALLING OFF CAN KILL.
6. KEEP BYSTANDERS CLEAR OF MOVING PARTS AND WORKING AREA. KEEP CHILDREN AWAY!
7. DO NOT LIFT, LOWER, OR OPERATE UNLESS EVERYONE IS CLEAR OF IMPLEMENT.
8. USE INCREASED CAUTION ON SLOPES & NEAR BANKS AND DITCHES TO PREVENT OVERTURN.
9. LOCK LIFT LEVER UP FOR TRANSPORT. HAVE SMV SIGN VISIBLE. FOLLOW LOCAL LAWS.
10. USE PARKING STAND OR BLOCK UP WHEN UNHITCHING FROM TRACTOR.

(4) 999200 Multi-Hazard Decal

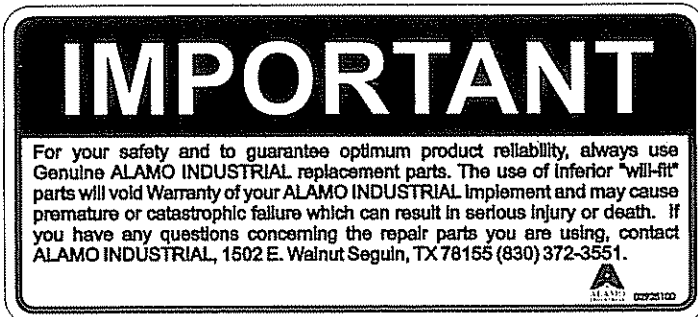

(7) 02925100 Genuine Parts



(5) 000678 Grease Fitting Inside

LANDSCRAPER

(11) 00766627 Name Decal



(9) 001650 Alamo Logo



(8) 00757139 Alamo Name

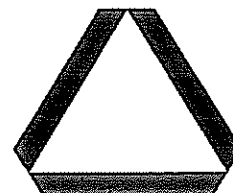

(6) 03200347 SMV Reflector

SAFETY DECAL LOCATION



(1) 00756059 Oil Penetration

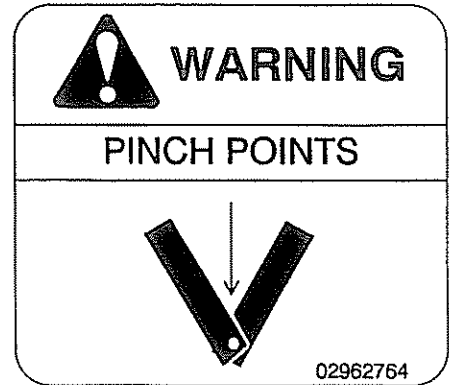

(2) 02962764 Pinch Point

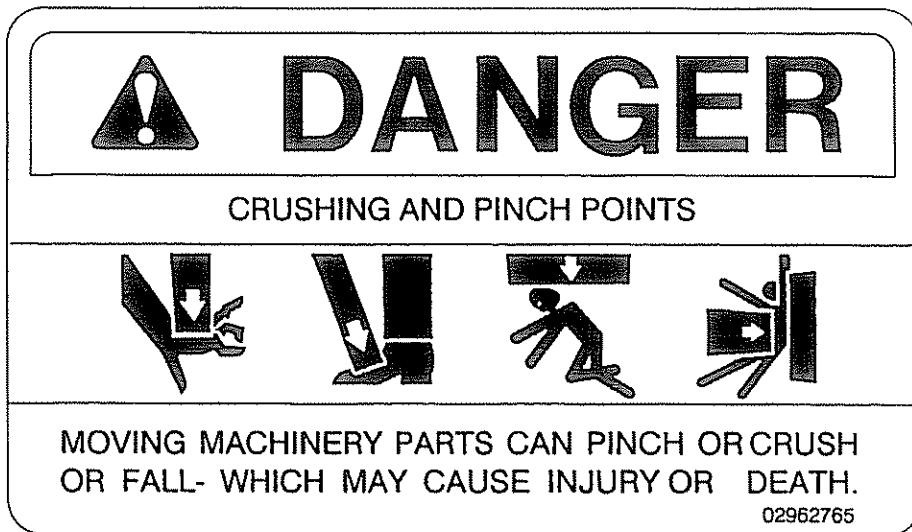

(3) 02962765 Multiple Pinch Point

LS 66

(10) 00766623 LS66

LS 72

(10) 00766624 LS72

LS 78

(10) 00766625 LS78

LS 84

(10) 00766626 LS84

INTRODUCTION SECTION

INTRODUCTION

This LANDSCRAPER is designed with care and built with quality materials by skilled workers. Proper assembly, maintenance, and operating practices, as described in this manual, will help the owner/operator get years of satisfactory service from the machine.

The purpose of this manual is to familiarize and instruct. The Assembly Section instructs the owner/operator in the correct assembly of the LANDSCRAPER using standard and optional equipment. The Parts Listing section is designed to familiarize the owner/operator with replaceable parts on the Blade. This section provides exploded assembly drawings of each LANDSCRAPER component illustrating each piece and the corresponding part number.

Careful use and timely service saves extensive repairs and costly downtime losses. The Operation and Maintenance Sections of the manual train the owner/operator how to work the LANDSCRAPER correctly and attend to appropriate maintenance. The Trouble Shooting Guide helps diagnose difficulties and offers solutions to the problems.

Safety is of primary importance to the owner/operator and to the manufacturer. The first section of this manual includes a list of Safety Messages, that, if followed, will help protect the operator and bystanders from injury or death. Many of the Safety Messages will be repeated throughout the manual. The owner/operator/dealer should know these Safety Messages before assembly and be aware of the hazards of operating the LANDSCRAPER during assembly, use, and maintenance. The Safety Alert Symbol combined with a Signal Word, as seen below, is intended to warn the owner/operator of impending hazards and the degree of possible injury faced when operating this machine.

CAUTION

The lowest level of Safety Message; warns of possible minor injury. Decals located on the Mower with this Signal Word are Black and Yellow.



WARNING

Serious injury or possible death! Decals are Black and Orange.



DANGER

Imminent death/critical injury. Decals are Red and White.



INTRODUCTION

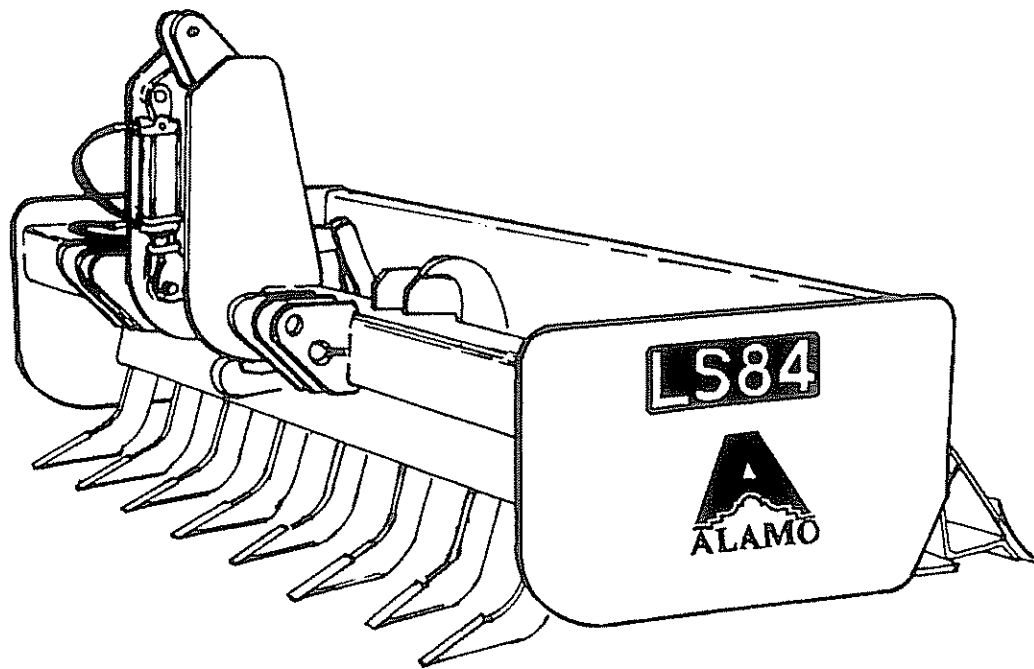

(Model LS84 Shown)

Your Alamo LANDSCRAPER is designed for soil moving, soil leveling and yard maintenance. With a reasonable amount of preventive maintenance, your LANDSCRAPER will provide years of dependable service.

WARNING



At least 20% of the tractor's total weight must be on the front tires with the Blade lifted to provide adequate traction for safe steering under good conditions. Slow down on hills, rough terrain, and curves.

Front and rear, and left and right are determined by the normal direction of travel (the same as on your automobile).

INTRODUCTION

ATTENTION OWNER/OPERATOR

BEFORE OPERATING THIS MACHINE:

1. Carefully read the Operator's Manual, completely understand the Safety Messages and instructions, and know how to operate correctly both the tractor and Blade.
2. Fill out the Warranty Card in full. Be sure to answer all questions, including the Serial Number of the Blade. Mail within 30 days of delivery date of this implement.

NOTE: *Warranties are honored only if completed "Owner Registration and Warranty" forms are received by Alamo Group within thirty days of delivery of the Blade.*

3. Record the Blade Model and Serial Numbers on the Warranty page at the front of the Operator's Manual. Keep this as part of the permanent maintenance file for the Blade.

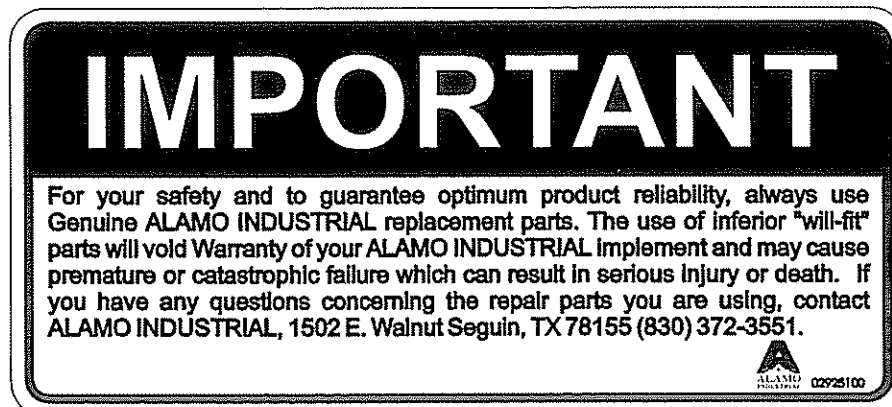

**ASSEMBLY
SECTION**

ASSEMBLY

SHANK HOLDER ATTACHMENT ASSEMBLY (FIGURE 1)

Attach shank holder (item 1) to the inside of the mainframe weldment (item 2) and attach with pins (item 3), fasten pins with 1/2" x 1" bolt (item 4) and 1/2" locknut (item 5).

CYLINDER ATTACHMENT ASSEMBLY (FIGURE 1)

Attach bottom of cylinder (item 8) to cylinder pivot weldment (item 6) with pin (item 9). Then attach opposite side of cylinder to mainframe (item 2) with pin (item 10). Attach cylinder pivot weldment (item 6) to mainframe with pin (item 7).

LINKAGE ATTACHMENT ASSEMBLY (FIGURE 1)

Attach cylinder pivot (item 6) to linkage arm (item 11) with pins (item 12) and flatwasher (item 13) and lock with cotter pins (item 14).

ACTUATOR ARM ATTACHMENT (FIGURE 1)

Attach actuator arm (item 15) to shank holder weldment (item 1) with 1/2" x 4" bolt (item 16) and 1/2" locknut (item 17).

LATCH ATTACHMENT ASSEMBLY (FIGURE 1)

Attach latch (item 18) with pin (item 19)

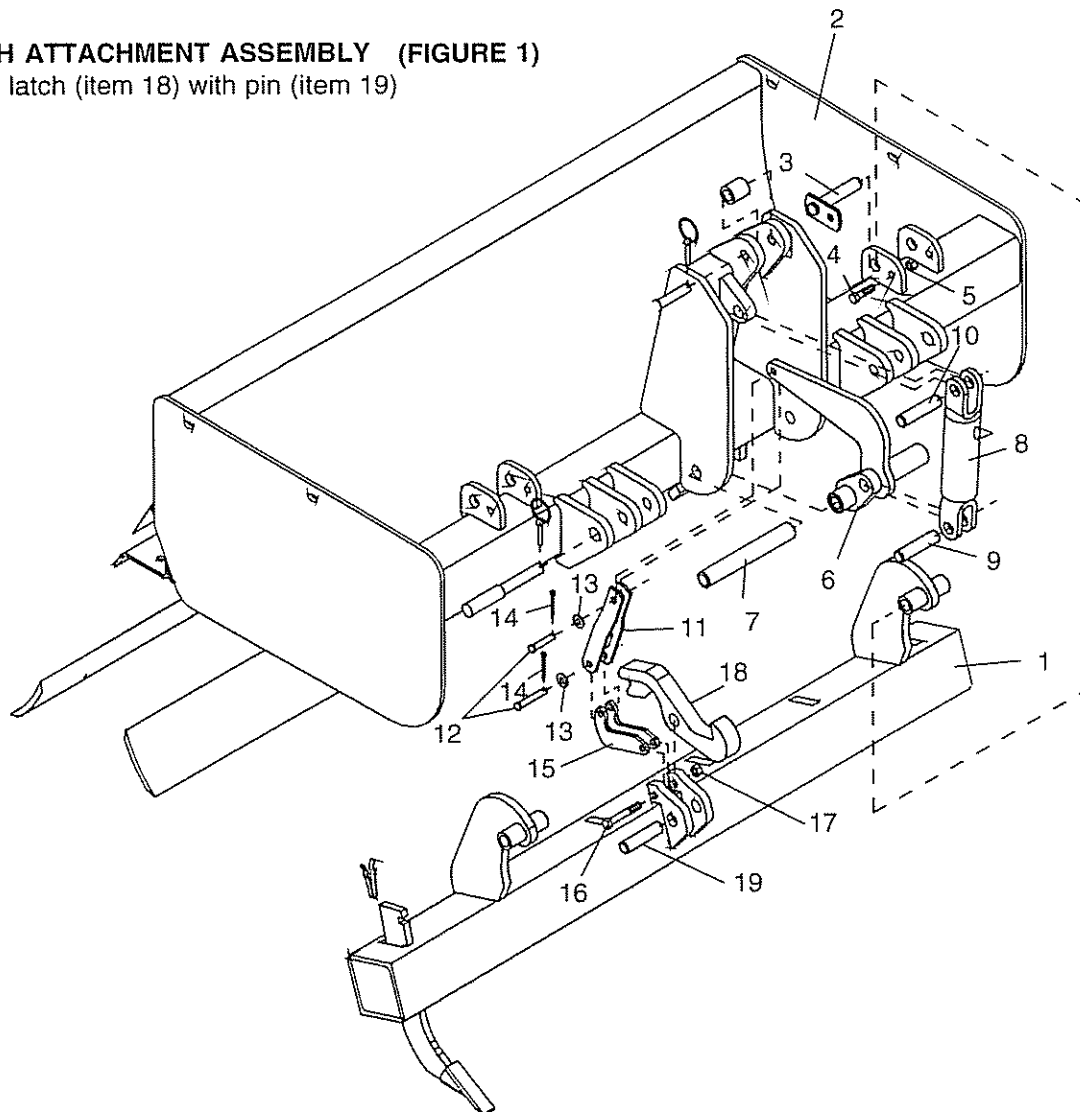

FIGURE 1 Frame Assembly

Assembly Section 3-2

ASSEMBLY

SCARIFIER ASSEMBLY (FIGURE 2)

Insert shank (item 1) through shank holder (item 2) upward to the required height and retain with shank keeper (item 3).

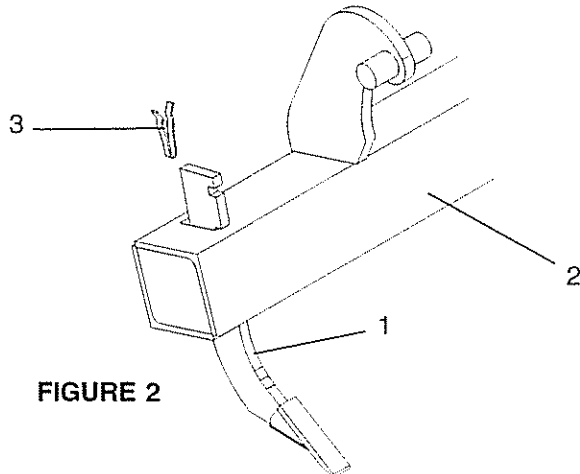

FIGURE 2

BACKFILL BLADE

Attach the two Cutting Edges (item 1) to the Mainframe Weldment with 16 - 5/8 x 2 plow bolts (item 3) and 16 - 5/8 locknuts (item 2). To Lock Moldboard in place fasten with 2 - 1/2 x 1-1/4 bolts (item 4) and 2 - 1/2 nuts (item 5). (FIGURE 3)

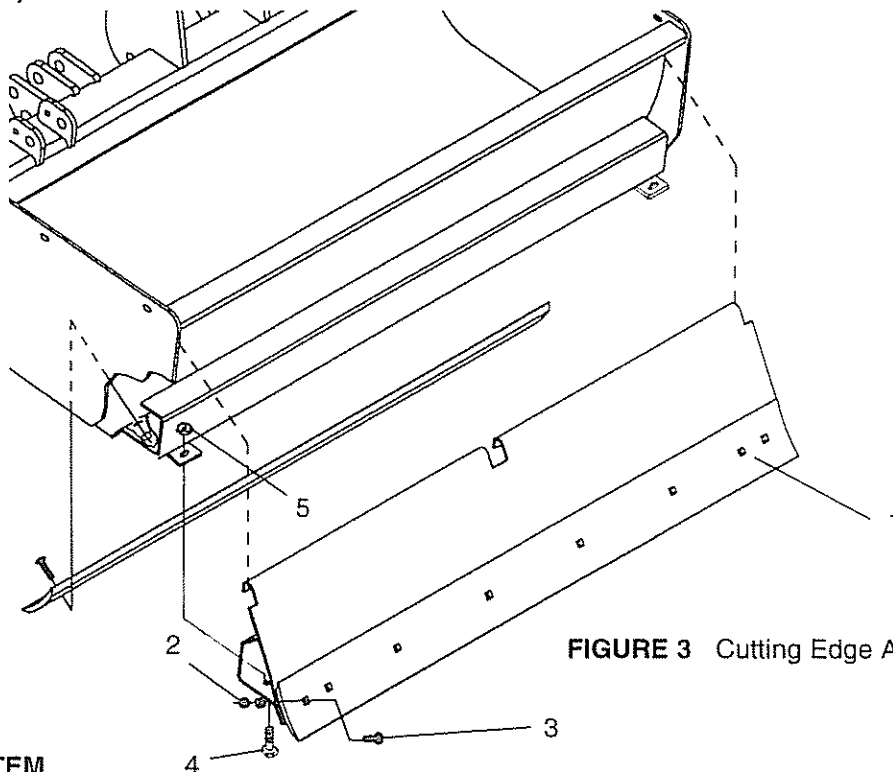

FIGURE 3 Cutting Edge Assembly

HYDRAULIC SYSTEM

Hose Connection

Attach the hoses with threaded ends to the cylinder on unit. Connect opposite end of hose with the quick disconnect to the tractor hydraulics. Hose from dead end side of cylinder should be connected to upper (pressure) coupler of tractor. Hose from live end of cylinder should connect to the lower (return) coupler of tractor.

OPERATION SECTION

OPERATION

ATTACHMENT

To attach the LANDSCRAPER, position the tractor so that the lower link hitch points are level with and slightly ahead of the LANDSCRAPER. Remove the Retaining Pins and Hitch Pins from the LANDSCRAPER. Back the tractor until the lower link hitch holes are align with the LANDSCRAPER hitch holes. Secure with Hitch Pins and Retaining Pins. Attach the top link to the lug on top of mainframe. Check Chains should be installed to control the lateral movement of the LANDSCRAPER. **Figure 1.**

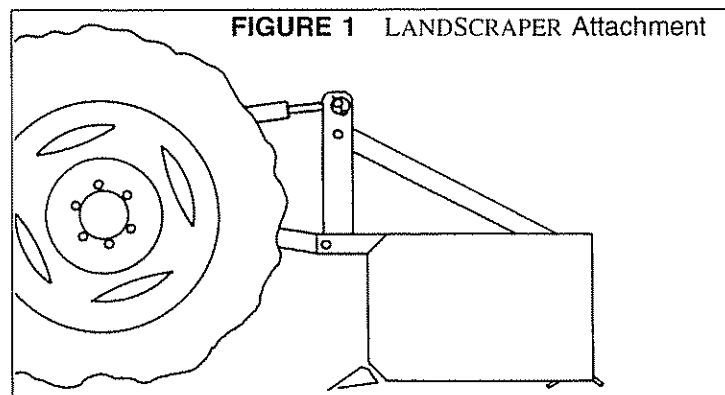

OPERATING

When operating the LANDSCRAPER, a reasonable degree of care should be taken to avoid large obstacles that would create undue loads on both the blades and linkage which could result in damage to your LANDSCRAPER. Use "Float Position" while operating the LANDSCRAPER. Do not use down pressure. Always operate at a slow speed.

BACKFILLING AND SNOW REMOVAL

The backfilling operation should be performed with the load in the center of the blade. Avoid concentrated loads on end of the blade. **DO NOT** ram into a load at any time, as this multiplies the force several times above normal and could result in damage to your blade. Perform all backfilling operations at slow speeds to prevent damage if blade hits an object.

Moving snow with the blade in backfill position is a very delicate operation and should be performed with extreme care and very slow speed. It is very easy to hit objects hidden in snow, or hit a snow bank that is too much material for your blade to move. This could damage your blade or mainframe. Caution in snow removal should be taken, as tractor could lose and regain traction causing surge in ground speed.

In all backfilling operations, the top link setting is very critical. Lengthen the top link so the blade is tilted down at the rear in order that the blade moves across the ground, not digging into it.

TRANSPORTING

CAUTION: When transporting the LANDSCRAPER on a road or highway, use the tractor warning sign, reflectors, and other devices for adequate warning to the operators of other vehicles. Check local government regulations.



Raise the Blade as high as possible for safe transporting while maintaining a safe clearance from the ground.

CAUTION: Do not transport at high speed at any time - especially when traveling over fields or rough roads. The bounce of the LANDSCRAPER on the tractor could cause loss of steering control which may cause damage to equipment or bodily injury.



NOTE: Attaching the LANDSCRAPER to the tractor increases the overall length and may increase the width of the working unit. Allow additional clearance for the implement to swing when turning.

DETACHING AND STORAGE

Lower the LANDSCRAPER to the ground, place the tractor transmission in "Park" (or Neutral), lock the brakes and shut off the engine. Disconnect the Top Link and Lower Lift Links from the LANDSCRAPER.

MAINTENANCE SECTION

MAINTENANCE

Replacing Scarifier Points

WARNING



Make certain that you wear gloves and safety glasses. Chips can fly off hammer or punch and cause eye damage, loss of eyesight, or other injury.

Place Scarifier assembly in vise securely. Using a hammer and drift or punch, drive the worn point off.

Hammer the new point on securely. Using a hammer and punch, indent the point edge into the recess in side of scarifier.

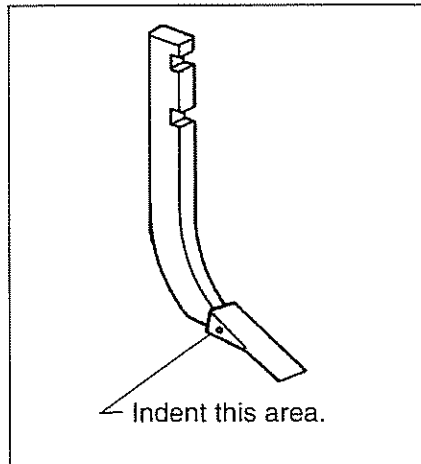





FIGURE 1 Replacing Scarifier Points

Torque Chart

Check hardware tightness regularly. Loose hardware is easily lost or bent, causes excessive wear on parts and increases the chance of breakage. Also, there is a potential hazard which could result in personal injury. Use the Torque Chart below when tightening hardware.

RECOMMENDED TORQUE IN FT-LBS (Nm) COARSE AND FINE THREADS			
2 (B)  5 (D)  8 (F) 			
Bolt Diameter	Plain Head	Three Dashes	Six Dashes
1/4	Not used	10 (14)	14 (19)
5/16	Not used	20 (27)	30 (41)
3/8	Not used	35 (47)	50 (68)
7/16	35 (47)	55 (75)	80 (108)
1/2	55 (75)	85 (115)	120 (163)
9/16	75 (102)	130 (176)	175 (237)
5/8	105 (142)	170 (230)	240 (325)
3/4	185 (251)	300 (407)	425 (576)
7/8	160 (217)	445 (603)	685 (929)
1	250 (339)	670 (908)	1030 (1396)
1-1/8	330 (447)	910 (1234)	1460 (1979)
1-1/4	480 (651)	1250 (1695)	2060 (2793)

MAINTENANCE

LUBRICATION INFORMATION (Figure 2)

Do not let excess grease collect on or around parts, particularly when operating in sandy areas. The illustrations below shows lubrication points. Unit should be lubricated after every 8 hours of operation.

***NOTE:**

Lubricate flail roller bearing until lubricant can be seen coming out between roller and bearing housing.

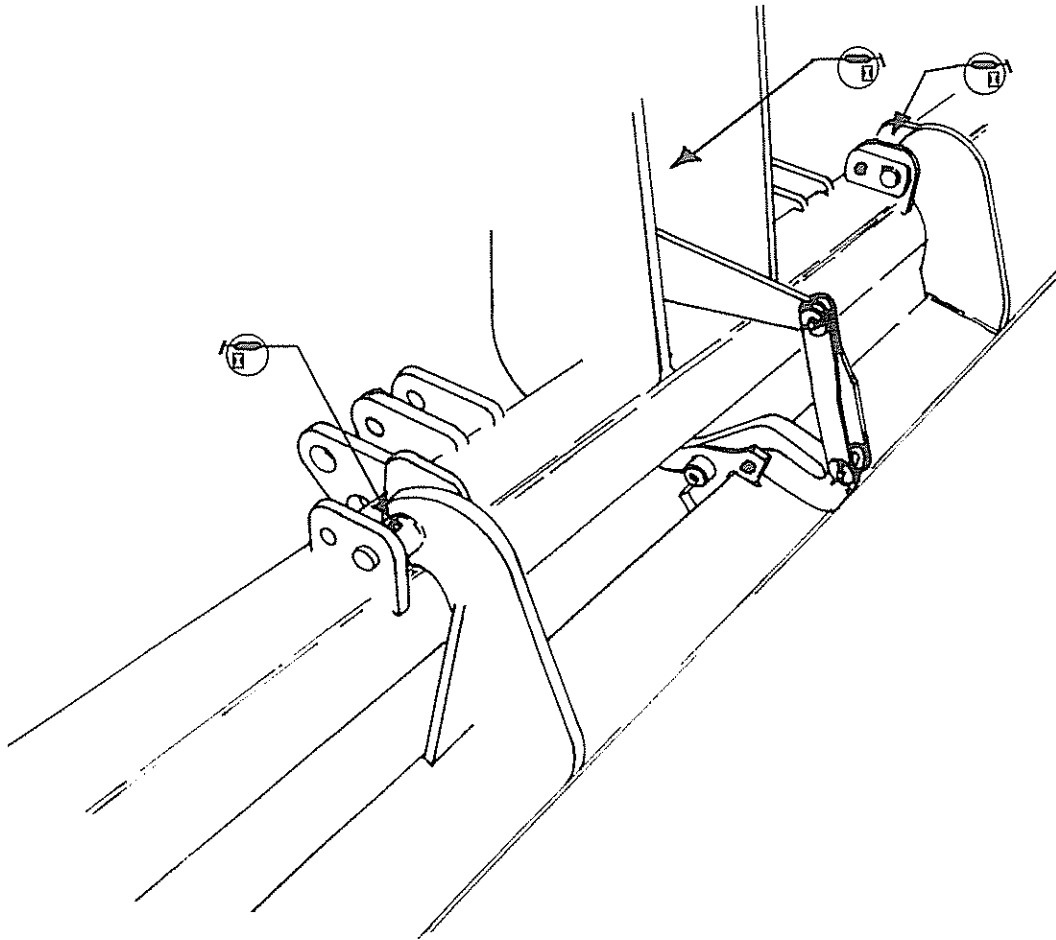

FIGURE 2

PARTS SECTION

PARTS ORDERING GUIDE

The following instructions are offered to help eliminate needless delay and error in processing purchase orders for the equipment in this section.

1. The Parts Section is prepared in logical sequence and grouping of parts that belong to the basic machine featured in this manual. Part Numbers and Descriptions are given to help locate the parts and quantities required.
2. The Purchase Order must include the name and address of the person or organization ordering the parts, who should be charged, and if possible, the serial number of the machine for which the parts are ordered.
3. The Purchase Order must clearly list the quantity of each part, the complete and correct part number, and the basic name of the part.
4. The Manufacturer reserves the right to substitute parts where applicable.
5. Some parts are unlisted items which are special production items not normally stocked and are subject to special handling. Request a quotation for such parts before sending a Purchase Order.
6. The Manufacturer reserves the right to change prices without prior notice.

NOTE: Please refer to The Safety Section in the front of this Manual for the proper Part Number when ordering Replacement Safety Decals.

NOTE: Please note that the appearance of some parts may vary from the art or photograph shown in the manual.



For maximum safety and to guarantee optimum product reliability, always use genuine Alamo Group Parts. The use of inferior replacement parts may cause premature or catastrophic failure which could result in serious injury or death. Direct any questions regarding parts to:



ALAMO
1502 E. Walnut
Seguin, Texas 78155
830-372-3551

PARTS TABLE OF CONTENTS

Basic Assembly	6-4
Blade Assembly	6-6
Hydraulic Cylinder Assembly	6-7

IMPORTANT

For your safety and to guarantee optimum product reliability, always use Genuine ALAMO INDUSTRIAL replacement parts. The use of inferior "will-fit" parts will void Warranty of your ALAMO INDUSTRIAL implement and may cause premature or catastrophic failure which can result in serious injury or death. If you have any questions concerning the repair parts you are using, contact ALAMO INDUSTRIAL, 1502 E. Walnut Seguin, TX 78155 (830) 372-3551.



BASIC ASSEMBLY

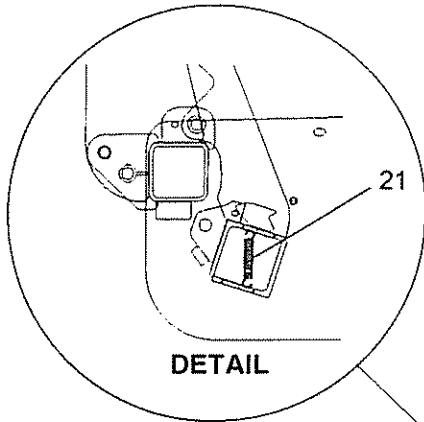

DETAIL

NOTE: Spring in Detail located inside shank Holder.

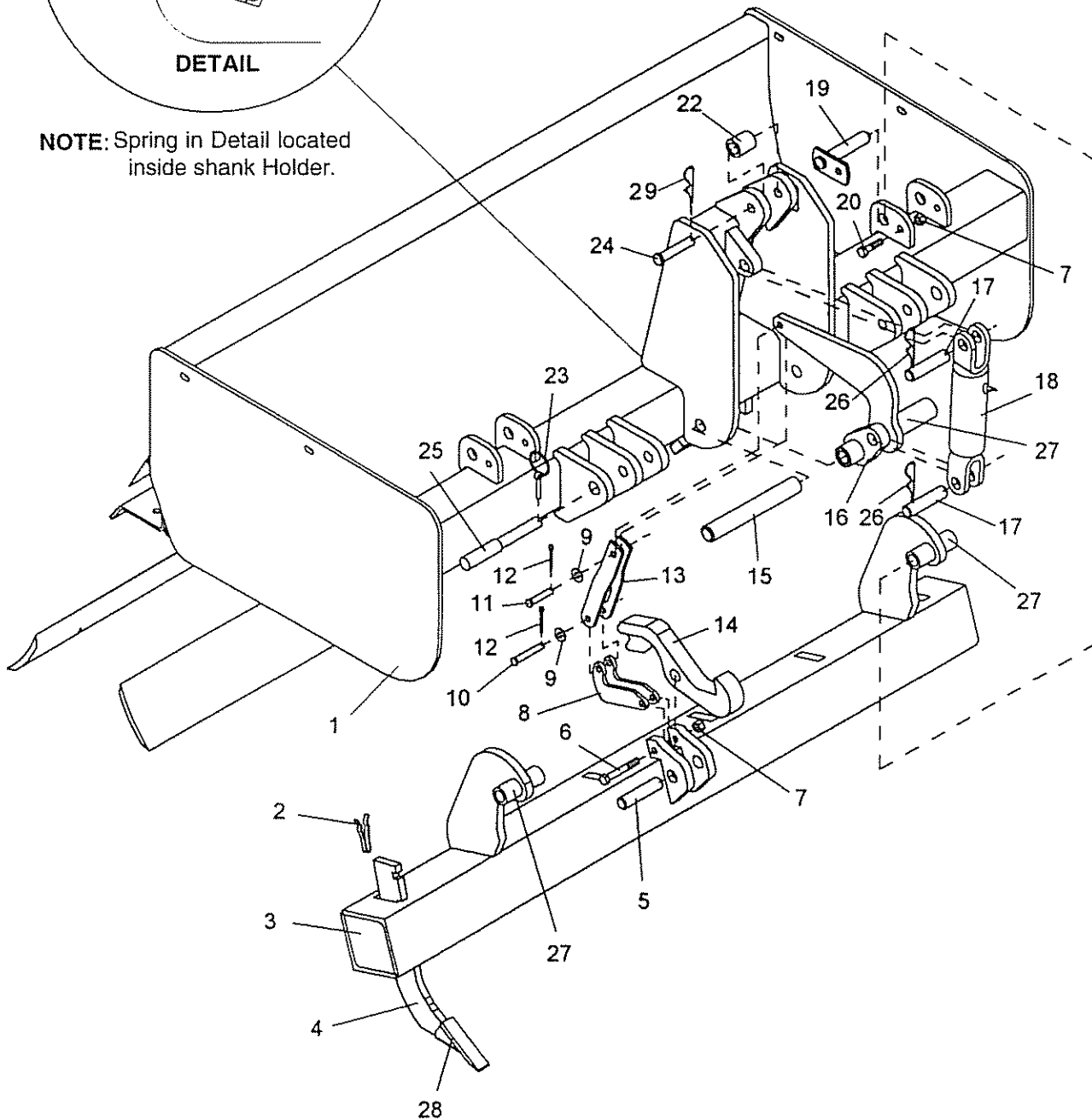

BASIC ASSEMBLY

ITEM	PART NO.	QTY				DESCRIPTION
		66"	72"	78"	84"	
1	00764611	1	-	-	-	Weldment - Mainframe
	00764466	-	1	-	-	Weldment - Mainframe
	00764621	-	-	1	-	Weldment - Mainframe
	00764631	-	-	-	1	Weldment - Mainframe
2	00763712	6	8	8	8	Shank Keeper
3	00764602	1	-	-	-	Shank Holder (66")
	00763680	-	1	1	1	Shank Holder (72", 78", 84")
4	00763713	6	8	8	8	Shank Scarifier
5	00764090	1	1	1	1	Pin
6	00752680	1	1	1	1	Bolt
7	00001800	5	5	5	5	Nut
8	00763651	1	1	1	1	Actuator Arm
9	00002700	6	6	6	6	Flatwasher
10	00763700	1	1	1	1	Pin
11	00763711	1	1	1	1	Pin
12	4405	2	2	2	2	Cotter Pin
13	00763656	1	1	1	1	Linkage Arm
14	00763637	1	1	1	1	Latch
15	00763694	1	1	1	1	Pin
16	00764458	1	1	1	1	Cylinder Pivot Weldment
17	8354	2	2	2	2	Pin
18	00764430	1	1	1	1	Cylinder
19	00764085	2	2	2	2	Pin
20	00748823	2	2	2	2	Bolt
21	00763691	1	1	1	1	Spring
22	441029	1	1	1	1	Bushing
23	2196	2	2	2	2	Lynch Pin
24	00764084	1	1	1	1	Pin
25	0781080000	2	2	2	2	Pin
26	37107B13	4	4	4	4	Clip (Hair)
27	00752670	3	3	3	3	Grease Fitting
28	01431080	6	8	8	8	Scarifier Point
29	2192	1	1	1	1	Hair Pin

BLADE ASSEMBLY

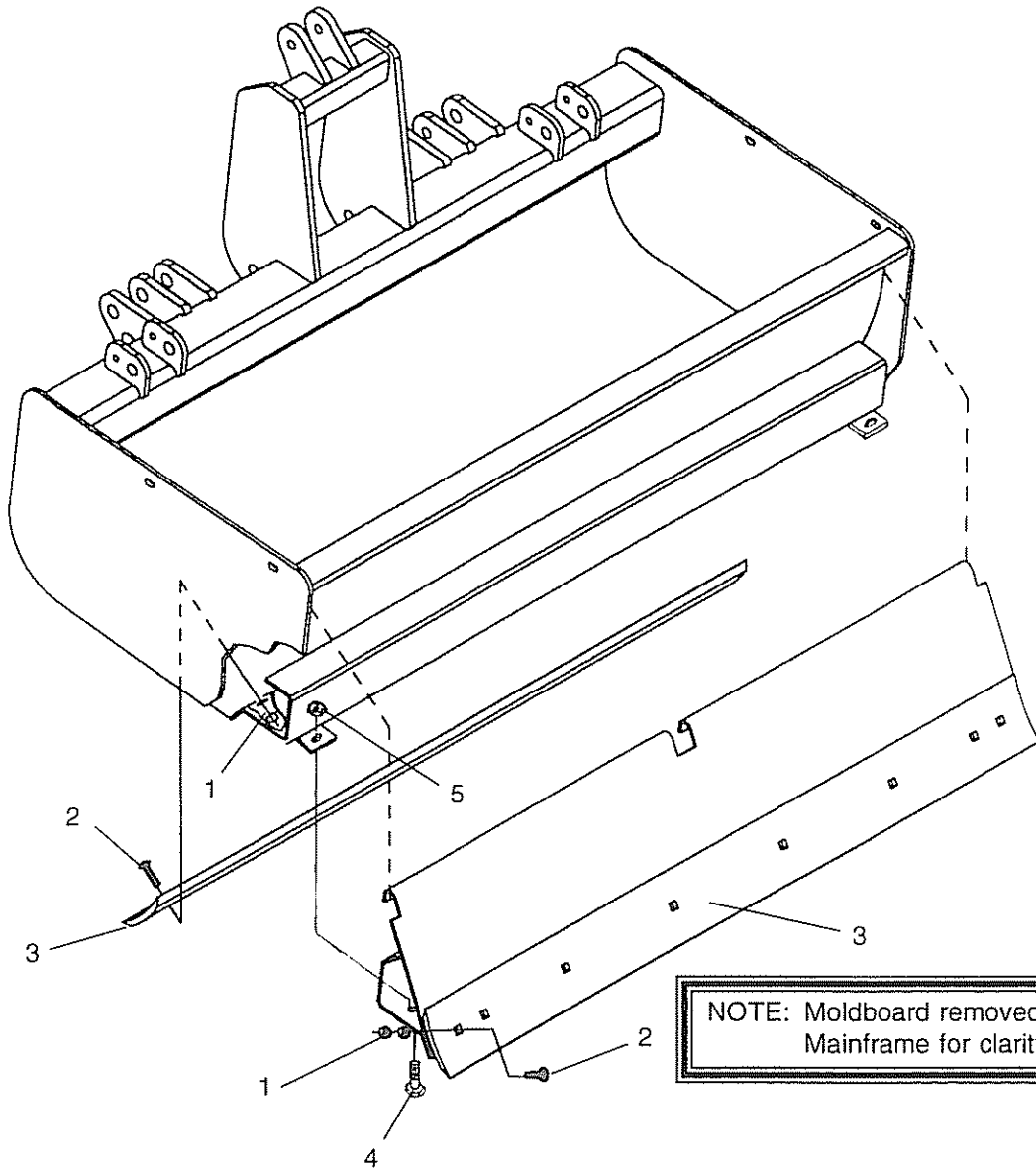

ITEM	PART NO.	QTY				DESCRIPTION
		66"	72"	78"	84"	
1	00695100	12	16	14	18	Locknut
2	2A3101116	12	16	14	18	Plowbolt
3	511042	2	-	-	-	Blade
	512042	-	2	-	-	Blade
	0516500004	-	-	2	-	Blade
	51703	-	-	-	2	Blade
4	02776600	2	2	2	2	Bolt
5	0001800	2	2	2	2	Nut

HYDRAULIC CYLINDER ASSEMBLY P/N 00764430

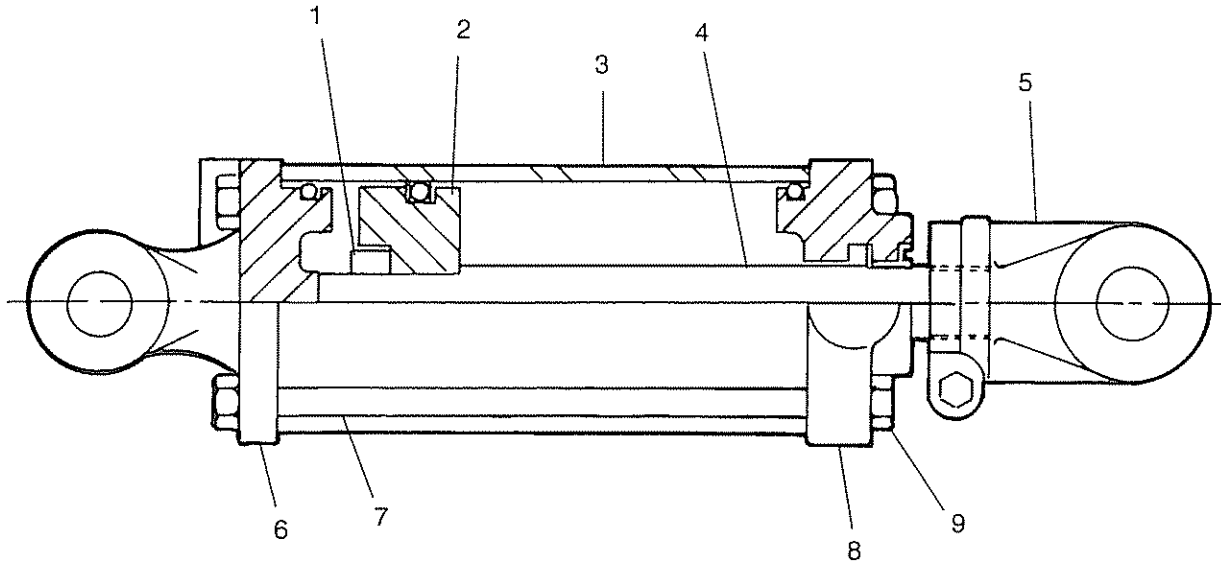

ITEM	PART NO.	QTY	DESCRIPTION
1	4675	1	Piston Nut
2	00764972	1	Piston
3	00764974	1	Tube
4	00764975	1	Piston Rod
5	00764976	1	Female Clevis
6	00764977	1	Cap
7	00764978	4	Tie Rod
8	00764979	1	Head
9	02031800	8	Nut
10	00764434	2	Hose (Not Shown)
11	00764980	1	Seal Kit (Not Shown)

ALAMO INDUSTRIAL

LIMITED WARRANTY

1. LIMITED WARRANTIES

- 1.01. Alamo Industrial warrants for one year from the purchase date to the original non-commercial, governmental, or municipal purchaser ("Purchaser") and warrants for six months to the original commercial or industrial purchaser ("Purchaser") that the goods purchased are free from defects in material or workmanship.
- 1.02. Manufacturer will replace for the Purchaser any part or parts found, upon examination at one of its factories, to be defective under normal use and service due to defects in material or workmanship.
- 1.03. This limited warranty does not apply to any part of the goods which has been subjected to improper or abnormal use, negligence, alteration, modification, or accident, damaged due to lack of maintenance or use of wrong fuel, oil, or lubricants, or which has served its normal life. This limited warranty does not apply to any part of any internal combustion engine, or expendable items such as blades, shields, guards, or pneumatic tires except as specifically found in your Operator's Manual.
- 1.04. Except as provided herein, no employee, agent, Dealer, or other person is authorized to give any warranties of any nature on behalf of Manufacturer.

2. REMEDIES AND PROCEDURES.

- 2.01. This limited warranty is not effective unless the Purchaser returns the Registration and Warranty Form to Manufacturer within 30 days of purchase.
- 2.02. Purchaser claims must be made in writing to the Authorized Dealer ("Dealer") from whom Purchaser purchased the goods or an approved Authorized Dealer ("Dealer") within 30 days after Purchaser learns of the facts on which the claim is based.
- 2.03. Purchaser is responsible for returning the goods in question to the Dealer.
- 2.04. If after examining the goods and/or parts in question, Manufacturer finds them to be defective under normal use and service due to defects in material or workmanship, Manufacturer will:
 - (a) Repair or replace the defective goods or part(s) or
 - (b) Reimburse Purchaser for the cost of the part(s) and reasonable labor charges (as determined by Manufacturer) if Purchaser paid for the repair and/or replacement prior to the final determination of applicability of the warranty by Manufacturer.The choice of remedy shall belong to Manufacturer.
- 2.05. Purchaser is responsible for any labor charges exceeding a reasonable amount as determined by Manufacturer and for returning the goods to the Dealer, whether or not the claim is approved. Purchaser is responsible for the transportation cost for the goods or part(s) from the Dealer to the designated factory.

3. LIMITATION OF LIABILITY.

- 3.01. MANUFACTURER DISCLAIMS ANY EXPRESS (EXCEPT AS SET FORTH HEREIN) AND IMPLIED WARRANTIES WITH RESPECT TO THE GOODS INCLUDING, BUT NOT LIMITED TO, MERCHANTABILITY AND FITNESS FOR A PARTICULAR PURPOSE.
- 3.02. MANUFACTURER MAKES NO WARRANTY AS TO THE DESIGN, CAPABILITY, CAPACITY, OR SUITABILITY FOR USE OF THE GOODS.
- 3.03. EXCEPT AS PROVIDED HEREIN, MANUFACTURER SHALL HAVE NO LIABILITY OR RESPONSIBILITY TO PURCHASER OR ANY OTHER PERSON OR ENTITY WITH RESPECT TO ANY LIABILITY, LOSS, OR DAMAGE CAUSED OR ALLEGED TO BE CAUSED DIRECTLY OR INDIRECTLY BY THE GOODS INCLUDING, BUT NOT LIMITED TO, ANY INDIRECT, SPECIAL, CONSEQUENTIAL, OR INCIDENTAL DAMAGES RESULTING FROM THE USE OR OPERATION OF THE GOODS OR ANY BREACH OF THIS WARRANTY. NOTWITHSTANDING THE ABOVE LIMITATIONS AND WARRANTIES, MANUFACTURER'S LIABILITY HEREUNDER FOR DAMAGES INCURRED BY PURCHASER OR OTHERS SHALL NOT EXCEED THE PRICE OF THE GOODS.
- 3.04. NO ACTION ARISING OUT OF ANY CLAIMED BREACH OF THIS WARRANTY OR TRANSACTIONS UNDER THIS WARRANTY MAY BE BROUGHT MORE THAN TWO (2) YEARS AFTER THE CAUSE OF ACTION HAS OCCURRED.

4. MISCELLANEOUS.

- 4.01. Proper Venue for any lawsuits arising from or related to this limited warranty shall be only in Guadalupe County, Texas.
- 4.02. Manufacturer may waive compliance with any of the terms of this limited warranty, but no waiver of any terms shall be deemed to be a waiver of any other term.
- 4.03. If any provision of this limited warranty shall violate any applicable law and is held to be unenforceable, then the invalidity of such provision shall not invalidate any other provisions herein.
- 4.04. Applicable law may provide rights and benefits to purchaser in addition to those provided herein.

KEEP FOR YOUR RECORDS

ATTENTION: Purchaser should fill in the blanks below for his reference when buying repair parts and/or for proper machine identification when applying for warranty.

Alamo Industrial Implement Model _____ Serial Number _____

Date Purchased _____ Dealer _____

ATTENTION:
READ YOUR OPERATOR'S MANUAL

ALAMO INDUSTRIAL

An Alamo Group Company
Post Office Drawer 549
Seguin, Texas 78156
830-379-1480





TO THE OWNER/OPERATOR/DEALER

To keep your implement running efficiently and safely, read your manual thoroughly and follow these directions and the Safety Messages in this Manual. The Table of Contents clearly identifies each section where you can easily find the information you need.

The OCCUPATIONAL SAFETY AND HEALTH ACT (1928.51 Subpart C) makes these minimum safety requirements of tractor operators:

REQUIRED OF THE OWNER:

1. Provide a Roll-Over-Protective Structure that meets the requirements of this Standard; and
2. Provide Seatbelts that meet the requirements of this paragraph of this Standard and SAE J4C; and
3. Ensure that each employee uses such Seatbelt while the tractor is moving; and
4. Ensure that each employee tightens the Seatbelt sufficiently to confine the employee to the protected area provided by the ROPS.

REQUIRED OF THE OPERATOR

1. Securely fasten seatbelt if the tractor has a ROPS.
2. Where possible, avoid operating the tractor near ditches, embankments, and holes.
3. Reduce speed when turning, crossing slopes, and on rough, slick, or muddy surfaces.
4. Stay off slopes too steep for safe operation.
5. Watch where you are going - especially at row ends, on roads, and around trees.
6. Do not permit others to ride.
7. Operate the tractor smoothly - no jerky turns, starts, or stops.
8. Hitch only to the drawbar and hitch points recommended by the tractor manufacturer.
9. When the tractor is stopped, set brakes securely and use park lock, if available.

Keep children away from danger all day, every day...

Equip tractors with rollover protection (ROPS) and keep all machinery guards in place...

Please work, drive, play and live each day with care and concern for your safety and that of your family and fellow citizens.

