

MODEL D9
Serial No. 9533 and up

MODEL D95
Serial No. 601 and up

INSTRUCTIONS & PARTS LIST



SAFE • VERSATILE • DEPENDABLE

for the

AIRPORT • CAMP • CEMETERY • ESTATE • FARM • GOLF COURSE

HIGHWAY • HOME • PARK • PLAYGROUND • SCHOOL • TOWN • ZOO

OWNER'S RESPONSIBILITIES:

- 1. Know the controls, and how to stop quickly — READ THE TRACTOR OWNER'S MANUAL.**
- 2. Do not allow children to operate the tractor and mower. Do not allow adults to operate the tractor and mower without proper instructions.**
- 3. Do not carry passengers. Keep children and pets a safe distance away.**
- 4. Clear work area of objects which might be picked up and thrown.**
- 5. Disengage power to mower, and shift into neutral before attempting to start engine.**
- 6. Disengage power to mower, and stop engine before leaving operator position.**
- 7. Do not attempt to clean discharge, remove obstacles or otherwise clean, adjust belts or repair mower before stopping tractor engine. Never place hands or feet in or near the rotating knives or belts when engine is running.**
- 8. Disengage power to mower when transporting or not in use.**
- 9. Take additional precautions when leaving tractor and mower unattended, such as lowering mower, setting parking brake, stopping engine and removing key.**
- 10. Do not start suddenly, especially when going up a slope. It is suggested, depending on the amount of slope, that slopes be mowed up and down rather than across the face.**
- 11. Reduce travel speed for slopes and sharp turns to reduce the possibility of tipping or loss of control.**
- 12. Stay alert for holes in terrain and other hidden hazards.**
- 13. Never allow anyone near vehicle while in operation, and watch out for traffic when crossing or near roadways.**
- 14. Handle fuel with care — it is highly flammable.**
 - A. Use approved fuel container.**
 - B. Never remove cap or add fuel to a running or hot engine. Never fill fuel tank indoors. Wipe up spilled fuel.**
 - C. Open doors if engine is run in garage — exhaust fumes are dangerous. Do not run engine indoors.**
 - D. Never smoke while refueling engine.**
- 15. Keep tractor and mower in good operating condition and keep safety devices in place.**
- 16. Keep all nuts, bolts, and screws tight to be sure equipment is in safe working condition.**
- 17. Never store tractor with fuel in tank inside a building where fumes may reach an open flame or spark, and allow engine to cool before storing in any enclosure.**
- 18. To reduce fire hazard, keep engine free of grass, leaves or excessive grease.**
- 19. Tractor and mower should be stopped and inspected for damage after striking foreign object and damage should be repaired before restarting and operating the equipment.**
- 20. Do not change engine governor settings or overspeed engine.**

INSTALLATION OF C5 & H386 KNIVES:

(For knives other than C5 & H386, see instructions packed with knives.) Tip the mower back, if possible, for easier assembly. With one hand hold two knives back to back so the tips are apart and the holes are in line, insert between a pair of ears on the shaft, and with the other hand insert a headed pin. Proceed along the shaft in like manner. Then take a few of the special MOTT cotters in one hand, insert in the pin hole, hold the cotter head edgewise to the ear, hook the hole end of the special tool (or a knife) over the extended prong and bend out about 45°. Repeat on the other 3 rows of ears.

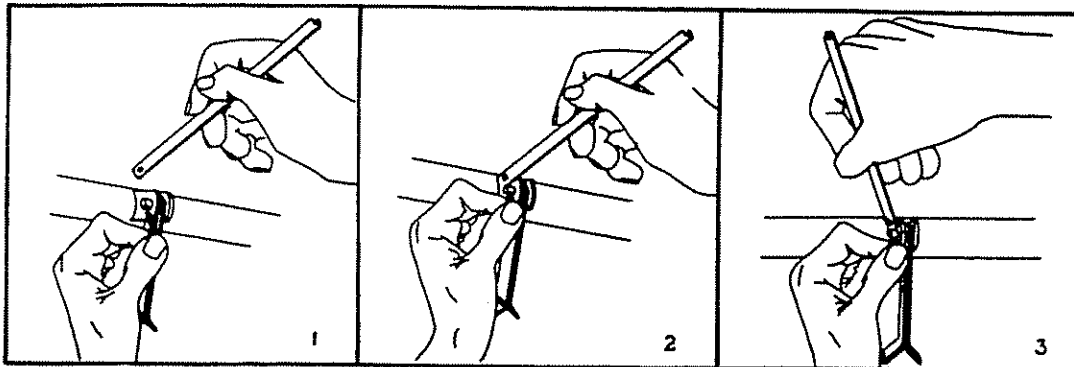

The spring steel knives are tough and will bend quite far before they break, and can be straightened several times. They can be sharpened by filing or grinding. If by grinding, keep cool to maintain hardness and avoid early dulling. When sharpening, remove metal mostly at the end of the tip and not much next to the shank. This will make the cutting portion tapered rather than long and weak after several sharpenings. If the MOTT X409 Electric Grinder is used, the knives can be sharpened without removing from the machine (except knives wider than 1-1/4"). Sharp knives require less power than dull knives. Sharp knives do a better job than dull knives. Replace broken or missing knives promptly! Keep your MOTT Hammer Knife Mower running smoothly.

VIBRATION WARNING:

Warranty on MOTT Hammer Knife Mowers does not apply to failures resulting from VIBRATION or ABUSE. Very little vibration will be noticed if the mower is operating properly. At the first indication of unusual vibration, the mower should be stopped and not operated again until the trouble is corrected. VIBRATION, if allowed to continue unchecked, can destroy the entire mower in a very short time.

To remove cotters with special tool, follow steps shown here.

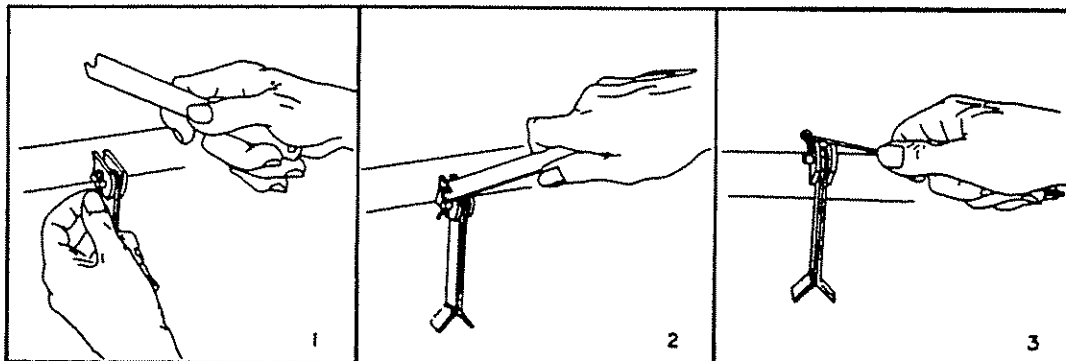

WARRANTY: See Warranty Card enclosed.

MODELS D9 AND D95

EACH MOWER IS SHIPPED AS 2 BUNDLES AND 2 CARTONS.

1. One bundle contains the mower and push bar assembly.
2. One bundle contains the tractor belt and pulley guard.
3. One carton contains the belt adjusting lever and drawbar bracket assembly, idler bracket assembly, jockey rod anchor, jockey rod, lift bracket, lift shaft and lift bracket bushing assembly, lift chain assembly, drive pulley, cuttershaft pulley, drive belt, and bolt bag.
4. One carton contains the knives as ordered.

KNIVES:

For the proper installation of knives see Page 2.

CUTTER UNIT:

Remove the protective sleeve from the drive end of the cuttershaft and remove any paint that is in the bore of the cuttershaft pulley. Assemble the pulley on the shaft so that the long hub is toward the housing. Insert the pulley key and secure with the heavy washer, lock washer and capscrew that were in the shaft.

Turn the cutter unit right side up and with the 1/2 x 1-1/2 carriage bolts (heads inside housing) secure the left push bar to the left end of the housing. Using the 1/2 x 1-3/4 carriage bolts (heads on the right), secure the right push bar to the bracket on top of the housing. Be sure to use the 1/2" lock washers under the nuts and tighten securely.

PREPARING THE TRACTOR: Plates 1 and 2.

The Farmall Cub tractor must be equipped with power take-off, adjustable drawbar, and touch control.

Plate 1: Install the 000502 drive pulley (splined) on the power take-off shaft, positioning it with the 3/16 x 2-1/2 cotter pin and securing with the 3/8 NF x 2 capscrew and nut through the pulley hub. Tighten securely.

Bolt the drawbar bracket and idler pulley bracket in the positions shown, using the 5/8 carriage bolts, lock washers, and nuts. Place the mower unit under the tractor and connect the push bars to the lower end of the belt adjusting lever with the 3/4" pin, and secure with a quick cotter.

Plate 2: Install the lift arm assembly to the touch control. This assembly mounts on the forward mounting pad on the right side of the tractor with one capscrew and lock washer. This capscrew must be put in and tightened using a 12-point box wrench.

Hook one end of the jockey rod through the ear on the top of the right end of the cutter unit housing. Hook the jockey rod anchor to the other end of the jockey rod and bolt the anchor to the rear mounting pad as shown, using two 5/8" capscrews and lock washers.

Connect the ends of the lift chain to the two lift clips on the top of the cutter unit housing. Be sure to spread the cotter pins. Place the lift chain in the notch of the lift arm, selecting the proper link so that the mower will lift evenly.

Plates 1 & 2: Put the belt (000501) on the drive pulley and pass it around the underside of the idlers and forward to the cuttershaft pulley. The section of the belt which passes under the left idler goes to the topside of the cuttershaft pulley. If the belt is not properly installed, the cutter will run backwards, throwing cuttings up - and all over the tractor. To tighten the belt, move the belt tightener lever to the rear, and then tighten the three clamping bolts to lock it in position. When the belt is properly tightened either vertical section can be moved about 1/2" from straight without undue effort. The belt should never be adjusted in the up position - ALWAYS IN THE DOWN POSITION - as the belt tightens slightly as the unit is lowered and the additional tension might break the cords in the belt. Install the guard, using the capscrew and lock washer in tapped hole on top of transmission case shown in Plate 1.

OPERATION:

In addition to the following operation instructions, it is suggested that the "owner's responsibilities" on Page 1 be read and followed.

Do not try to start the tractor in the cut - it's like trying to drive a car in high gear going up a steep hill. Start the tractor in the clear, allowing the cuttershaft to get up to full speed before cutting. This speed must be maintained while mowing so that the cut material will discharge properly. If the cuttings are not discharged properly they may wind up around the cuttershaft and friction from the cuttings against the housing end plate may cause the bearing to overheat and be damaged. To avoid doing this, regulate the tractor travel speed to the mowing conditions to maintain cuttershaft speed. If the mower starts making a racket, perhaps wire is wound up in the knives or an end knife is bent and hitting the housing sidesheet. Use a pair of wire cutters to help remove the wire. Use a wrench, pliers, or MOTT #700413 Knife Straightener tools to reshape bent knives. Even though the knives may be bent or broken, there is no need to straighten or replace them as long as the job they are doing is satisfactory, and the mower is NOT VIBRATING. They have to be in pretty bad shape before any difference in the type of job they do on weeds is noticeable. To do a fine job of lawn mowing, of course, the knives should be sharp. Dull knives take more power than sharp knives. Therefore, the mower with sharp knives will operate more satisfactorily in tougher conditions than will a mower with dull knives.

The lawn mowing performance of the mower can be improved by making several alterations. However, these alterations are recommended only when the mower is to be used exclusively on clean, well kept lawn areas where high growths and trash will not be encountered. They are:

- (a) The cuttershaft speed can be increased. To do this, the 6-1/2" cuttershaft pulley is replaced with a 5" pulley. When the smaller pulley is installed, the V-belt tension will have to be readjusted. If the belt is a little long, it may not tighten within the limits of adjustment provided. Then the belt adjusting lever should be moved from the middle to the forward of the three bolts in the drawbar bracket. In this position, the clamping action will be less but there will still be plenty to hold the adjustment under the conditions to be encountered. NOTE: THIS SPEED-UP IS PERMISSIBLE ONLY FOR OPERATION ON CLEAN, WELL KEPT LAWN AREAS. However, experience has shown that operation of mowers equipped with speed-up pulleys is not restricted to the conditions stated. Therefore, while speed-up pulleys

will be available from the factory, their use will be AT THE OWNER'S RISK - NO WARRANTY WILL APPLY.

- (b) The cuttershaft rotation may be reversed. Do this by installing the belt over the tractor drive pulley, under the idler pulleys, and around the cutter pulley. The section of the belt that passes under the left idler pulley will go to the underside of the mower pulley. WHEN THE CUTTERSHAFT ROTATION IS REVERSED, THE FRONT DEFLECTOR OR THE FRONT HOOD OF THE LEAF ATTACHMENT MUST BE INSTALLED. This will prevent clippings from being thrown all over the tractor and will increase the safety of operation.
- (c) Both (a) and (b) can be used.

ADJUSTING HEIGHT OF CUT:

Adjustment is made by removing the rear bolts from the roller brackets, moving the roller to the desired one of four available positions, and then replacing the bolts. By using the tractor lift to adjust the height of the cutter unit while the roller remains on the ground, much effort can be avoided when making the adjustment in the field. Lawns will probably be cut with the roller in the lowest or next to lowest cut position. When cutting in rough or trashy areas, it is suggested that the knives will last longer if the roller is adjusted to the highest or next to highest position.

LUBRICATION:

Every 8 hours use a pressure grease gun to lubricate the cuttershaft bearings, roller ball bearings, and lift shaft bearing. Recommended greases are Atlantic Richfield Arco Litholene Multi-purpose, Standard Oil Co. Amolith #2, Shell Alvania #2, Texaco Multifak #2, Mobil Oil Corp. Mobilux #2. All mowers are equipped with lubricaps which snap over the grease fittings. Their purpose is to exclude dirt. (Even when a grease fitting is wiped before greasing, there can be a small amount of dirt remaining in the fitting hole. This dirt, which gets pushed into the bearing with the new grease, will shorten bearing life.) After removing the lubricaps, wipe any dirt off the fitting so as to not contaminate the nozzle of the grease gun. Be sure the lubricap is clean inside and then replace immediately after greasing. Wipe off all surplus grease.

OPTIONAL EQUIPMENT:

D9 700384	D95 700385	FRONT DEFLECTOR SHIELD, FOR REVERSING DIRECTION OF CUTTERSHAFT TO IMPROVE LAWN MOWING PERFORMANCE.
000103	000103	5" O.D. CUTTERSHAFT PULLEY, TO INCREASE CUTTERSHAFT SPEED; TO BE USED ON FINE LAWNS ONLY.
700822	700824	RING KNIFE CONVERSION PACKAGE, TO IMPROVE KNIFE LIFE IN ROUGH AREAS.
700034	700472	LEAF ATTACHMENT, FOR LEAF MULCHING.
700409	700409	KNIFE GRINDER, FOR SHARPENING KNIVES UP TO 1-1/4" WIDE WHILE STILL ON MOWER.
700413	700413	KNIFE STRAIGHTENER (SLOTTED BAR SET)
102604	102605	RUBBER COVERED ROLLER
700194	700195	REAR TRASH DEFLECTOR PACKAGE

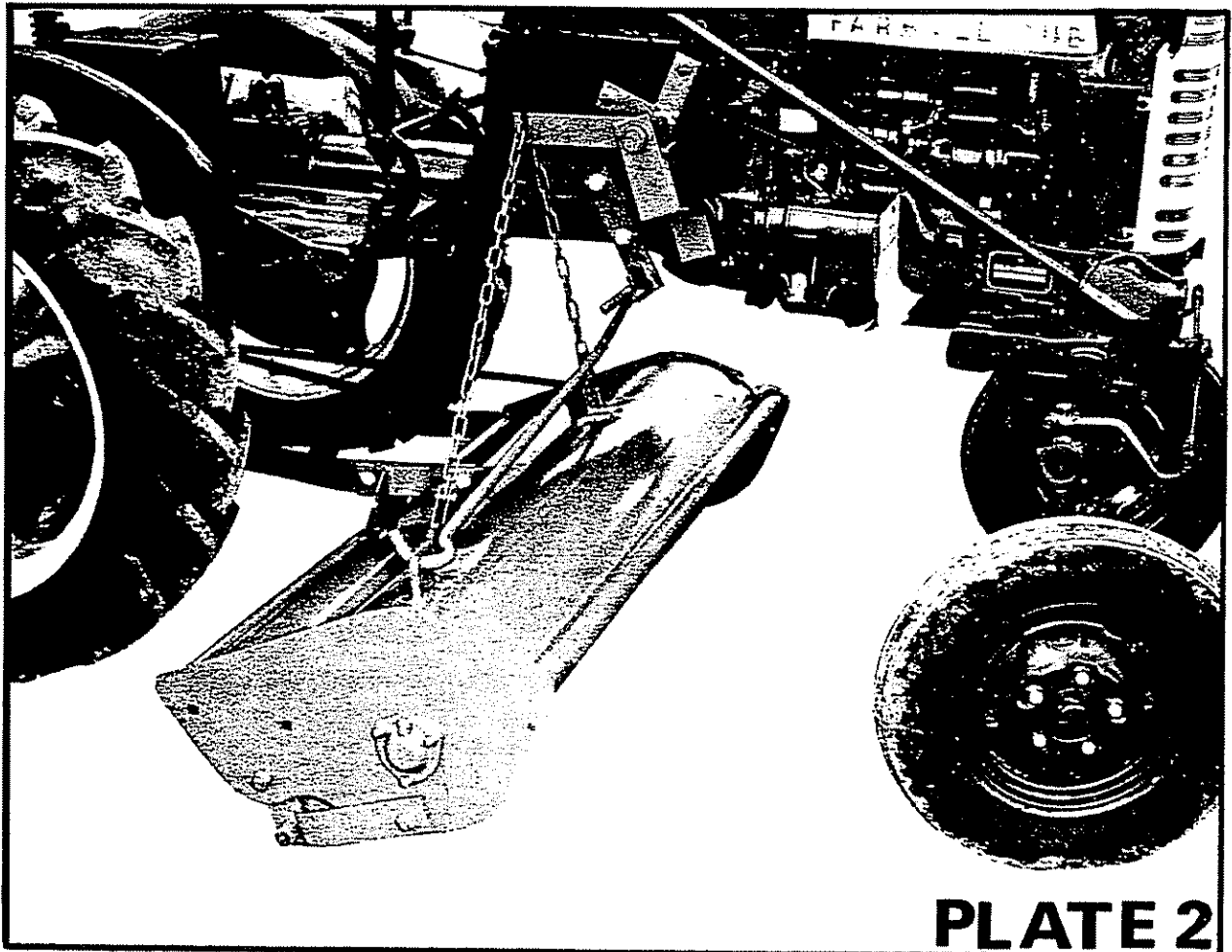
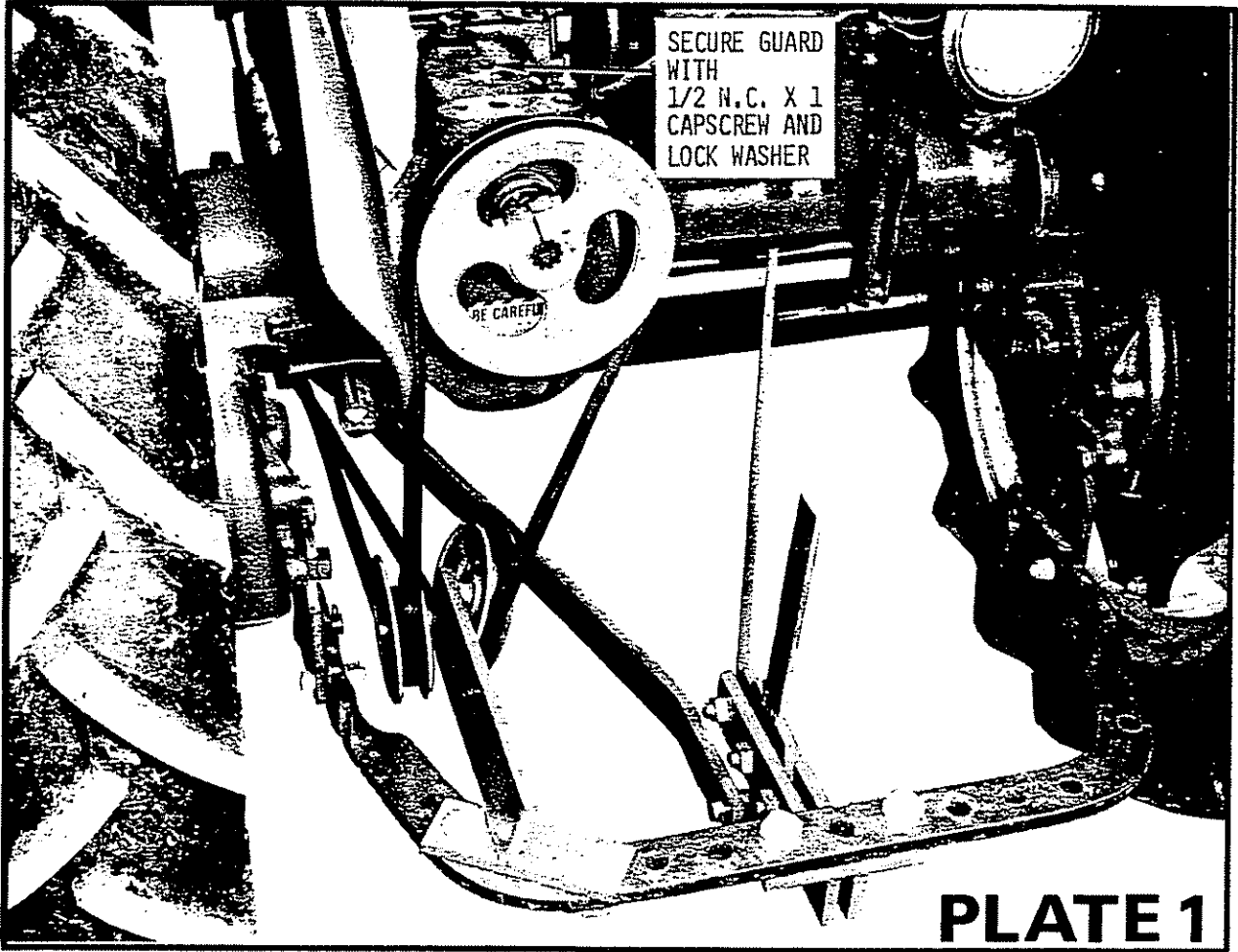

PARTS LIST - PLATE 3

REF. NO.	MODEL D9		MODEL D95		DESCRIPTION
	PART NO.	REQD.	PART NO.	REQD.	
1	000555	2	000555	2	1/2 N.F. X 1-1/2 HEX HEAD CAPSCREW
2	000520	2	000520	2	1/2 LOCK WASHER
3	101780	2	101780	2	BEARING CLAMP WASHER
4	101703	1	101703	1	CUTTERSHAFT PULLEY, 6-1/2" O.D.
5	000103*	1	000103*	1	HI-SPEED CUTTERSHAFT PULLEY (5" O.D.), USED OPTIONALLY UNDER CERTAIN CONDITIONS TO REPLACE 101703 PULLEY
	(* PLEASE SEE NOTE BELOW)				
6	102651	2	102651	2	PULLEY SHIM
7	102792	2	102792	2	CUTTERSHAFT BEARING
8	700737	2	700737	2	BEARING CAGE W/ZERK
9	101735	2	101735	2	BEARING SHIELD WASHER
10	101782	1	101782	1	1/4" SQUARE KEY
11	102985	1	102987	1	CUTTERSHAFT
12	000032	60	000032	76	5/16 N.F. X 7/8 HEX CAPSCREW (HEAT TREATED)
13	101992	120	101992	152	RING CLIP
14	101993	120	101993	152	H293 RING KNIFE
15	101991	60	101991	76	RING
16	000210	60	000210	76	5/16 N.F. HEX LOCK NUT
-	700822	1	700824	1	H293 RING KNIFE PACKAGE (COMBINATION OF ITEMS 12 THRU 16)
17	101034	60	101034	76	HARDENED KNIFE PIN
18	102086	120	102086	152	H386 1-1/4 X 5" KNIFE
19	000026	60	000026	76	1/8 X 3/4" COTTER PIN
-	700812	1	700814	1	H386 KNIFE PACKAGE (COMBINATION OF ITEMS 17 THRU 19)
20	101033	60	101033	76	KNIFE PIN
21	101031	60	101031	76	C5 3/4 X 5 KNIFE
-	700504	1	700505	1	C5 KNIFE PACKAGE (COMBINATION OF ITEMS 19 THRU 21)
22	101776	1	101776	1	JOCKEY ROD ANCHOR
23	101777	1	101777	1	JOCKEY ROD
24	100125	2	100125	2	ROLLER NUT GUARD
25	100126	2	100126	2	ROLLER NUT
26	101933	2	101933	2	LOCK WASHER
27	101769	2	101769	2	ROLLER PIVOT BUSHING
28	102148	1	102148	1	L.H. ROLLER BRACKET
29	102002	2	102002	2	ROLLER BEARING
30	101998	1	102093	1	HOUSING & BRACKET ASSEMBLY
31	701616	1	701617	1	TIE ROD WITH ZERK FITTING M.A.
32	102172	1	102174	1	ROLLER SHELL W.A.
-	701614	1	701615	1	4' ROLLER ASSEMBLY, LESS BRACKETS AND ROLLER NUT GDS. (COMBINATION OF ITEMS 25, 26, 29, 31 AND 32)
33	102146	1	102146	1	R.H. ROLLER BRACKET
34	000511	3	000511	3	5/8 N.C. X 1-1/2 HEX CAPSCREW
35	101974	1	101974	1	LIFT SHAFT ASSEMBLY
36	101973	1	101973	1	LIFT BRACKET BUSHING W/ZERK
37	101967	1	101967	1	LIFT BRACKET COMPLETE
38	101770	4	101770	4	LIFT LINK
39	101773	4	101773	4	LIFT LINK PIN
40	101740	1	101740	1	PUSH BAR ASSEMBLY
41	000548	2	000548	2	"V" GROOVE IDLER PULLEY
42	101995	1	101995	1	IDLER BRACKET ASSEMBLY
43	101779	1	101779	1	HITCH PIN
44	101728	1	101728	1	BELT ADJUSTING LEVER
45	101731	1	101731	1	DRAWBAR BRACKET ASSEMBLY
46	000501	1	000501	1	"V" BELT
47	101702	1	101702	1	DRIVE PULLEY - 8"
48	000521	3	000521	3	5/8 LOCK WASHER
49	102549	4	102549	4	QUICK COTTER
50	101999	1	101999	1	LIFT CHAIN
51	102618	1	102618	1	PULLEY GUARD
52	102621	1	102621	1	GUARD BRACKET
53	000474	2	000474	2	5/16 N.F. X 7/8 HEX HEAD CAPSCREW
54	000018	2	000018	2	5/16 LOCK WASHER
55	000013	2	000013	2	5/16 HEX NUT
-	700520	1	700520	1	TRACTOR BELT GUARD PACKAGE

* NOTE: FACTORY APPROVAL ON SPEED-UP PULLEY (000103 LISTED ABOVE) IS WITHDRAWN. EXPERIENCE SHOWS THAT OPERATION OF MOWERS EQUIPPED WITH SPEED-UP PULLEYS IS NOT BEING RESTRICTED TO CONDITIONS AS PER REQUIREMENTS LISTED IN THE INSTRUCTION MANUALS.

THEREFORE, WHILE THE SPEED-UP PULLEYS WILL STILL BE AVAILABLE FROM THE FACTORY, THEIR USE ON THE MOWERS WILL BE AT THE OWNER'S RISK - NO WARRANTY WILL APPLY.

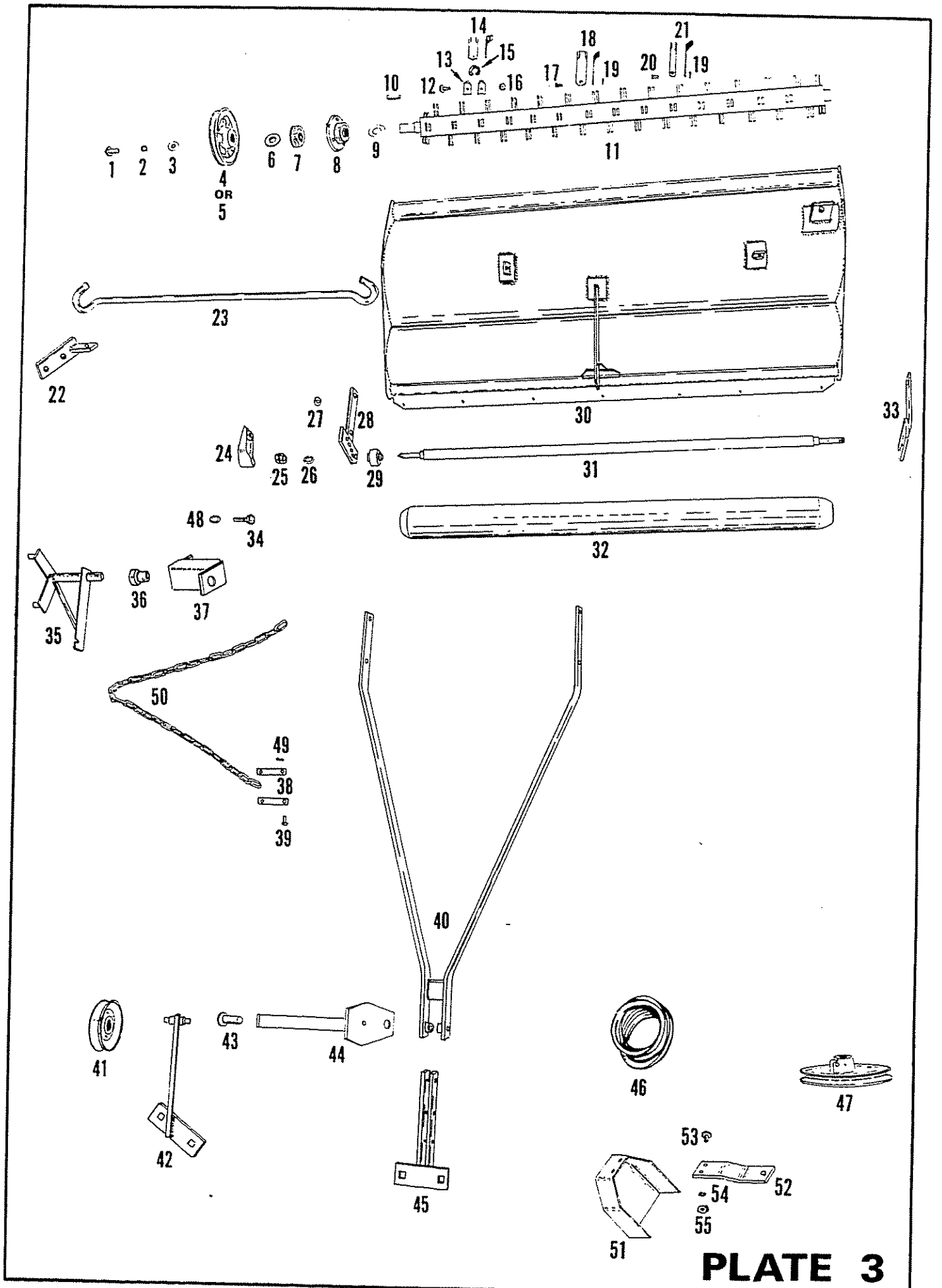

PLATE 3

